



Connells

Stafford Road
Oxley Wolverhampton

Stafford Road Oxley Wolverhampton WV10 6NN

for sale offers in the region of
£275,000



Property Description

Samuel Thorneywork from the Award Winning Connells Wolverhampton branch are delighted to bring to the market this deceptively spacious four bedroom semi-detached family home set over three floors and boasts no onward chain.

Internally the property comprises of an inviting entrance hallway leading to two reception rooms, both used as a dining room and lounge. The ground floor also comprises of having a well appointed kitchen and adjoining utility room and ground floor wc. On the first floor you will find three bedrooms and a family bathroom. On the second floor there is an additional bedroom.

Outside to the front there is off road parking for several vehicles while the rear benefits from having a well presented rear garden.

Ideally suitable for first time buyers, investors and families. Viewings are highly recommended to appreciate the accommodation on offer.

Location And Area

Situated on the main A449 Stafford Road which offers fantastic commuting links the M54 and M6 motorways and for commuters into Wolverhampton City centre. The i54 commercial development is also close by along with local shopping at Three Tuns. There are various shops, schooling, doctors and dentists can also be found nearby.

Approach

Set back from the road side behind off road parking for several vehicles with access to the main accommodation and side gate.

Entrance Hallway

Double glazed window to front, ceiling light point, radiator, storage cupboard, doors to lounge, dining room and stairs to first floor.

Dining Room

17' 8" max x 11' 9" max (5.38m max x 3.58m max)

Double glazed window to front, radiator, ceiling light point, gas fire place.

Lounge

11' 10" max x 10' max (3.61m max x 3.05m max)

Double glazed window to rear, gas fire place, ceiling light point, radiator, door to kitchen and hallway.

Kitchen

9' 5" x 6' 6" (2.87m x 1.98m)

Matching wall and base units with stainless steel sink and drainer with mixer tap, gas cooker point ceiling light point, double glazed window to side, doors to utility and lounge.



Utility

Wall mounted boiler, double glazed window to side, plumbing point for washing machine, radiator, doors to ground floor wc, rear garden and kitchen.

Ground Floor Wc

Low flush wc, tiled walls, ceiling light point, radiator, double glazed window to rear

First Floor Landing

Double glazed window to front, storage cupboard, two ceiling light points, doors to three bedrooms, stairs to second floor.

Bedroom One

14' 9" max x 11' 6" max (4.50m max x 3.51m max)

Double glazed window to front, radiator, ceiling light point.

Bedroom Two

11' 9" max x 9' 10" max (3.58m max x 3.00m max)

Double glazed window to rear, radiator, ceiling light point.

Bedroom Three

9' 6" x 9' 1" (2.90m x 2.77m)

Double glazed window to rear, radiator, ceiling light point.

Bathroom

Panelled bath with shower over, low flush wc, wash hand basin, extractor fan, ceiling light point, radiator, double glazed window to side.

Second Floor Landing

Ceiling light point, door to fourth bedroom.

Bedroom Four

13' 10" max x 9' 4" max (4.22m max x 2.84m max)

Double glazed window to rear, radiator, ceiling light point, eves storage space.

Outside Rear

Paved patio with lawn, central path, side gate to front access, timber fencing.







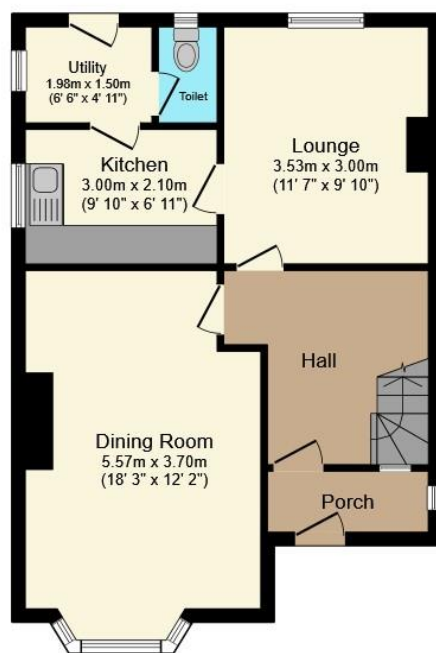

Ground Floor

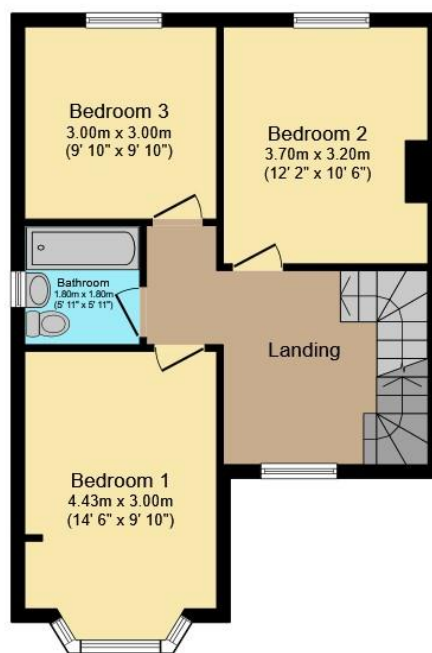

First Floor



Second Floor

Total floor area 118.1 m² (1,271 sq.ft.) approx

This floor plan is for illustrative purposes only. It is not drawn to scale. Any measurements, floor areas (including any total floor area), openings and orientation are approximate. No details are guaranteed, they cannot be relied upon for any purpose and they do not form part of any agreement. No liability is taken for any error, omission or misstatement. A party must rely upon its own inspection(s). Powered by www.propertybox.io



To view this property please contact Connells on

T 01902 710 170
E wolverhampton@connells.co.uk

81-83 Darlington Street
WOLVERHAMPTON WV1 4EX

EPC Rating: C Council Tax
Band: B

Tenure: Freehold

view this property online connells.co.uk/Property/WVH333983



1. MONEY LAUNDERING REGULATIONS Intending purchasers will be asked to produce identification documentation at a later stage and we would ask for your co-operation in order that there will be no delay in agreeing the sale. 2. These particulars do not constitute part or all of an offer or contract. 3. The measurements indicated are supplied for guidance only and as such must be considered incorrect. Potential buyers are advised to recheck measurements before committing to any expense. 4. We have not tested any apparatus, equipment, fixtures, fittings or services and it is in the buyers interest to check the working condition of any appliances.

Connells Residential is registered in England and Wales under company number 1489613, Registered Office is Cumbria House, 16-20 Hockliffe Street, Leighton Buzzard, Bedfordshire, LU7 1GN. VAT Registration Number is 500 2481 05.

See all our properties at www.connells.co.uk | www.rightmove.co.uk | www.zoopla.co.uk

Property Ref: WVH333983 - 0004