



Connells

Clematis Drive
Pendeford Wolverhampton

Clematis Drive Pendeford Wolverhampton WV9 5SD

for sale offers in the region of
£270,000



Property Description

Connells Wolverhampton are delighted to bring to the market this well presented and attractive three bedroom semi-detached property in a popular cul-de-sac location. Benefiting from an abundance of internal space this property should be viewed in order to fully appreciate.

The property comprises of an entrance hall, downstairs wc, lounge, modern entertainment style kitchen diner, three spacious bedrooms, family bathroom, garage, driveway, front and rear gardens.

Location And Area

Situated in a popular cul-de-sac location within Pendeford offering fantastic commuting access to the new i54 commercial development which is also conveniently located for the M54 and adjoining M6 motorways.

Entrance Hallway

Double glazed door to front, doors to various rooms, stairs access.

Downstairs Wc

Double glazed window to front, wash hand basin, low flush toilet, radiator, door to entrance hall.

Lounge

14' 6" x 11' 8" (4.42m x 3.56m)

Double glazed window to front, door to kitchen, door to entrance hall, feature media wall, radiator.

Entertainment Kitchen Diner

9' 7" x 14' 9" (2.92m x 4.50m)

Double glazed window to rear, double glazed door to rear, stylish wall and base units with inset oven, hob and extractor, space for various appliances, space for a dining table, feature tiled flooring, radiator, storage cupboard, door to lounge.



First Floor Landing

Doors to various rooms.

Bedroom One

9' 4" x 11' 7" (2.84m x 3.53m)

Two double glazed windows to front, fitted wardrobes, radiator, door to landing.

Bedroom Two

7' 9" x 8' 3" (2.36m x 2.51m)

Double glazed window to rear, radiator, door to landing.

Bedroom Three

8' 5" x 4' 7" plus wardrobe recess (2.57m x 1.40m plus wardrobe recess)

Double glazed window to rear, radiator, door to landing.

Family Bathroom

Double glazed window to side, electric shower over a panelled bath, vanity sink, low flush toilet, door to landing.

Outside Front

Large gravelled area with paved pathway as well as tarmac driveway to side leading to the garage.

Garage

Up and over door to front

Outside Rear

Artificial lawned area, patio area, range of fencing and brick walling, door to garage.







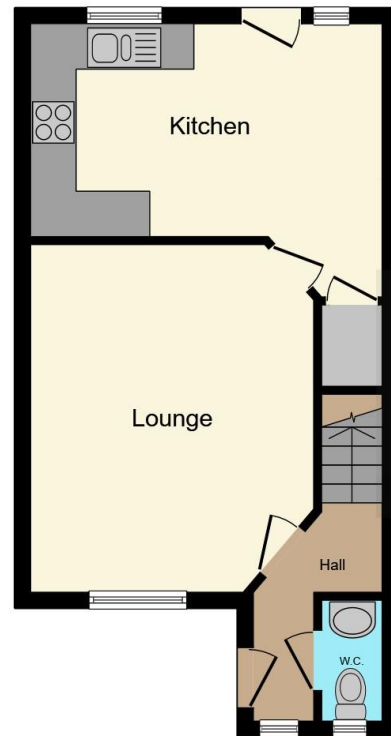

Ground Floor



First Floor

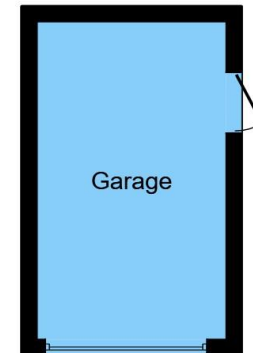

Garage

This floor plan is for illustrative purposes only. It is not drawn to scale. Any measurements, floor areas (including any total floor area), openings and orientation are approximate. No details are guaranteed, they cannot be relied upon for any purpose and they do not form part of any agreement. No liability is taken for any error, omission or misstatement. A party must rely upon its own inspection(s). Powered by www.focalagent.com

To view this property please contact Connells on

T 01902 710 170
E wolverhampton@connells.co.uk

81-83 Darlington Street
 WOLVERHAMPTON WV1 4EX

EPC Rating: C Council Tax
 Band: C

Tenure: Freehold

view this property online connells.co.uk/Property/WVH327911



1. MONEY LAUNDERING REGULATIONS Intending purchasers will be asked to produce identification documentation at a later stage and we would ask for your co-operation in order that there will be no delay in agreeing the sale. 2. These particulars do not constitute part or all of an offer or contract. 3. The measurements indicated are supplied for guidance only and as such must be considered incorrect. Potential buyers are advised to recheck measurements before committing to any expense. 4. We have not tested any apparatus, equipment, fixtures, fittings or services and it is in the buyers interest to check the working condition of any appliances.

Connells Residential is registered in England and Wales under company number 1489613, Registered Office is Cumbria House, 16-20 Hockliffe Street, Leighton Buzzard, Bedfordshire, LU7 1GN. VAT Registration Number is 500 2481 05.

See all our properties at www.connells.co.uk | www.rightmove.co.uk | www.zoopla.co.uk

Property Ref: WVH327911 - 0003