



Regent Street
Bilston WV14 6AJ

for sale offers in excess of
£325,000



Property Description

Connells Wolverhampton are delighted to bring to the market this impressive three bedroom detached family property close to popular transport access links. Benefiting from an abundance of internal space, this property should be viewed in order to fully appreciate.

The property comprises of entrance porch, entrance hall, lounge, dining room, sitting/study area, kitchen diner, utility and downstairs wc. On the first floor there are three bedrooms and wet room. Externally there is a large driveway, garage and low maintenance enclosed rear garden.

The Location & Area

Situated on a corner plot within the ever popular area of Bilston which offers a fantastic selection of local shopping just a stone's throw away. The M54 and M6 motorways can be accessed via the Black Country route which is also relatively close by. Within the area is a fantastic selection of local schools and bus routes linking to Bilston shopping areas.

Entrance Porch

Double glazed door to front, doors to entrance hall.

Entrance Hall

Doors to front, doors to various rooms, stairs to first floor landing

Lounge

15' x 12' 11" (4.57m x 3.94m)

Double glazed window to front, central heating radiator, doors to kitchen diner.

Kitchen Diner

9' x 16' 8" (2.74m x 5.08m)

Two double glazed windows to rear, a range of wall and base units, one and half stainless steel drainer sink, inset oven, hob and extractor, space for dining table and chairs, central heating radiator, door to utility room.

Utility Room

5' 9" x 7' 7" (1.75m x 2.31m)

Double glazed door to rear, double glazed window to rear, door to kitchen, door to garage, door to downstairs wc.

Downstairs Wc

Double glazed window to rear, low flush toilet, wash hand basin, door to utility room.

Sitting/ Study Area

6' 9" x 9' 9" (2.06m x 2.97m)

Double glazed bay window to front, central heating radiator, door to dining room, open to entrance hall.

Dining Room/ Bedroom Four

10' x 8' 10" (3.05m x 2.69m)

Double glazed window to rear, central heating radiator, door to entrance hall.

First Floor Landing

Doors to various rooms, double glazed window to rear.

Bedroom One

12' 7" x 12' 1" (3.84m x 3.68m)

Double glazed window to front, central heating radiator, storage cupboard, door to first floor landing.

Bedroom Two

14' 8" x 9' 9" (4.47m x 2.97m)

Double glazed window to front and rear, central heating radiator, door to first floor landing.

Bedroom Three

15' 1" x 10' 8" (4.60m x 3.25m)

Double glazed window to front, two central heating radiators, door to first floor landing.

Wet Room

Double glazed window to side and rear, electric shower, pedestal sink, central heating radiator, low flush toilet, door to first floor landing.

Garage

15' 8" x 10' 8" (4.78m x 3.25m)

Double doors to front, door to utility.

Outside Front

Concrete print driveway providing ample off road parking.

Outside Rear

Low maintenance enclosed rear garden

Agents Note

The sale of this Property is subject to Grant of Probate. Please seek an update from the Branch with regards to the potential timeframes involved







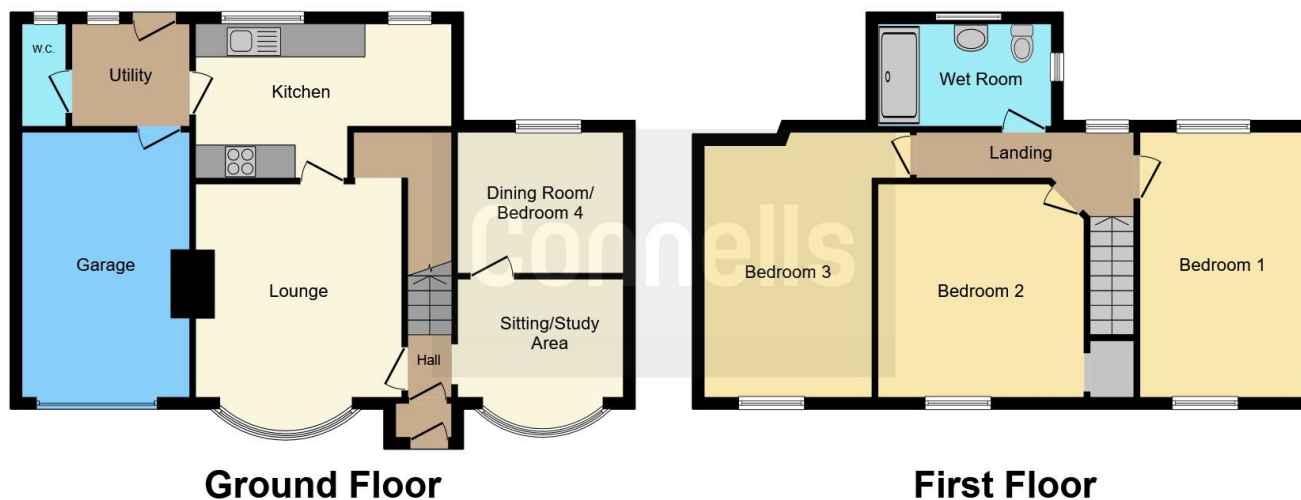

This floor plan is for illustrative purposes only. It is not drawn to scale. Any measurements, floor areas (including any total floor area), openings and orientation are approximate. No details are guaranteed, they cannot be relied upon for any purpose and they do not form part of any agreement. No liability is taken for any error, omission or misstatement. A party must rely upon its own inspection(s). Powered by www.focalagent.com

To view this property please contact Connells on

T 01902 710 170
E wolverhampton@connells.co.uk

81-83 Darlington Street
 WOLVERHAMPTON WV1 4EX

EPC Rating: D Council Tax
 Band: C

Tenure: Freehold

view this property online connells.co.uk/Property/WVH332043



1. MONEY LAUNDERING REGULATIONS Intending purchasers will be asked to produce identification documentation at a later stage and we would ask for your co-operation in order that there will be no delay in agreeing the sale. 2. These particulars do not constitute part or all of an offer or contract. 3. The measurements indicated are supplied for guidance only and as such must be considered incorrect. Potential buyers are advised to recheck measurements before committing to any expense. 4. We have not tested any apparatus, equipment, fixtures, fittings or services and it is in the buyers interest to check the working condition of any appliances.

Connells Residential is registered in England and Wales under company number 1489613, Registered Office is Cumbria House, 16-20 Hockliffe Street, Leighton Buzzard, Bedfordshire, LU7 1GN. VAT Registration Number is 500 2481 05.

See all our properties at www.connells.co.uk | www.rightmove.co.uk | www.zoopla.co.uk

Property Ref: WVH332043 - 0008