

for sale

offers over **£240,000**



High Clere Cradley Heath B64 7HT

A deceptively spacious family home in a sought after location by Haden Hill park close to shops, schools and transport links. Updated to a high standard throughout by the current owners this delightful family home briefly comprises: porch, hallway, downstairs w.c, lounge, re-fitted breakfast kitchen, three good sized bedrooms, re-fitted family bathroom, pleasant rear garden, integral garage and driveway

High Clere Cradley Heath B64 7HT

Approach

The property has a driveway to the front with steps and gate to rear access, electric roller door opens to garage and double glazed front door opens to porch

Porch

Tiled flooring and further door opening to hallway

Hallway

Tiled flooring, stairs to first floor accommodation, door to guest cloakroom, double glazed obscured window to side elevation, door to integral garage, central heating radiator

Guest Cloakroom

Comprising: low level w.c, vanity wash hand basin, tiled flooring, double glazed window to front elevation

First Floor Accommodation

Double glazed obscured window to side elevation, stairs to second floor and doors leading to:

Re-Fitted Breakfast Kitchen

15' 1" x 9' 4" (4.60m x 2.84m)

Fitted with a range of wall and base units with work surfaces over, sink and drainer, space for American fridge/freezer, plumbing for washing machine, central heating radiator, space for range cooker with cooker hood over, double glazed window to rear elevation and double glazed front door opening to rear garden

Lounge/dining Room

15' 1" x 12' 9" into bay (4.60m x 3.89m into bay)

Double glazed box bay window to front elevation, central heating radiator, electric fire with feature surround

Second Floor Accommodation

Useful storage cupboard, loft access and doors leading to:

Bedroom One

15' 2" x 9' 4" (4.62m x 2.84m)

Double glazed window to rear elevation, central heating radiator



Bedroom Two

10' 9" x 8' 6" (3.28m x 2.59m)

Double glazed window to front elevation with far reaching views, central heating radiator

Bedroom Three

10' 9" x 6' 4" (3.28m x 1.93m)

Double glazed window to front elevation with far reaching views, central heating radiator

Re-Fitted Bathroom

Comprising: bath with shower over, low level w.c, vanity wash hand basin, heated towel rail, tiled walls, double glazed obscured window to side elevation.

Integral Garage

18' x 7' 11" (5.49m x 2.41m)

Recently fitted roller door to the front, power and lighting and door to hallway

Rear Garden

Patio area with gate to front access, steps to lawn with further decked patio, fencing and bushes to borders, planting area to rear with mature shrubs and plants



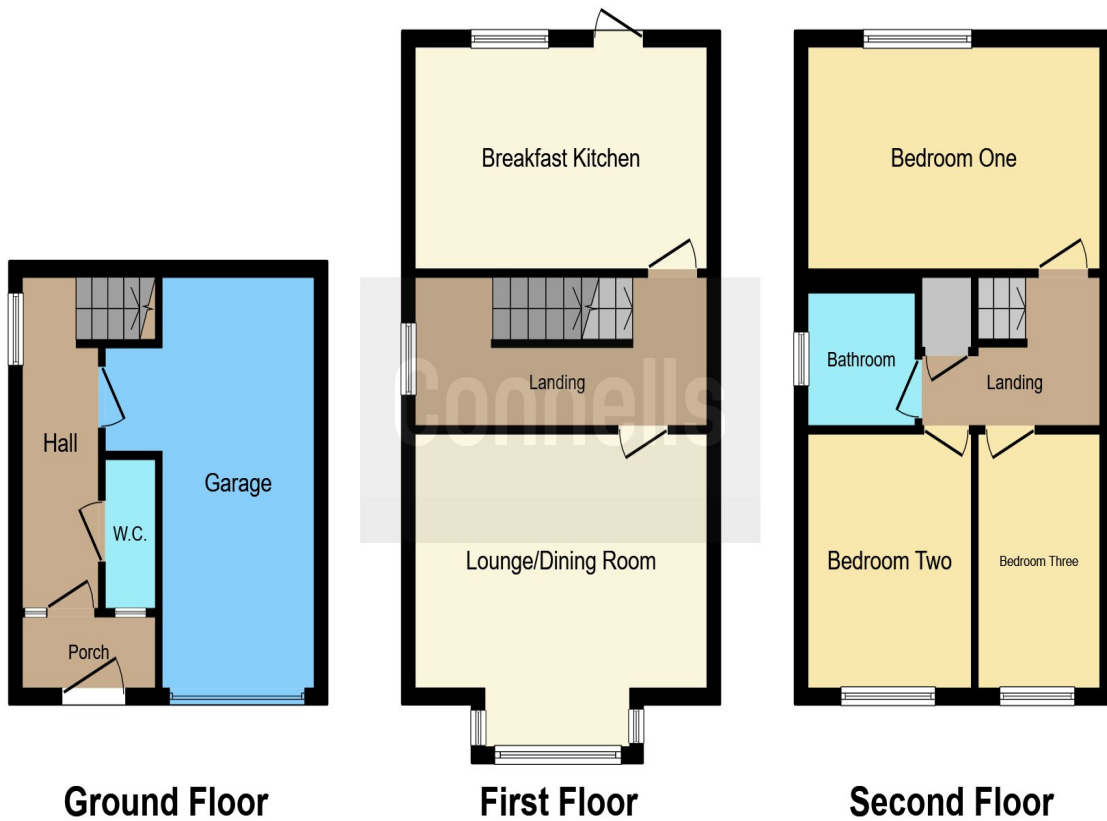

This floorplan is for illustrative purposes only and is not drawn to scale. Measurements, floor-areas, openings and orientations are approximate. They should not be relied upon for any purpose and do not form any part of an agreement. No liability is taken for any error or mis-statement. All parties must rely on their own inspections.

To view this property please contact Connells on

T 0121 550 6465
E halesowen@connells.co.uk

10 Hagley Road
 HALESOWEN B63 4RG

Property Ref: HSW314259 - 0004

Tenure: Freehold

EPC Rating: D

view this property online connells.co.uk/Property/HSW314259



1. MONEY LAUNDERING REGULATIONS Intending purchasers will be asked to produce identification documentation at a later stage and we would ask for your co-operation in order that there will be no delay in agreeing the sale. 2. These particulars do not constitute part or all of an offer or contract. 3. The measurements indicated are supplied for guidance only and as such must be considered incorrect. Potential buyers are advised to recheck measurements before committing to any expense. 4. We have not tested any apparatus, equipment, fixtures, fittings or services and it is in the buyers interest to check the working condition of any appliances.

Connells Residential is registered in England and Wales under company number 1489613, Registered Office is Cumbria House, 16-20 Hockliffe Street, Leighton Buzzard, Bedfordshire, LU7 1GN. VAT Registration Number is 500 2481 05.

see all our properties at www.connells.co.uk | www.rightmove.co.uk | www.zoopla.co.uk