



Bell Street Pensnett Brierley Hill DY5 4HG

for sale
£220,000



Property Description

This impeccably presented two-bedroom semi-detached residence is situated in a highly desirable residential neighborhood, conveniently close to Russell's Hall Hospital. The current owners have meticulously maintained the property to a high standard, achieving a show home quality that makes it move-in ready, particularly appealing for first-time buyers, with multiple years remaining on the building warranty. Additionally, the home is well-positioned near various amenities, schools, and transport links, enhancing its attractiveness.

Entrance Hall

Double glazed door to the front, built-in storage cupboard, central heating radiator.

Cloakroom

Comprising low level w.c., wash hand basin, central heating radiator, double glazed window to the front.

Lounge

14' 8" x 12' 9" (4.47m x 3.89m)

Double glazed doors to the rear, stairs to first floor, central heating radiator.

Kitchen

9' 8" x 7' 6" (2.95m x 2.29m)

A fitted gloss kitchen to include wall and base units with work surfaces over, stainless steel sink & drainer unit with mixer tap over, electric oven & gas hob with cooker hood over, plumbing for washing machine, integrated fridge freezer, tiling to splashback, central heating boiler, double glazed window to the front.

First Floor

Landing

Loft access.

Bedroom One

15' x 10' 7" (4.57m x 3.23m)

Double glazed window to the rear, central heating radiator.

Bedroom Two

11' 3" x 8' (3.43m x 2.44m)

Double glazed window to the front, central heating radiator.

Bathroom

Suite to comprise bath with electric shower, wash hand basin, low level w.c., central heating radiator, double glazed window to the front.

Outside

To the front of the property block paved driveway giving off road parking, side access to rear garden, electric car charging point.

Landscaped rear garden having paved patio area with step approach to lawned area, further patio area, pond, shrubs & borders, storage shed.







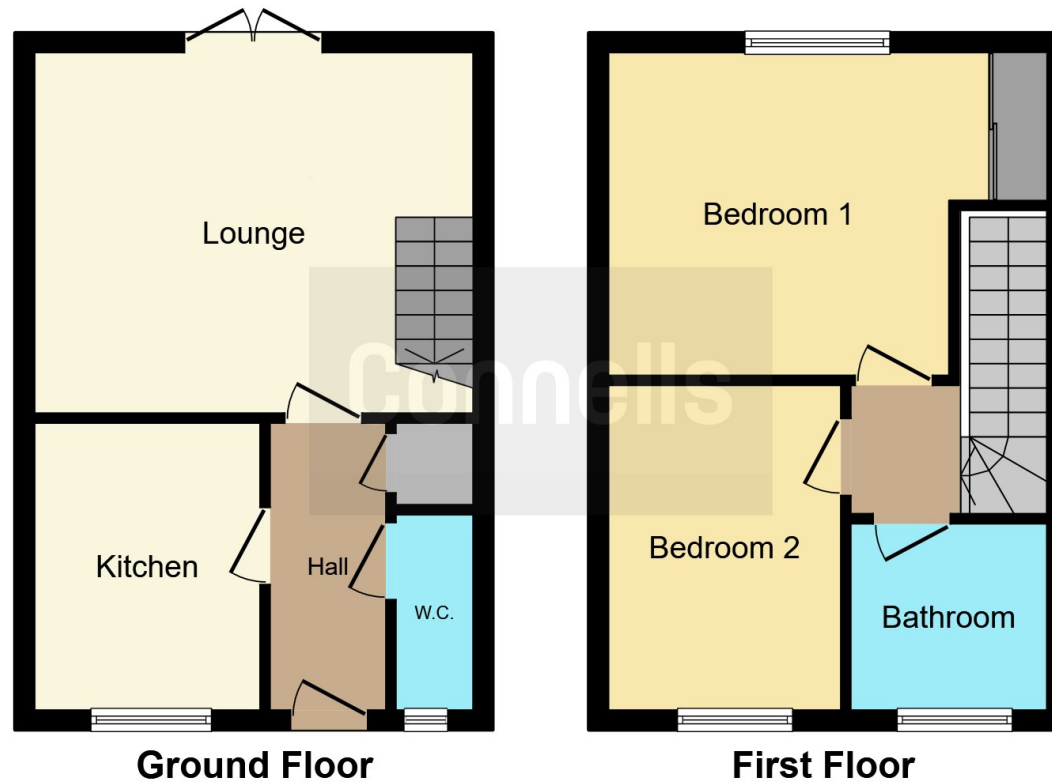

This floor plan is for illustrative purposes only. It is not drawn to scale. Any measurements, floor areas (including any total floor area), openings and orientation are approximate. No details are guaranteed, they cannot be relied upon for any purpose and they do not form part of any agreement. No liability is taken for any error, omission or misstatement. A party must rely upon its own inspection(s). Powered by www.focalagent.com

To view this property please contact Connells on

T 01384 214 770
E dudley@connells.co.uk

4 & 5 Stone Street
 DUDLEY DY1 1NS

EPC Rating: B

Tenure: Freehold

view this property online connells.co.uk/Property/DUD313617



1. MONEY LAUNDERING REGULATIONS Intending purchasers will be asked to produce identification documentation at a later stage and we would ask for your co-operation in order that there will be no delay in agreeing the sale. 2. These particulars do not constitute part or all of an offer or contract. 3. The measurements indicated are supplied for guidance only and as such must be considered incorrect. Potential buyers are advised to recheck measurements before committing to any expense. 4. We have not tested any apparatus, equipment, fixtures, fittings or services and it is in the buyers interest to check the working condition of any appliances.

Connells Residential is registered in England and Wales under company number 1489613, Registered Office is Cumbria House, 16-20 Hockliffe Street, Leighton Buzzard, Bedfordshire, LU7 1GN. VAT Registration Number is 500 2481 05.

See all our properties at www.connells.co.uk | www.rightmove.co.uk | www.zoopla.co.uk

Property Ref: DUD313617 - 0004