



Connells

Webley Grove
Dudley



Property Description

The property features generous living space, which includes an entrance hallway, a downstairs W.C., a kitchen diner, and a lounge that opens through French doors to the rear garden. On the first floor, there are three bedrooms along with a family bathroom. Externally, a private enclosed rear garden equipped with a timber shed. Additionally, there is a secure gated parking area at the back, providing two allocated parking spaces

Entrance Hallway

Entrance door to the front elevation, stairs to first floor accommodation, central heating radiator.

Cloakroom

Comprising low level w.c., wash hand basin, radiator, tiling to splashback.

Kitchen

13' 7" x 11' 9" (4.14m x 3.58m)

A fitted kitchen to comprise a range of wall and base units with roll top work surfaces over, electric oven & gas hob with extractor, stainless steel drainer sink unit, plumbing for washing machine and dish washer, space for domestic appliances, wall mounted central heating boiler, radiator, double glazed window to the front.

Lounge

14' 8" x 11' 4" (4.47m x 3.45m)

Double glazed french doors to the rear leading to garden, radiator, built-in storage cupboard, t.v. point, laminate floor.

First Floor

Landing

Loft access (partially boarded with pull down ladder), doors to

Bedroom One

14' 9" x 9' 7" (4.50m x 2.92m)

Two double glazed windows to the front elevation, built-in storage cupboard, central heating radiator.

Bedroom Two

9' 1" x 8' (2.77m x 2.44m)

Double glazed window to the rear, central heating radiator.

Bedroom Three

6' 8" x 6' 6" (2.03m x 1.98m)

Double glazed window to the rear, central heating radiator.

Bathroom

Suite to comprise paneled bath with electric shower over & glass shower screen, wash hand basin, low level w.c., central heating radiator, tiling, extractor fan.

Outside

To the front of the property low maintenance gravel foregarden, to the side of the property entry to rear car park having two allocated parking spaces. Rear garden having paved patio area, lawned area with borders & various plants & shrubs, shed, gate giving rear access.

Agents Notes

MANAGED FREEHOLD

The sellers advise that they pay £220.56 per annum for car park.







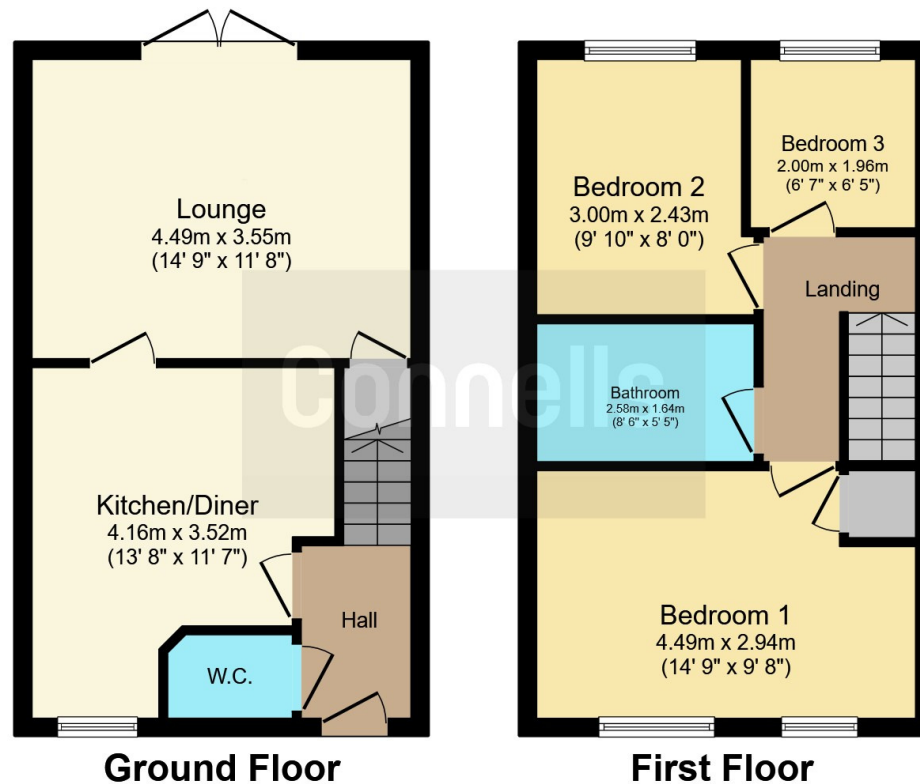

This floor plan is for illustrative purposes only. It is not drawn to scale. Any measurements, floor areas (including any total floor area), openings and orientation are approximate. No details are guaranteed, they cannot be relied upon for any purpose and they do not form part of any agreement. No liability is taken for any error, omission or misstatement. A party must rely upon its own inspection(s). Powered by www.focalagent.com

To view this property please contact Connells on

T 01384 214 770
E dudley@connells.co.uk

4 & 5 Stone Street
 DUDLEY DY1 1NS

EPC Rating: C Council Tax
 Band: B

Tenure: Freehold

view this property online connells.co.uk/Property/DUD313626



1. MONEY LAUNDERING REGULATIONS Intending purchasers will be asked to produce identification documentation at a later stage and we would ask for your co-operation in order that there will be no delay in agreeing the sale. 2. These particulars do not constitute part or all of an offer or contract. 3. The measurements indicated are supplied for guidance only and as such must be considered incorrect. Potential buyers are advised to recheck measurements before committing to any expense. 4. We have not tested any apparatus, equipment, fixtures, fittings or services and it is in the buyers interest to check the working condition of any appliances.

Connells Residential is registered in England and Wales under company number 1489613, Registered Office is Cumbria House, 16-20 Hockliffe Street, Leighton Buzzard, Bedfordshire, LU7 1GN. VAT Registration Number is 500 2481 05.

See all our properties at www.connells.co.uk | www.rightmove.co.uk | www.zoopla.co.uk

Property Ref: DUD313626 - 0007