

for sale

£240,000



Quarry Brow Upper Gornal Dudley DY3 1UA

****A MUCH IMPROVED AND BEAUTIFULLY PRESENTED THREE BEDROOM FAMILY HOME LOCATED IN THE POPULAR RESIDENTIAL AREA OF UPPER GORNAL****

Quarry Brow Upper Gornal Dudley DY3 1UA

Entrance Hallway

Double glazed entrance door to the front elevation, radiator, stairs to first floor accommodation, doors to

Lounge

14' 9" x 12' 1" (4.50m x 3.68m)

Double glazed window to the front elevation, feature log burner, t.v. point, central heating radiator.

Kitchen Diner

18' 3" x 7' 9" (5.56m x 2.36m)

Refitted kitchen to comprise a range of wall and base units with roll top work surfaces over, inset belfast style sink, integrated fridge, integrated freezer, electric oven & gas hob with extractor, wall mounted central heating boiler, integrated washer dryer, integrated dishwasher, double glazed window to the rear, double glazed door to the side elevation.

Inner Lobby

Double glazed door to the side & garden, understairs storage cupboard.

Cloakroom

Suite to comprise low level w.c, chrome heated towel rail.



First Floor

Landing

Double glazed window to side, loft access, doors to

Bedroom One

11' 9" x 10' 3" (3.58m x 3.12m)

Double glazed window to the front, built-in wardrobe, solid wood floor.

Bedroom Two

12' x 7' 9" (3.66m x 2.36m)

Double glazed window to the rear, radiator.

Bedroom Three

8' 1" x 7' (2.46m x 2.13m)

Double glazed window, radiator.

Bathroom

Refitted suite to comprise paneled bath with shower over, wash hand basin in vanity unit, low level w.c., chrome heated towel rail, tiled, double glazed window.

Outside

To the front of the property block paved driveway giving off road parking. Low maintenance landscaped rear garden, shed, gate giving. side access.



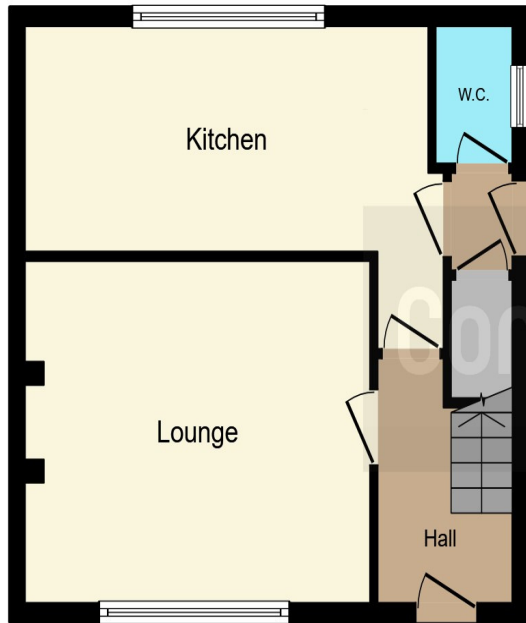

Ground Floor

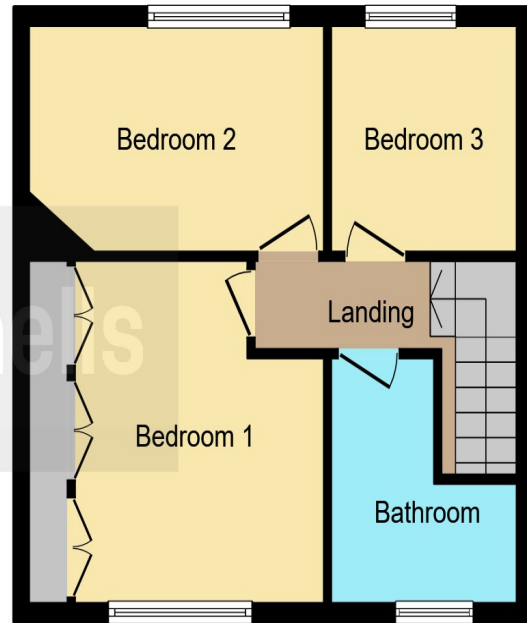

First Floor

This floor plan is for illustrative purposes only. It is not drawn to scale. Any measurements, floor areas (including any total floor area), openings and orientation are approximate. No details are guaranteed, they cannot be relied upon for any purpose and they do not form part of any agreement. No liability is taken for any error, omission or misstatement. A party must rely upon its own inspection(s). Powered by www.focalagent.com

To view this property please contact Connells on

T 01384 214 770
E dudley@connells.co.uk

4 & 5 Stone Street
 DUDLEY DY1 1NS

Property Ref: DUD312850 - 0004

Tenure: Freehold

EPC Rating: C

view this property online connells.co.uk/Property/DUD312850



1. MONEY LAUNDERING REGULATIONS Intending purchasers will be asked to produce identification documentation at a later stage and we would ask for your co-operation in order that there will be no delay in agreeing the sale. 2. These particulars do not constitute part or all of an offer or contract. 3. The measurements indicated are supplied for guidance only and as such must be considered incorrect. Potential buyers are advised to recheck measurements before committing to any expense. 4. We have not tested any apparatus, equipment, fixtures, fittings or services and it is in the buyers interest to check the working condition of any appliances.

Connells Residential is registered in England and Wales under company number 1489613, Registered Office is Cumbria House, 16-20 Hockliffe Street, Leighton Buzzard, Bedfordshire, LU7 1GN. VAT Registration Number is 500 2481 05.

see all our properties at www.connells.co.uk | www.rightmove.co.uk | www.zoopla.co.uk