



Connells

Oakham Road
Tividale Oldbury



Property Description

A rare opportunity to acquire a prestigious detached family residence offering spacious and contemporary style living.

set on a substantial plot with great potential to extend with previous planning permission granted for a two storey dwelling. A versatile family home that has been well maintained and beautifully presented to a high specification throughout. The accommodation would be ideal for an extended family to offer independent living.

The property is located in the ever popular and sought after residential area of Oakham and is conveniently placed for local schools, shops & amenities.

Entrance Porch

Double glazed door to the front.

Entrance Hall

Double glazed door to the front, central heating radiator, stairs to first floor accommodation two understairs stores.

Cloakroom

Low level w.c, wash hand basin in vanity unit, central heating radiator, double glazed window to the rear.

Lounge

19' 6" x 11' 9" (5.94m x 3.58m)

Double glazed window to the front, central heating radiator, electric fire with feature surround.

Kitchen / Diner

11' 6" x 19' 6" (3.51m x 5.94m)

Stylish Fitted gloss kitchen to include a range of wall and base units with work surfaces over, sink & drainer unit with mixer tap over, electric oven & gas hob with cooker hood over, space for domestic appliances, integrated fridge/ freezer, integrated dishwasher, breakfast bar, double glazed window to rear elevation.

Dining area to having double glazed patio doors to the rear, central heating radiator.

Utility Room

6' 5" x 6' 4" (1.96m x 1.93m)

Plumbing for washing machine & space for domestic appliances, double glazed door to side.

Lean To

13' 8" x 9' 7" (4.17m x 2.92m)

Double glazed doors & windows to both front & rear, outside tap.

First Floor

Landing

Double glazed window to the side, loft access, airing cupboard housing boiler.

Bedroom One

11' 9" x 9' (3.58m x 2.74m)

Double glazed window to the front, central heating radiator.

En-Suite

Shower cubicle, wash hand basin.

Bedroom Two

12' 2" x 10' 2" (3.71m x 3.10m)

Double glazed window to the rear, central heating radiator.

Bedroom Three

12' 2" x 12' (3.71m x 3.66m)

Double glazed window to the front, central heating radiator.

Bedroom Four

12' 2" x 7' 4" (3.71m x 2.24m)

Double glazed window to the side, central heating radiator.

Bathroom

Bath, wash hand basin, low level w.c, heated chrome towel rail, double glazed window to the side.

Double Garage

32' (max) x 16' (max) (9.75m (max) x 4.88m (max))

Having door to front, spacious double garage offering work shop, storage space, built in storage space & pond area.

Double glazed door to rear leading to garden & double glazed windows to rear.

Outside

To the front of the property drive on & drive off driveway giving off road parking, various shrubs and borders.

Rear garden having paved patio area with step approach leading to lawned area with summer house, storage shed & detached pool area.









Ground Floor

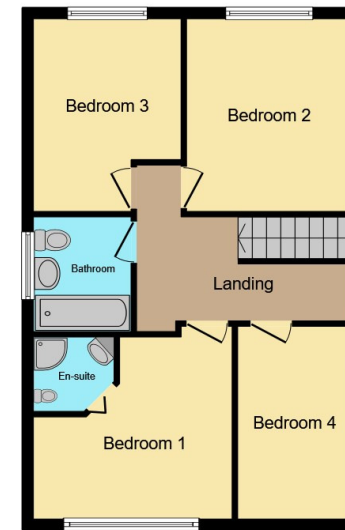

First Floor

This floorplan is for illustrative purposes only and is not drawn to scale. Measurements, floor-areas, openings and orientations are approximate. They should not be relied upon for any purpose and do not form any part of an agreement. No liability is taken for any error or mis-statement. All parties must rely on their own inspections.

To view this property please contact Connells on

T 01384 214 770
E dudley@connells.co.uk

4 & 5 Stone Street
 DUDLEY DY1 1NS

EPC Rating: C

Tenure: Freehold

view this property online connells.co.uk/Property/DUD312433



1. MONEY LAUNDERING REGULATIONS Intending purchasers will be asked to produce identification documentation at a later stage and we would ask for your co-operation in order that there will be no delay in agreeing the sale. 2. These particulars do not constitute part or all of an offer or contract. 3. The measurements indicated are supplied for guidance only and as such must be considered incorrect. Potential buyers are advised to recheck measurements before committing to any expense. 4. We have not tested any apparatus, equipment, fixtures, fittings or services and it is in the buyers interest to check the working condition of any appliances.

Connells Residential is registered in England and Wales under company number 1489613, Registered Office is Cumbria House, 16-20 Hockliffe Street, Leighton Buzzard, Bedfordshire, LU7 1GN. VAT Registration Number is 500 2481 05.

See all our properties at www.connells.co.uk | www.rightmove.co.uk | www.zoopla.co.uk

Property Ref: DUD312433 - 0009