



**Price**

**£225,000**

**Leasehold**

1x  1x  1x 

**Willow Close, Beare  
Green, Dorking, Surrey,  
RH5**

**OVER 60?**

Secure this property  
for up to **59% less!**

**cubitt&west**  
Helping you move forwards





## Main features

- Good size lounge/diner with doors to garden
- Built-in wardrobes in bedroom
- Good sized, low maintenance, private garden with summer house
- Communal parking
- Sought after village location, close to Holmwood station
- Suitable for wheelchair access

## Accommodation

### GROUND FLOOR

Entrance Hall

Lounge/Diner: 22'5 x 10'4 (6.84m x 3.15m)

Kitchen : 7'9 x 6'10 (2.36m x 2.08m)

Bedroom: 11'10 x 9'9 up to fitted wardrobes (3.61m x 2.97m)

Bathroom

### OUTSIDE

Rear Private Garden

Summer house with Electric

Private Brick Built Shed

Communal Parking

## Ground Floor

Approx. 47.0 sq. metres (505.5 sq. feet)

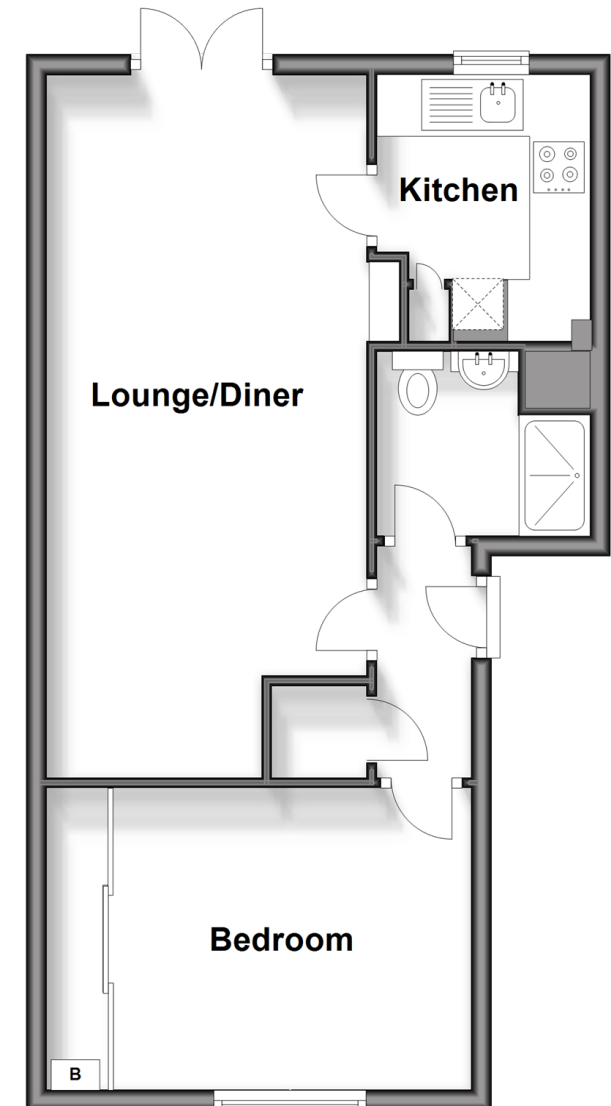

**Call Dorking - 01306 883399 ■ [cubittandwest.co.uk](http://cubittandwest.co.uk)**

- Legal advice should be taken to verify fixtures/fittings, planning, alterations and/or lease details
- Appliances & services are untested, dimensions are approximate and floor plans are not to scale
- Through a Homewise Home For Life Plan people aged 60+ can secure this property for up to 59% less, by purchasing a Lifetime Lease.

