



Price
£325,000

Leasehold

2x  1x  1x 

**Ridge Close, Strood
Green, Brockham,
Betchworth, Surrey, RH3**

OVER 60?

Secure this property
for up to **59% less!**

cubitt & west
Helping you move forwards



Main features

- Sought after village location
- Large rear garden and ample driveway parking
- Short walk into the heart of Brockham Village
- Lapsed planning to extend (MO/2019/1168)
- Countryside walking trails on your doorstep

Accommodation

GROUND FLOOR

Entrance Hall

Lounge/Diner: 13'6 x 11'10 (4.12m x 3.61m)

Kitchen: 11'5 x 10'0 (3.48m x 3.05m)

Bedroom 1: 14'6 x 10'10 (4.42m x 3.30m)

Bedroom 2: 10'7 x 9'6 (3.23m x 2.90m)

Bathroom

OUTSIDE

Driveway

Rear Garden

Storage Sheds

Ground Floor

Approx. 64.6 sq. metres (695.7 sq. feet)

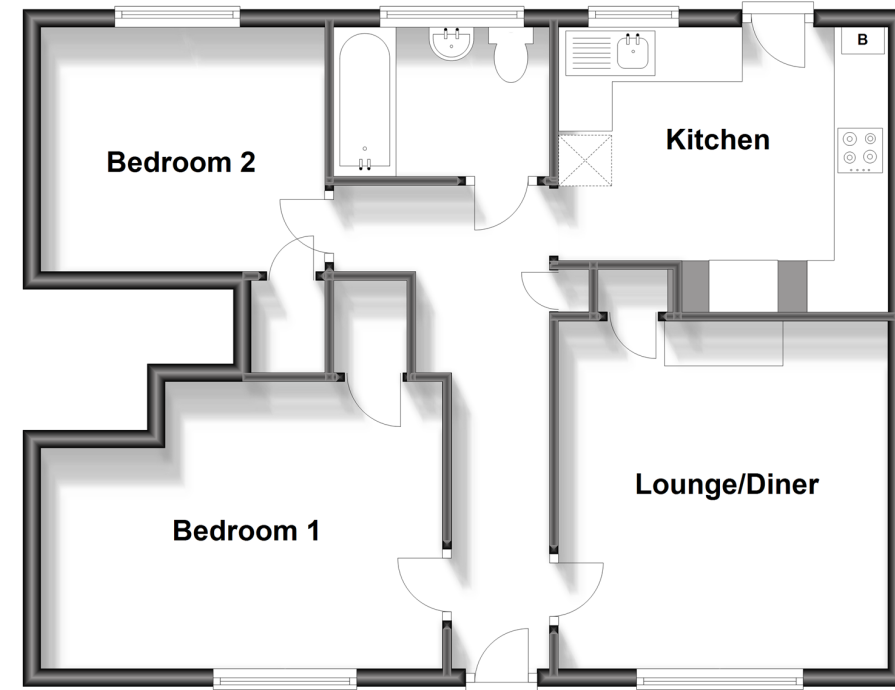

Call Dorking - 01306 883399 ■ cubittandwest.co.uk

- Legal advice should be taken to verify fixtures/fittings, planning, alterations and/or lease details
- Appliances & services are untested, dimensions are approximate and floor plans are not to scale
- Through a Homewise Home For Life Plan people aged 60+ can secure this property for up to 59% less, by purchasing a Lifetime Lease.



20511210/20241023/CFE/GJ