



1

Bedroom



1

Bathroom



Charming Ground-Floor One-Bedroom Retirement Apartment in Stretford

This delightful one-bedroom retirement apartment is situated on the ground floor of a well-maintained development, perfectly positioned near the Chorlton-cum-Hardy border and the ever-popular Longford Park. Offering a blend of comfort, security, and convenience, this home is ideal for those seeking a peaceful yet well-connected lifestyle.

Inside, you'll find a spacious and inviting living room, perfect for relaxation, along with a separate modern shower room. The property also features an ultramodern video entry system, providing added security and peace of mind.

Residents enjoy access to a welcoming communal lounge, ideal for socialising, as well as beautifully maintained gardens and a charming courtyard. Additional amenities include a convenient on-site laundry room and a lift providing access to all floors.

With local amenities close by and serene green spaces just a short stroll away, this apartment offers the perfect balance of tranquillity and accessibility.

GROUND FLOOR

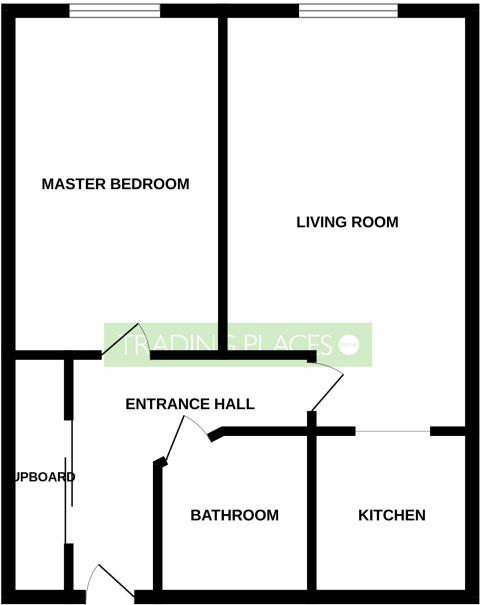

FLAT 4 THE HAWTHORNS, 114 EDGE LANE, STRETFORD, MANCHESTER, M32 8QA

Whilst every attempt has been made to ensure the accuracy of the footprint contained here, measurements of doors, windows, rooms and any other items are approximate and no responsibility is taken for any error, omission or misstatement. This plan is for illustrative purposes only and should be used as such by any prospective purchaser. The services, systems and appliances shown have not been tested and no guarantee as to their operability or efficiency can be given.
Made with Metagrip ©2025

Energy Efficiency Rating		
	Current	Potential
Very energy efficient - lower running costs		
(92+) A		
(81-91) B		
(69-80) C	78	82
(55-68) D		
(39-54) E		
(21-38) F		
(1-20) G		
Not energy efficient - higher running costs		
England, Scotland & Wales		
	EU Directive 2002/91/EC	

Address: The Hawthorns, Stretford, M32 8QA

