



 3
Bedrooms

 1
Bathroom





Trading Places are pleased to present this ****THREE BEDROOM END OF TERRACE**** property to the sales market. In need of a complete modernisation throughout the property has been priced to sell! Conveniently located for the M60 Motorway providing excellent transport links in and around the Greater Manchester area, and a short distance from the Trafford Centre. Briefly, the property comprises to the ground floor, entrance, lounge, dining kitchen, and to the first floor there are three bedrooms and a family bathroom. To the front of the property, there is ample space for off road parking, and to the rear of the property there is a spacious garden. **VIEWINGS BEING INVITED WITH IMMEDIATE EFFECT. IF YOU ARE LOOKING TO PUT THE HEART BACK INTO THIS FAMILY HOME AND ENJOY A PROJECT - LOOK NO FURTHER ! - An ideal opportunity for INVESTORS AND CASH BUYERS - EPC RATING C**

LOUNGE

KITCHEN DINER

BEDROOM 1

BEDROOM 2

BEDROOM 3

FAMILY BATHROOM

EXTERNAL

GROUND FLOOR

1ST FLOOR

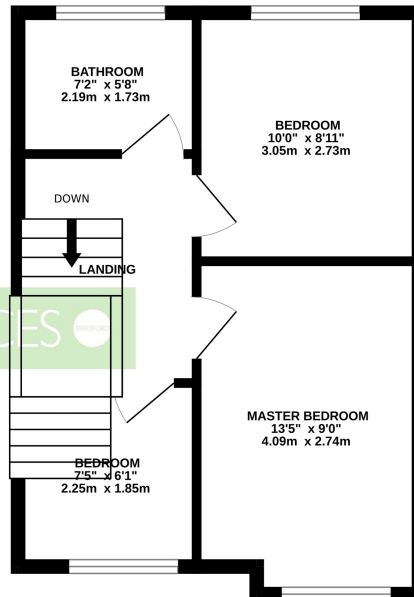
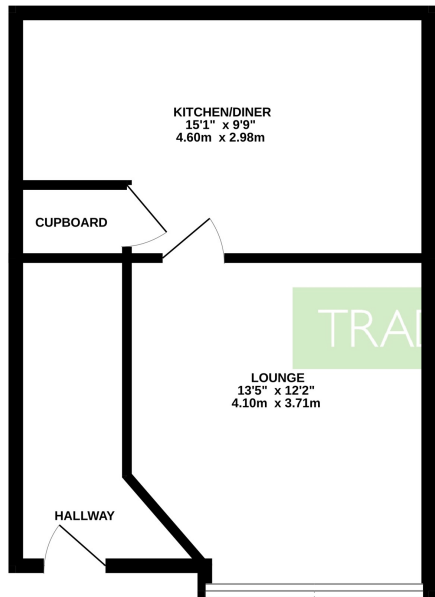

Energy Efficiency Rating		Current	Potential
<i>Very energy efficient - lower running costs</i>			
(92+)	A		
(81-91)	B		85
(69-80)	C	69	
(55-68)	D		
(39-54)	E		
(21-38)	F		
(1-20)	G		
<i>Not energy efficient - higher running costs</i>			
England, Scotland & Wales		EU Directive 2002/91/EC	

Address: Stretford, M32



Whilst every attempt has been made to ensure the accuracy of the floorplan contained here, measurements of doors, windows, rooms and any other items are approximate and no responsibility is taken for any error, omission or mis-statement. This plan is for illustrative purposes only and should be used as such by any prospective purchaser. The services, systems and appliances shown have not been tested and no guarantee as to their operability or efficiency can be given.
Made with Metropix ©2024

