



 2
Bedrooms

 1
Bathroom





Trading Places welcome this inviting two-bedroom apartment located on the second floor of the Tree Walk complex in Stretford. Offering a blend of comfort and convenience.

The expansive living and dining area provides a versatile space perfect for relaxation. The kitchen includes some appliances with space and plumbing for extra appliances and utilities.

Both bedrooms are generously sized, offering ample room for furniture and personal touches. The bathroom features a full-size bath with an overhead shower, offering both practicality and a touch of luxury.

This apartment boasts multiple storage cupboards throughout, ensuring that you have plenty of space to keep your home organised. Additionally, there is a convenient storage room within the apartment and a separate storage room located on the ground floor.

Tree Walk is located close to local amenities, public transport links, the Metrolink and the vibrant community of Stretford.

Don't miss out on this exceptional property – schedule a viewing today to experience all that this lovely apartment has to offer.

Entrance

uPVC door and double-glazed frosted window to hallway. Two storage cupboards. Tiled flooring and access to loft.

Living/Dining Room

Large double-glazed window, laminate flooring and electric radiator.

Kitchen

Wall and base units with integrated electric hob, oven, extractor fan and sink with a drainer and mixer tap. Plumbing for utilities. Tiled flooring and tiled backsplash. Double-glazed window and electric radiator.

Bedroom 1

Two windows in the bedroom and an electric radiator.

Bedroom 2

Double-glazed window and electric radiator.

Bathroom

Panel bath with overhead electric shower, pedestal sink and toilet. Tiled flooring and part tiled walls. Double-glazed frosted window and radiator.

Storage Room

Storage space with boiler and window.

GROUND FLOOR

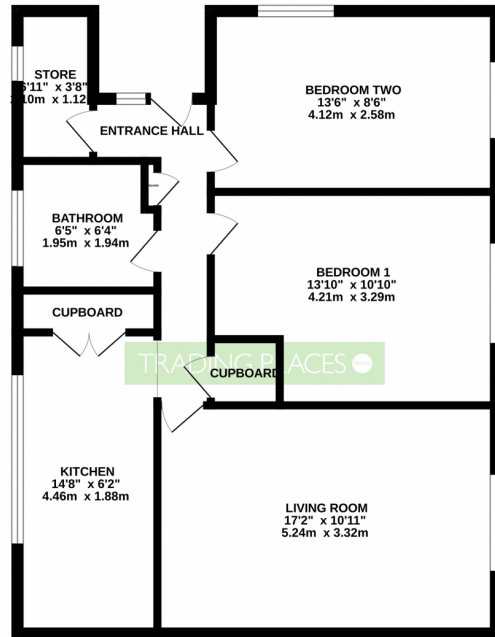

6 TREE WALK, STRETFORD, MANCHESTER, M32 9AL

Whilst every attempt has been made to ensure the accuracy of the floorplan contained here, measurements of doors, windows, rooms and any other items are approximate and no responsibility is taken for any error, omission or mis-statement. This plan is for illustrative purposes only and should be used as such by any prospective purchaser. The services, systems and appliances shown have not been tested and no guarantee as to their operability or efficiency can be given.
Made with Metropix ©2024

