





57, Oxford Road, MACCLESFIELD, Cheshire SK11 8JE

TO LET This two bedroom terrace offers spacious accommodation within walking distance of the town centre and all local amenities. Benefitting from gas fired central heating and uPVC double glazing, the well presented accommodation comprises lounge/dining area and kitchen on the ground floor whilst to the first floor there are two bedrooms and a bathroom. The property also has the further benefit of a delightful private garden to the rear. The property is set back from Oxford Road behind a green and there is a Residents' Parking Scheme.

Available immediately and offered part furnished. A pet will be considered for an additional £25.00 per month. Minimum 12 month tenancy. Tax band A. £100 Holding Deposit.

Viewings by appointment via Holden & Prescott.

From the top end of Chestergate proceed along Chester Road and turn left at the roundabout by the Regency Hospital into Oxford Road and the property can be found on the left hand side.

Macclesfield is a thriving business centre and market town with excellent local amenities and a choice of modern leisure and sports facilities. The town is situated on the Cheshire Plain, at the edge of the Peak District National Park with its picturesque beauty and extensive walks.

Residents of Macclesfield have access to good transport links including national motorways, major roads and train networks, including the West Coast Line direct to London. Manchester International Airport is only thirteen miles away by road. Greater Manchester is within comfortable daily travelling distance and there are regular bus services to neighbouring towns.

From the top end of Chestergate proceed along Chester Road and turn left at the roundabout by the Regency Hospital into Oxford Road and the property can be found on the left hand side.

Viewing: By appointment with Holden and Prescott 01625 422244

Lounge

11'11" x 11'9"

Dining Room

11'9" x 7'2"

Kitchen

11'5" x 8'7"

Landing

Bedroom One

11'11" x 11'9"

Bedroom Two

8'8" x 5'0"

Bathroom

Private Garden

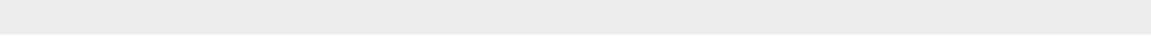

£850 Per Calendar Month

HOLDEN & PRESCOTT

Ground Floor

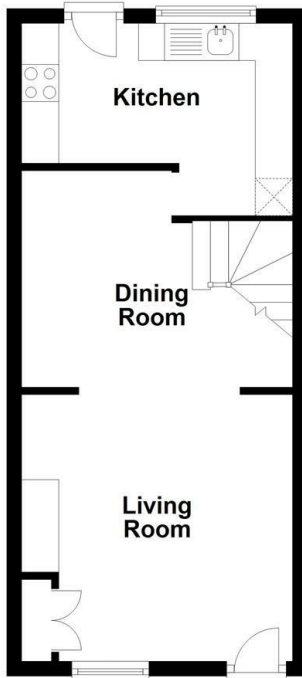

First Floor





