





## 21, Roe Street, Cheshire, SK11 6UT

\*\*\*To Let\*\*\* A well presented mid terrace property with a stylish finish throughout offer great accommodation with two double bedrooms and a private yard to the rear. Ideally situated for the centre of town and links into Manchester and London. Briefly comprising of 25' living dining room and kitchen. Whilst to the first floor there are two bedrooms and a good size bathroom. Gas central heating and uPVC double glazing are installed.

Parking can be obtained in Duke Street car park which can be access from the garden, permits from the council.

Available from middle of June and offered part furnished with cooker, washer dryer and fridge freezer. No Pets. Minimum 12 month tenancy. Tax band A. £100 Holding Deposit.

By appointment with Holden and Prescott

From the Station proceed along Sunderland Street towards Park Green. Continue across the traffic lights into Park Street and right at the mini roundabout into Churchill Way. Having crossed the next mini roundabout Roe Street can be found on the right hand side.

From the Station proceed along Sunderland Street towards Park Green. Continue across the traffic lights into Park Street and right at the mini roundabout into Churchill Way. Having crossed the next mini roundabout Roe Street can be found on the right hand side.

**Viewing: By appointment with Holden and Prescott 01625 422244**

---

**Living Room**

25'3 x 11'3

**Kitchen**

11'3 x 9'1

**Landing**

**Bedroom One**

14'3 x 11'3

**Bedroom Two**

9'1 x 8'10

**Bathroom**

10'10 x 4'11

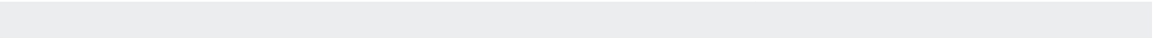

**£875 PCM**

**HOLDEN & PRESCOTT**

Ground Floor

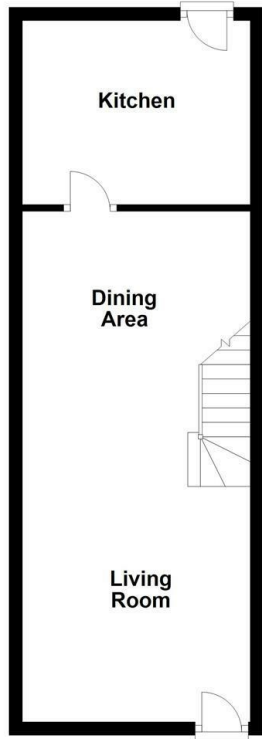

First Floor

