



*16 Antony Close*



# 16 Antony Close Canvey Island Essex SS8 9PF

£1,550 PCM



Four-Bedroom Detached House Overlooking Canvey's Lake

Location: Canvey Island  
Property Type: Detached House  
Bedrooms: Four  
Kitchen: Large, spacious kitchen  
Bathrooms: Ground floor cloakroom

A stunning four-bedroom detached home with beautiful views over Canvey's Lake. This property features a generously sized kitchen and a convenient ground-floor cloakroom, offering both comfort and practicality.

Some of the photos were taken a few years ago and are for guidance purposes only.

Deposit: Equivalent to four weeks' rent, secured with the Deposit Protection Scheme  
Accredited Letting Agents: We are proud members of the Association of Residential Letting Agents

Enquiries: Due to high call volumes, we kindly ask all interested parties to contact us via email or online enquiry.

Richard Poyntz – Canvey Island



## Hall

Central composite entrance door with obscure double-glazed panel leading to the entrance hall, radiator, laminate wood flooring, stairs to the first floor, textured ceiling, power points, dado rail. With accommodation off.

## Cloakroom

With obscure double-glazed Georgian style window to the front, suite comprising of low level w/c, wash hand basin inset to vanity unit, laminate wood flooring with half wood paneling to the walls.

## Kitchen/Breakfast room

13'6x9'5 (4.11mx2.87m)

UPVC double-glazed window to the front elevation with UPVC half double-glazed door to the side with 1¼ single drainer sink unit inset to square edge working surfaces to three sides with wood finished units at base and eye level, ceramic tiled splash backs,

wall mounted boiler, space for oven with extractor canopy fitted over, two glazed display cabinet, plumbing and space for washing machine, integrated fridge/freezer to remain, dado rail and textured ceiling, radiator, laminate style effect flooring, space for table and chairs and twin part glazed double doors providing access to the lounge.

## Lounge

16'x15'7 into bay (4.88mx4.75m into bay )

Feature UPVC double-glazed Georgian style bay window overlooking the rear garden with TV and power points, dado rail, coved and textured ceiling, laminate wood flooring, feature fireplace with electric point, additional door providing access to the hall and provision for wall lights.

## First Floor Landing

Double-glazed Georgian style window to the side, textured ceiling,



power points, door to airing cupboard housing hot water tank and shelving, dado rail, doors off to the accommodation.

#### **Bedroom One**

12'2x9'1 (3.71mx2.77m)

Double-glazed Georgian style window to the rear elevation affording views over Canvey's Lake, radiator, laminate wood flooring, textured ceiling, power points.

#### **Bedroom Two**

10'6x9'6 max (3.20mx2.90m max )

UPVC double-glazed Georgian style window to the front elevation, dado rail, radiator, textured ceiling, power points, recessed area with inset fitted wash hand basin into vanity cupboard below, laminate wood flooring.

#### **Bedroom Three**

9'x6'5 (2.74mx1.96m )

UPVC double-glazed Georgian style window to the rear elevation again affording views over Canvey's Lake, radiator, power points.

#### **Bedroom Four**

7'x6' (2.13mx1.83m )

UPVC double-glazed Georgian style window to the front elevation, radiator, power points, laminate wood flooring, textured ceiling.

#### **Bathroom**

Obscure double-glazed Georgian style window to the side. A modern suite comprising of panelled bath with fitted shower over and screen, low level w/c, pedestal wash hand basin, radiator, textured ceiling, inset spot lights, ceramic tiling to the walls, laminate style effect flooring.

#### **Front Garden**

As mentioned previously a good size frontage being mainly laid to lawn with established shrubbery, personal door providing access to the garage

#### **Rear Garden**

Extends a low maintenance garden being mainly laid to concrete with external light, fencing to the boundaries, personal gate to the rear providing direct access onto the Lake and further side access leading to the front.

#### **Garage**

Up and over door to the front.



## Ground Floor

Approx. 46.0 sq. metres (494.7 sq. feet)

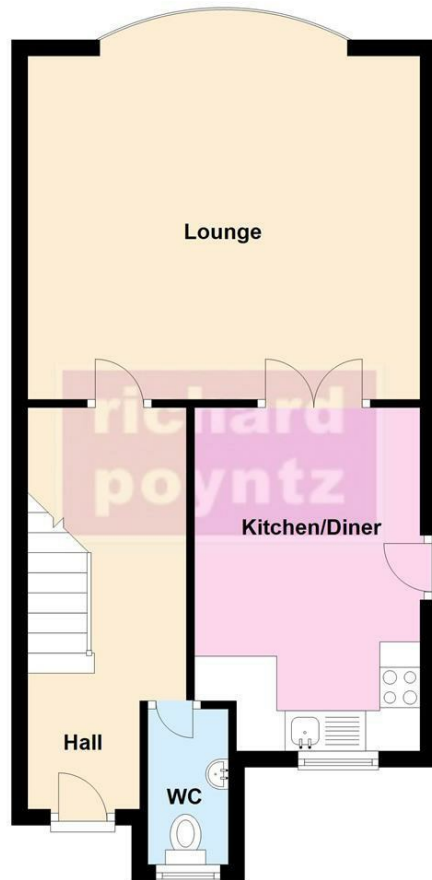

## First Floor

Approx. 41.9 sq. metres (450.8 sq. feet)



**Misrepresentation Act 1967:** These details are prepared as a general guide only, and should not be relied upon as a basis to enter a legal contract or commit expenditure. And any interested party should rely solely on their own Surveyor, Solicitor/Conveyancer or other professionals before committing themselves to any expenditure or other legal commitments. If any interested party wishes to rely upon any information from the Agent, then a request should be made and specific written confirmation can be provided. The Agent will not be responsible for any verbal statement made by the Agent or any member of Staff, as only a specific written confirmation can be provided. The Agent will not be responsible for any loss other than what specific written confirmation has been requested.

**Property Misdescription Act 1991** The Agent has not tested any apparatus, equipment, fixture, fittings or services and so does not verify they are in working order, fit for purpose, or within ownership of the sellers, therefore the buyer must assume the information is incorrect. Neither has the Agent checked the legal documentation to verify legal status of the property. A buyer must assume the information is incorrect until it has been verified by their own Solicitors/Conveyancers. Nothing concerning the type of construction or the condition of the structure is to be implied from the photograph or plans for the property. Photographs of the interior of the property are given purely to give an indication of décor/style etc. and does not imply that any furniture/fittings etc., are included. A fixtures & fittings list will be provided by the Solicitors/Conveyancers in due course. The sales particulars may change in the course of time and any interested party is advised to make a final inspection of the property prior to exchange of contracts



Tel No: 01268 699 599 | Fax: 01268 699 080 | Email: [rp@richardpoyntz.com](mailto:rp@richardpoyntz.com)  
Registered Office: Richard Poyntz & Company, 11 Knightswick Road, Canvey Island SS8 9PA

Partners: Richard P. Poyntz F.N.A.E.A., James R. Poyntz M.N.A.E.A., Anna L. Poyntz & Sara Poyntz • V.A.T No: 731 4287 45  
Richard Poyntz & Co (Partnership) is an introducer appointed representative of Stonebridge Mortgage Solutions Ltd for mortgage and insurance introductions.  
Stonebridge Mortgage Solutions Ltd is authorised and regulated by the Financial Conduct Authority.

