



3 Weel Road



3 Weel Road Canvey Island SS8 7NN

Asking Price £315,000



Being offered for Sale with NO ONWARD CHAIN is this spacious Two Bedroom Semi Detached Bungalow ideally positioned with a Recreational Park and the Seafront located directly at the end of the Road. The property features include an entrance porch connecting to a superb-sized lounge 17'9 x 14'7, a modern kitchen with fitted white gloss units and a Lean-to/Reception Room off, the loft room is accessed via the inner hall and completing the accommodation is a three-piece family bathroom. Externally the property benefits from a patio to the side and rear gardens with a garage/workshop to the side and a separate carport. Viewing comes strongly advised.



Porch

The property is approached via a UPVC half double glazed lead entrance door leading to the entrance porch, good sized entrance porch with double-glazed lead windows to the front, power points, further part glazed door leading to the lounge.

Lounge

17'9 x 14'7 (5.41m x 4.45m)
Superb sized room with UPVC double-glazed lead windows to the front further UPVC double-glazed windows to either side, two radiators, tv and power points, opening to inner hall

Inner Hall

Radiator, loft hatch and ladder providing access to the loft room and further doors leading to accommodation.

Kitchen

15'10 x 9'9 maximum (4.83m x 2.97m maximum)
UPVC double-glazed lead window to the rear and side elevations, door providing access to the Lean-to/Reception Room with one-and-a-quarter stainless steel single drainer sink to a range of rolled edge worksurfaces with white gloss finished units at base and eye level, space for range style cooker with fitted stainless steel extractor canopy over, plumbing and

space for washing machine, housing for large fridge freezer with surrounding white gloss cupboards, radiator, power points.

Lean-to/Reception Room

13'6 x 7'7 (4.11m x 2.31m)

A handy room with double-glazed windows to the rear and the side with two doors providing access and a further door providing access to the garage/workshop.

Bedroom One

11'4 x 10' (3.45m x 3.05m)

UPVC double glazed lead window to the rear, radiator, laminate wood flooring, range of fitted wardrobes to one wall, further cupboard housing wall mounted boiler.

Bedroom Two

10'9 x 7'9 (3.28m x 2.36m)

UPVC double glazed lead window to the front, radiator, laminate flooring, range of fitted wardrobes to one wall.

Bathroom

Obscure double-glazed lead window to the rear, suite comprising of pedestal wash hand basin, low-level wc, panelled bath, radiator, ceramic tiling to the walls.

Loft Room

19'2 x 9'5 maximum (5.84m x 2.87m maximum)

Accessed via a loft ladder from the inner hall 19'2 x 9'5 maximum, double glazed window to the front, radiator.

Exterior

Rear Garden

To the rear of the property extends a paved patio area to the rear and the side of the garden with established shrubbery borders, an external tap, a storage shed, gate providing access to the car port.

Garage/Workshop

15'4 x 8'2 (4.67m x 2.49m)

Originally a garage but currently utilised as a workshop with power and light connected.

Carport

Located to the side of the garage/workshop providing additional off street parking.

Front Garden

Paved patio with brick retaining wall.



GROUND FLOOR



1ST FLOOR

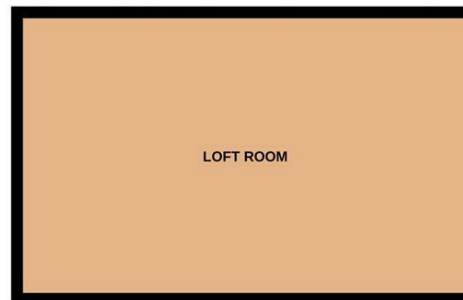

Whilst every attempt has been made to ensure the accuracy of the floorplan contained here, measurements of doors, windows, rooms and any other items are approximate and no responsibility is taken for any error, omission or mis-statement. This plan is for illustrative purposes only and should be used as such by any prospective purchaser. The services, systems and appliances shown have not been tested and no guarantee as to their operability or efficiency can be given.
Made with Metropix ©2024

Misrepresentation Act 1967: These details are prepared as a general guide only, and should not be relied upon as a basis to enter a legal contract or commit expenditure. And any interested party should rely solely on their own Surveyor, Solicitor/Conveyancer or other professionals before committing themselves to any expenditure or other legal commitments. If any interested party wishes to rely upon any information from the Agent, then a request should be made and specific written confirmation can be provided. The Agent will not be responsible for any verbal statement made by the Agent or any member of Staff, as only a specific written confirmation can be provided. The Agent will not be responsible for any loss other than what specific written confirmation has been requested.

Property Misdescription Act 1991 The Agent has not tested any apparatus, equipment, fixture, fittings or services and so does not verify they are in working order, fit for purpose, or within ownership of the sellers, therefore the buyer must assume the information is incorrect. Neither has the Agent checked the legal documentation to verify legal status of the property. A buyer must assume the information is incorrect until it has been verified by their own Solicitors/Conveyancers. Nothing concerning the type of construction or the condition of the structure is to be implied from the photograph or plans for the property. Photographs of the interior of the property are given purely to give an indication of décor/style etc. and does not imply that any furniture/fittings etc., are included. A fixtures & fittings list will be provided by the Solicitors/Conveyancers in due course. The sales particulars may change in the course of time and any interested party is advised to make a final inspection of the property prior to exchange of contracts



Tel No: 01268 699 599 | Fax: 01268 699 080 | Email: rp@richardpoyntz.com
Registered Office: Richard Poyntz & Company, 11 Knightswick Road, Canvey Island SS8 9PA

Partners: Richard P. Poyntz F.N.A.E.A., James R. Poyntz M.N.A.E.A., Anna L. Poyntz & Sara Poyntz • V.A.T No: 731 4287 45
Richard Poyntz & Co (Partnership) is an introducer appointed representative of Stonebridge Mortgage Solutions Ltd for mortgage and insurance introductions.
Stonebridge Mortgage Solutions Ltd is authorised and regulated by the Financial Conduct Authority.

