



HUNTERS[®]
HERE TO GET *you* THERE

Lower Clapton Road, London, E5

Lower Clapton Road, London, E5

Asking Price: £300,000

Offered to the market in stunning condition is this superbly located, one double bedroom apartment converted from the first floor of an imposing period property. The apartment offers a spacious east facing, open plan reception room with a modern integrated kitchen and space for dining as well as a contemporary bathroom and a double bedroom.

The property is located close to Mare Street, London Fields and Hackney Downs and offers quick access to pubs, restaurants, bars, and shops. Nearby transport links include Hackney Central, Hackney Downs and Homerton Overground providing quick access to The City and Central London.

The Owner Says; "I've loved living in my flat for the past few years. It's great to have a quiet flat in a vibrant area which oozes culture. The living room has a high ceiling and beautiful big windows which provide amazing natural light and great people watching. Perfect for a cosy London day.

It's close to Chatsworth Road, which has a vibing Sunday market, and a wide range of quality bars, pubs, cafes & restaurants in walking distance. There's lots of independent retailers, delis and parks nearby, which is perfect for weekend strolls. In summer I usually walk to London Fields or Hackney Downs and in winter I head to a cosy pub like A Slice of Blue which is an awesome little jazz bar 30 seconds walk from my place."

Hunters 185 Stoke Newington Church Street, London, N16 0UL | 020 7249 7499
stokenewington@hunters.com | www.hunters.com

VAT Reg. No 877 0265 03 | Registered No: 05647798 England & Wales | Registered Office: 61 Queen Anne's Grove, Enfield, Middlesex. EN1 2JU
A Hunters Franchise owned and operated licence by Negsa Group Limited



1ST FLOOR
339 sq.ft. (31.5 sq.m.) approx.

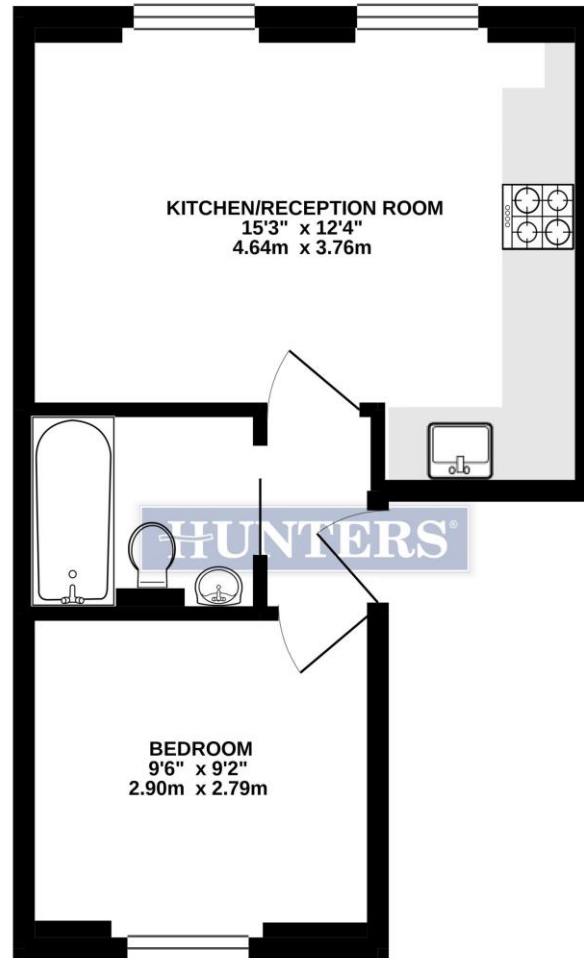

TOTAL FLOOR AREA : 339 sq.ft. (31.5 sq.m.) approx.

Whilst every attempt has been made to ensure the accuracy of the floorplan contained here, measurements of doors, windows, rooms and any other items are approximate and no responsibility is taken for any error, omission or mis-statement. This plan is for illustrative purposes only and should be used as such by any prospective purchaser. The services, systems and appliances shown have not been tested and no guarantee as to their operability or efficiency can be given.
Made with Metropix ©2021.





