

DAVID CHARLES

ESTATE AGENTS • VALUERS • SURVEYORS
THE ESTATE OFFICE • 34 HIGH STREET • PINNER • MIDDLESEX HA5 5PW
TELEPHONE 020 8866 0222 • FAX 020 8868 3544
WEBSITE www.david-charles.co.uk • E-MAIL pinner-sales@david-charles.co.uk

RICKMANSWORTH ROAD, PINNER, MIDDLESEX, HA5 3TE



PRICE....£599,950....FREEHOLD

This three bedroom end of terrace house (1227 sq. ft/114 sq. m) benefits from a double reception room with wood flooring and an extended kitchen.

The first floor has two double bedrooms with fitted wardrobes, a 10' bedroom three and a contemporary shower room with fully tiled walls and flooring. Outside there is a 35' secluded rear garden with a bright south westerly aspect, a paved patio and main lawn. The front has off street parking leading to a garage which recently had planning permission to convert into additional living accommodation. The property is ideally located within minutes' walk of Tesco supermarket and local shops and three quarters of a mile from Pinner town centre. Offered with no upper chain.

020 8866 0222









COUNCIL TAX

London Borough of Harrow - Band E - £2,794.40

LOCAL SCHOOLS

Pinner Wood School - 0.28 Miles
Harlyn Primary School - 0.29 Miles
Northwood School - 0.42 Miles
Haydon School - 0.75 Miles

LOCAL TRANSPORT

Northwood Hills Station (Metropolitan Line) - 0.7 Miles
Pinner Station (Metropolitan Line) - 0.9 Miles

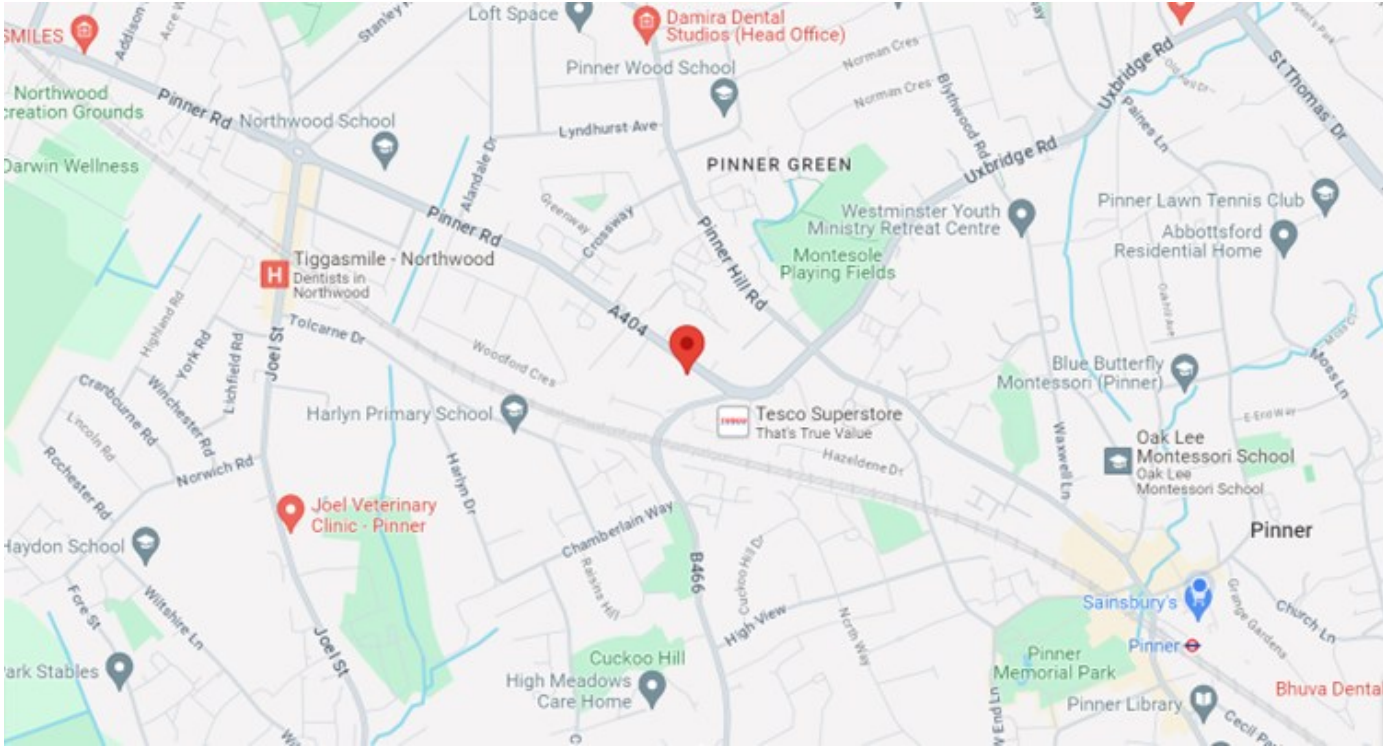

Score	Energy rating	Current	Potential
92+	A		
81-91	B		85 B
69-80	C		
55-68	D	67 D	
39-54	E		
21-38	F		
1-20	G		

Rickmansworth Road

Approximate Gross Internal Area
114.0 sq m / 1,227 sq ft

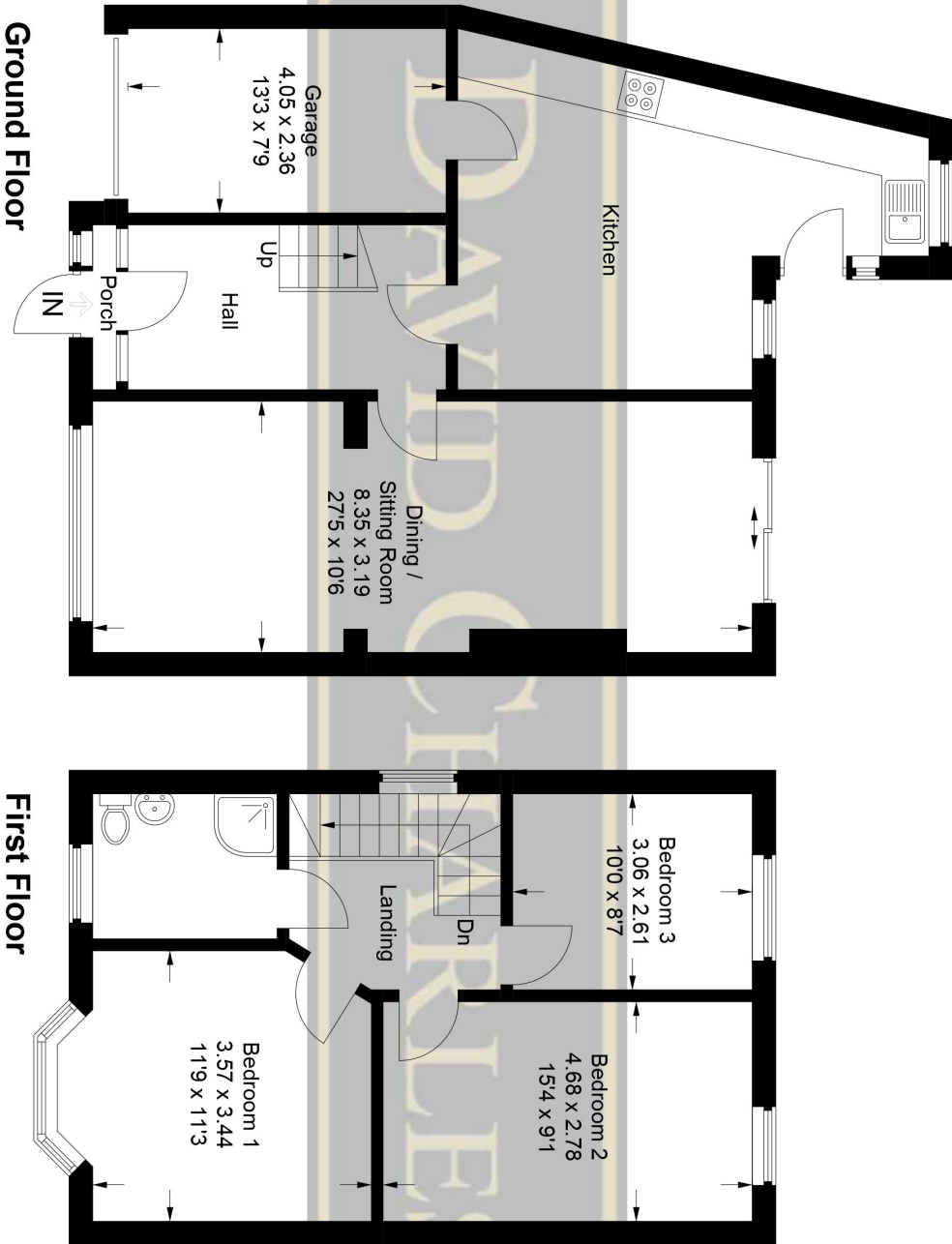

Ground Floor

First Floor

This plan is for layout guidance only. Not drawn to scale unless stated. Windows and door openings are approximate. Whilst every care is taken in the preparation of this plan, please check all dimensions, shapes and compass bearings before making any decisions reliant upon them.

© CJ Property Marketing Ltd Produced for David Charles

For appointments to view please call David Charles 020 8866 0222

All measurements are taken manually and whilst every care is taken with their accuracy they must be considered approximate and should not be relied upon when purchasing carpets or furniture. No responsibility is taken for any error, omission or misunderstanding in these particulars which do not constitute an offer or contract. Services and appliances have not been tested and therefore no warranty is offered on their operational condition.