



This charming 3-bedroom terraced house in a highly sought-after location offers a perfect blend of comfort and style, featuring spacious living areas, a well-appointed kitchen, parking, a garage, and proximity to local amenities and schools, making it an ideal family home.



MARTIN&CO

Newlay Wood Close, Horsforth, LS18 4SL

£350,000

For sale is this charming 3-bedroom terraced house, neutrally decorated, and nestled in a highly sought-after location. This property has been thoughtfully designed to offer a perfect blend of comfort and style, delivering an exceptional living space that will cater perfectly to families.





Terraced

3

2

1

Garage / Off road
Band - D

EPC
D

Freehold

1,137 sqft



On entering the house, you are greeted by a spacious reception room, beautifully lit with ample natural light. This room is perfect for both relaxation and entertaining, offering a warm and inviting space for guests and family.

The house boasts a well-appointed kitchen that offers plenty of space for all your culinary needs. The kitchen's design and layout make it a practical and enjoyable place to prepare meals.

Three generously sized bedrooms provide ample room for growing families or guests. Each bedroom has been tastefully decorated, providing a serene retreat after a long day. The property also hosts two well-maintained bathrooms, further adding to the convenience and comfort of this delightful home.

One of the property's unique features includes parking, and a single garage, offering additional storage or parking space.

The property is set in a desirable location, with an array of local amenities nearby. It is surrounded by green spaces and walking routes, ideal for those who appreciate outdoor activities. Also, with schools in proximity, this house is certainly a perfect choice for families.

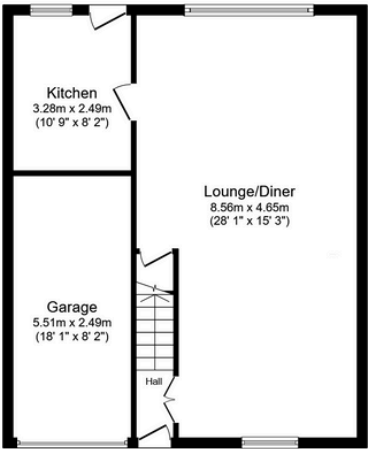

Ground Floor
Floor area 64.3 m² (692 sq.ft.)

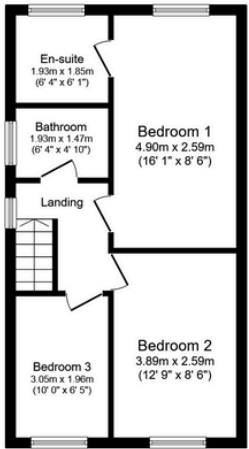

First Floor
Floor area 41.3 m² (445 sq.ft.)

TOTAL: 105.6 m² (1,137 sq.ft.)

This floor plan is for illustrative purposes only. It is not drawn to scale. Any measurements, floor areas (including any total floor area), openings and orientations are approximate. No details are guaranteed, they cannot be relied upon for any purpose and do not form any part of any agreement. No liability is