



Teddesley Way | Huntington, Cannock | WS12 4UX

Offers In The Region Of £240,000



Summary

**** WOW ** THIS HOME REALLY MUST BE VIEWED ** SOUGHT AFTER LOCATION ** CLOSE TO CANNOCK CHASE ** SHOWHOME STANDARD THROUGHOUT ** TWO DOUBLE BEDROOMS ** REFITTED SHOWER ROOM ** KITCHEN DINER ** GENEROUS LOUNGE DINER ** CONSERVATORY ** EXTENDED GARAGE WITH UTILITY AREA ** LANDSCAPED GARDENS ** PRIVATE DRIVEWAY ****

WEBBS ESTATE AGENTS are excited to present this very well presented two-bedroom end terraced town house on Teddesley Way offers a fantastic opportunity for buyers seeking a comfortable, stylish home with generous outdoor space and excellent local convenience. Teddesley Way is ideally located close to a range of local amenities, including shops, schools, and leisure facilities. For nature lovers and outdoor enthusiasts, Cannock Chase Area of Outstanding Natural Beauty is just a short distance away. The area also benefits from excellent transport links, with easy access to major road networks and public transport, making it ideal for commuters. Briefly comprising: Entrance, Kitchen, Spacious Lounge, Conservatory, Two Bedrooms, Family Bathroom, Landscaped Rear Garden, Large Garage with utility, Private Driveway For Three Vehicles.

Key Features

- WELL PRESENTED TOWN HOUSE
- BEAUTIFULLY LANDSCAPED REAR GARDEN
- KITCHEN
- CLOSE TO CANNOCK CHASE
- PLENTY OF PARKING
- TWO BEDROOMS
- LOUNGE
- CONSERVATORY
- LARGE GARAGE
- VIEWING ESSENTIAL

Rooms and Dimensions

ENTRANCE

KITCHEN DINER

11'4" x 9'1" (3.47m x 2.78m)

SPACIOUS LOUNGE DINER

16'1" x 11'4" (4.92m x 3.46m)

CONSERVATORY

10'1" x 9'0" (3.09m x 2.75m)

LANDING

BEDROOM ONE

11'3" x 9'2" (3.44m x 2.81m)

BEDROOM TWO

11'2" x 7'2" (3.42m x 2.20m)

REFITTED SHOWER ROOM

EXTENDED GARAGE WITH UTILITY

21'11" x 15'10" (6.69m x 4.83m)

LANDSCAPED GARDENS

PRIVATE DRIVEWAY

Identification Checks (R)





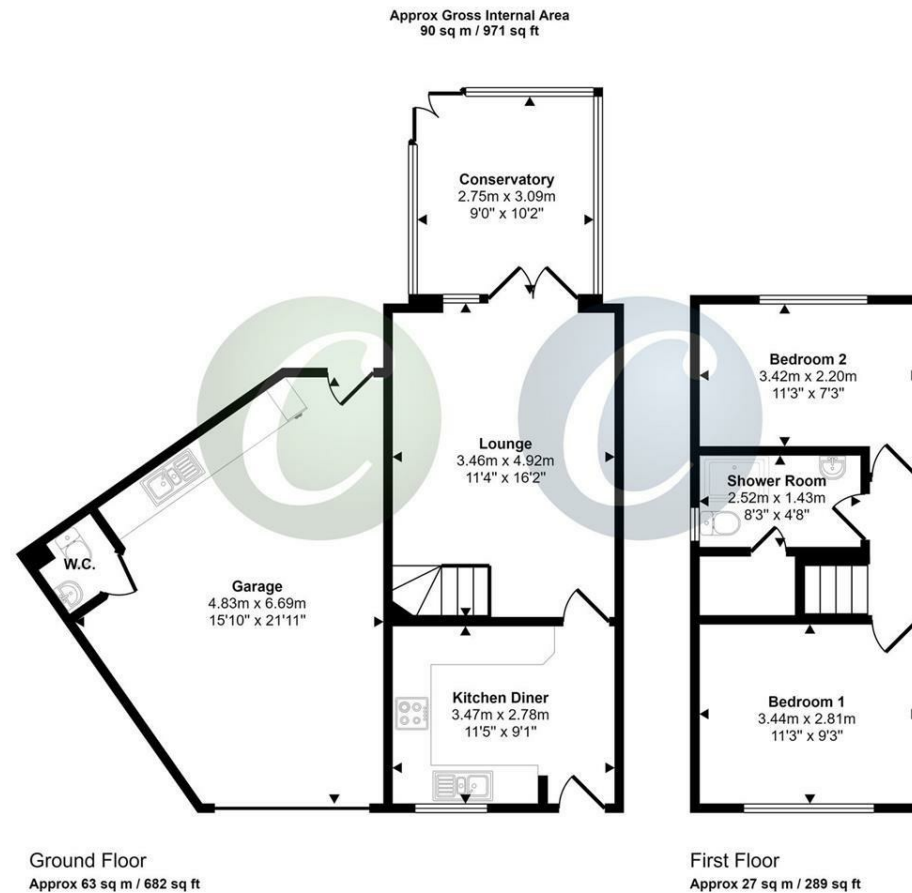

This floorplan is only for illustrative purposes and is not to scale. Measurements of rooms, doors, windows, and any items are approximate and no responsibility is taken for any error, omission or mis-statement. Icons of items such as bathroom suites are representations only and may not look like the real items. Made with Made Snappy 360.

Webbs Estate Agents - endeavour to maintain accurate depictions of properties in Virtual Tours, Floor Plans and descriptions, however, these are intended only as a guide and purchasers must satisfy themselves by personal inspection.

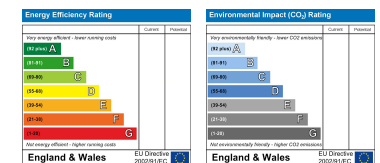

Globe House Upper Brook Street, Rugeley, Staffordshire, WS15 2DN

Tel: 01889 583377 | Email: rugeley@webbsea.co.uk | www.webbestateagents.co.uk