

# Richardson Way, Rugeley, WS15 2TD

£335,000

🛏️ 4 🚗 2 🛋️ 2



**\*\*ONLINE VIRTUAL TOUR AVAILABLE ON THIS PROPERTY - why not take a peek before booking a viewing\*\***

## Key Features

- FOUR BEDROOM DETACHED FAMILY HOME
- LOUNGE
- KITCHEN DINER
- CONSERVATORY
- BEDROOM ONE WITH ENSUITE
- DOWNSTAIRS CLOAKROOM
- REAR GARDEN
- DRIVEWAY
- SINGLE GARAGE
- VIEWING ESSENTIAL

Approx Gross Internal Area  
133 sq m / 1431 sq ft

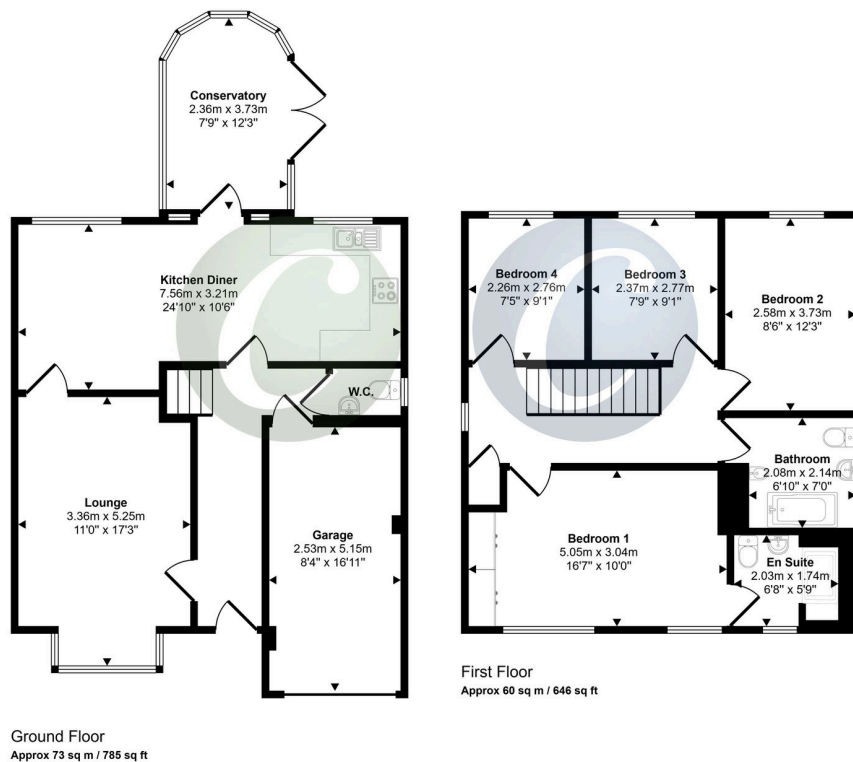

This floorplan is only for illustrative purposes and is not to scale. Measurements of rooms, doors, windows, and any items are approximate and no responsibility is taken for any error, omission or mis-statement. Icons of items such as bathroom suites are representations only and may not look like the real items. Made with Made Snappy 360.