



Alandale Avenue, Rugeley, WS15 4EL

£290,000

 3
  2
  2



- NO UPWARD CHAIN
- EXTENDED THREE BEDROOM END TERRACE
- UTILITY ROOM
- THREE GOOD SIZE BEDROOMS
- LARGE GARDEN
- IMMACULATELY PRESENTED THROUGHOUT
- LARGE KITCHEN/ FAMILY ROOM
- DOWNSTAIRS SHOWER ROOM
- FAMILY BATHROOM
- POPULAR VILLAGE LOCATION

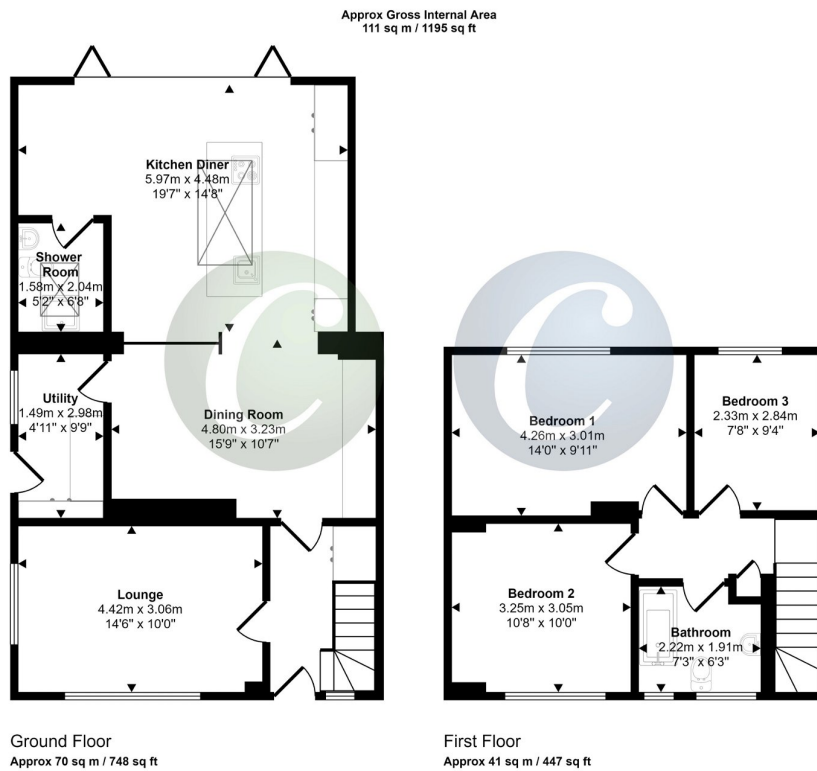

This floorplan is only for illustrative purposes and is not to scale. Measurements of rooms, doors, windows, and any items are approximate and no responsibility is taken for any error, omission or mis-statement. Icons of items such as bathroom suites are representations only and may not look like the real items. Made with Made Snappy 360.

**** ONLINE VIRTUAL TOUR AVAILABLE ON THIS PROPERTY - why not take a peek before booking a viewing****