



# Sheringham Drive, Rugeley, WS15 2YG

£260,000

 3  1  2



**\*\* ONLINE VIRTUAL TOUR AVAILABLE ON THIS PROPERTY - why not take a peek before booking a viewing\*\***

## Key Features

- POPULAR LOCATION
- LOUNGE DINING ROOM
- KITCHEN
- DRIVEWAY
- VIEWING ADVISED
- THREE BEDROOMS
- CONSERVATORY
- LARGE GARAGE
- CLOSE TO CANNOCK CHASE

Approx Gross Internal Area  
98 sq m / 1056 sq ft

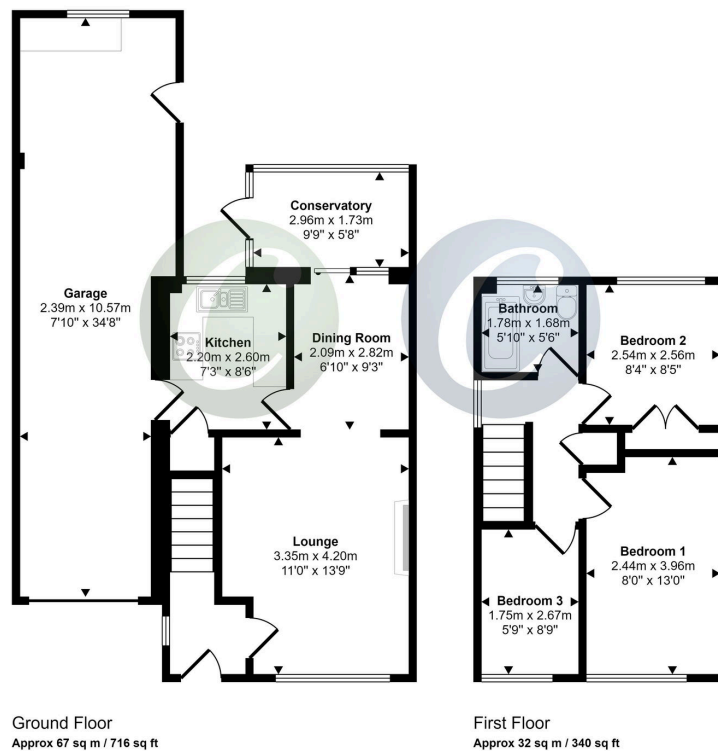

This floorplan is only for illustrative purposes and is not to scale. Measurements of rooms, doors, windows, and any items are approximate and no responsibility is taken for any error, omission or mis-statement. Icons of items such as bathroom suites are representations only and may not look like the real items. Made with Made Snappy 360.