

Kingsland Close, Rugeley, WS15 2GZ

Offers Over £250,000

3  1  1



- BEAUTIFULLY PRESENTED THROUGHOUT
- THREE BEDROOMS
- KITCHEN
- GOOD SIZE GARDEN
- VIEWING ESSENTIAL
- POPULAR LOCATION
- LOUNGE
- DOWNSTAIRS CLOAKROOM
- OFF ROAD PARKING

Approx Gross Internal Area
79 sq m / 851 sq ft

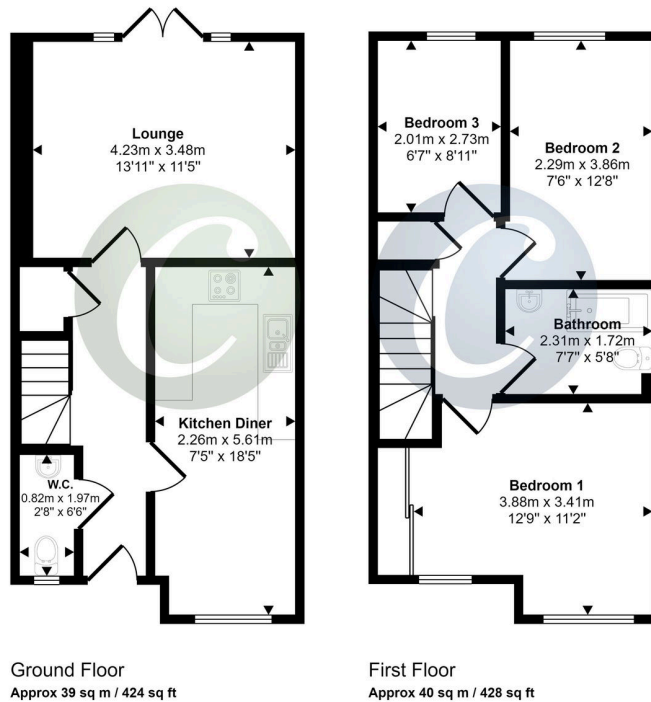

This floorplan is only for illustrative purposes and is not to scale. Measurements of rooms, doors, windows, and any items are approximate and no responsibility is taken for any error, omission or mis-statement. Icons of items such as bathroom suites are representations only and may not look like the real items. Made with Made Snappy 360.

**** ONLINE VIRTUAL TOUR AVAILABLE ON THIS PROPERTY - why not take a peek before booking a viewing****