

Arch Street, Brereton, Rugeley, WS15 1DL

£130,000

🛏️ 2 🚿 1 🚻 1



**** ONLINE VIRTUAL TOUR AVAILABLE ON THIS PROPERTY - why not take a peek before booking a viewing****

Key Features

- NO UPWARD CHAIN
- TWO BEDROOMS
- TWO RECEPTION ROOMS
- COURTYARD GARDEN
- IN NEED OF UPGRADE
- TOWN CENTRE LOCATION
- DOWNSTAIRS BATHROOM
- VIEWING ESSENTIAL

Approx Gross Internal Area
68 sq m / 737 sq ft

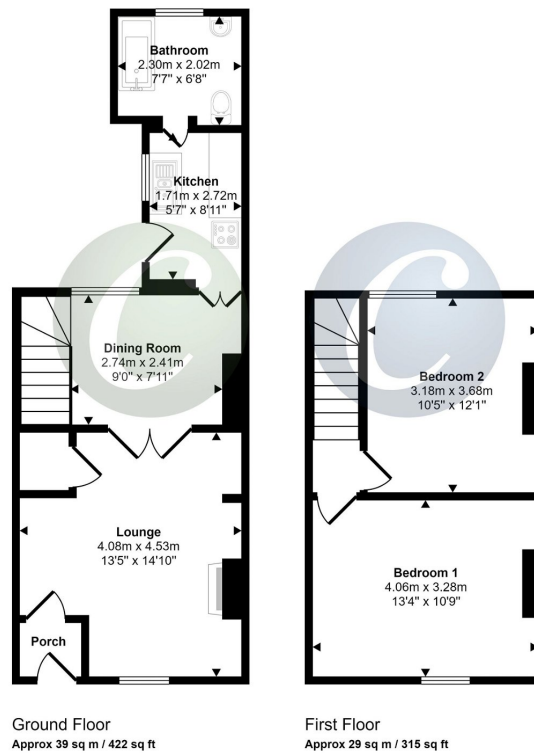

This floorplan is only for illustrative purposes and is not to scale. Measurements of rooms, doors, windows, and any items are approximate and no responsibility is taken for any error, omission or mis-statement. Icons of items such as bathroom suites are representations only and may not look like the real items. Made with Made Snappy 360.