



Connells

Fraser Road
Tamerton Foliot Plymouth



Property Description

Located in the tranquil neighbourhood of Tamerton Foliot, residents can enjoy a peaceful and picturesque setting while still being within easy reach of all essential amenities. Whether you're looking to invest in a property with strong rental potential or secure a cosy home in a desirable location, this property offers versatility and convenience.

Lounge

14' 1" max x 12' 7" max (4.29m max x 3.84m max)

Spacious and welcoming lounge. Double glazed window to the front elevation. Stairs rising to the first floor with storage beneath. Radiator.

Kitchen

14' 1" x 7' 9" (4.29m x 2.36m)

The kitchen comprises of a range of wall and base units with worktops above. Stainless steel sink with mixer tap. Integrated oven and counter top hob. Space for a freestanding fridge freezer. Space and plumbing for a washing machine. Wall mounted Worcester boiler. Double glazed window to the rear elevation. uPVC door to the garden. Radiator. Space for a table and chairs.

Cloakroom

Low level w.c. and a pedestal sink. Radiator.

Upstairs Landing

Bedroom 1

14' 1" x 7' 9" (4.29m x 2.36m)

Two double glazed windows to the rear elevation. Radiator.

Bedroom 2

14' 1" max x 7' 9" max (4.29m max x 2.36m max)

Two double glazed windows to the front elevation. Built in storage cupboard. Radiator.

Bathroom

Bath with shower above, low level w.c. and pedestal sink.

Outside

The rear garden is fully enclosed. There is a seating area with the rest laid to lawn. Communal parking is available at the front of the property.







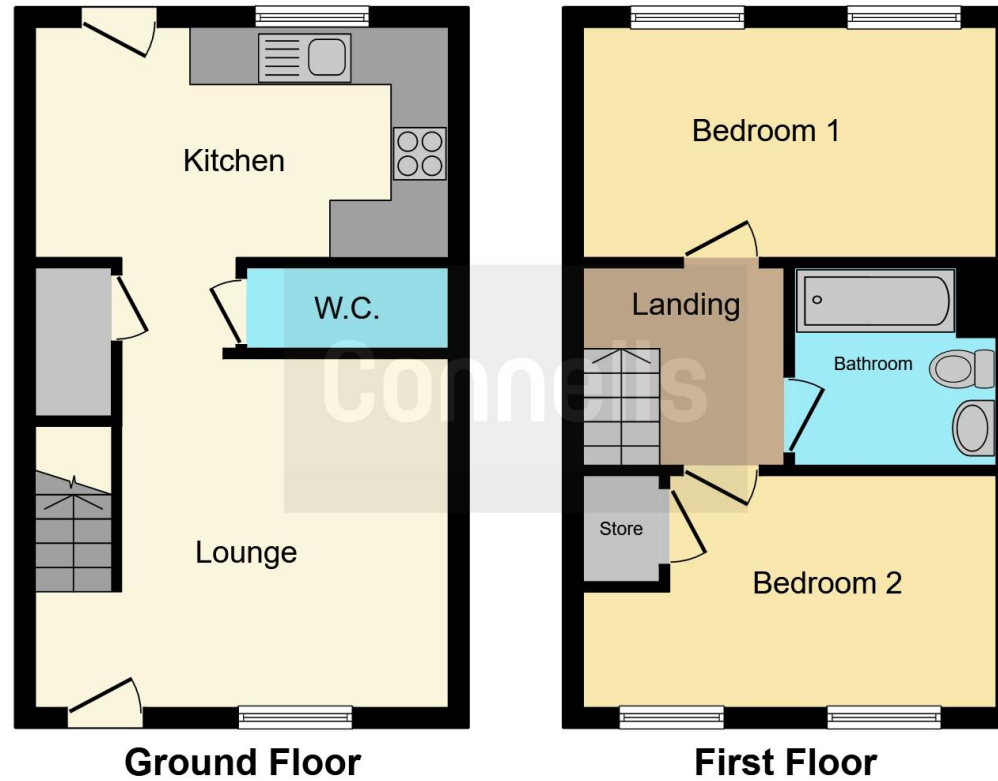

This floor plan is for illustrative purposes only. It is not drawn to scale. Any measurements, floor areas (including any total floor area), openings and orientation are approximate. No details are guaranteed, they cannot be relied upon for any purpose and they do not form part of any agreement. No liability is taken for any error, omission or misstatement. A party must rely upon its own inspection(s). Powered by www.focalagent.com

To view this property please contact Connells on

T 01752 351616
E stbudeaux@connells.co.uk

15 Victoria Road St Budeaux
 PLYMOUTH PL5 1RW

EPC Rating: B

view this property online connells.co.uk/Property/SBU108260

Tenure: Freehold



1. MONEY LAUNDERING REGULATIONS Intending purchasers will be asked to produce identification documentation at a later stage and we would ask for your co-operation in order that there will be no delay in agreeing the sale. 2. These particulars do not constitute part or all of an offer or contract. 3. The measurements indicated are supplied for guidance only and as such must be considered incorrect. Potential buyers are advised to recheck measurements before committing to any expense. 4. We have not tested any apparatus, equipment, fixtures, fittings or services and it is in the buyers interest to check the working condition of any appliances.

Connells Residential is registered in England and Wales under company number 1489613, Registered Office is Cumbria House, 16-20 Hockliffe Street, Leighton Buzzard, Bedfordshire, LU7 1GN. VAT Registration Number is 500 2481 05.

See all our properties at www.connells.co.uk | www.rightmove.co.uk | www.zoopla.co.uk

Property Ref: SBU108260 - 0003