



Luscombe Maye  
Since 1873



# Greenacres, Plymstock

Guide Price £295,000

3 1 2





- Extended detached family home
- Open plan kitchen/dining family room
- Enclosed private garden
- Elevated position
- Three bedrooms
- Separate lounge
- Garage
- Excellent location for schools and amenities



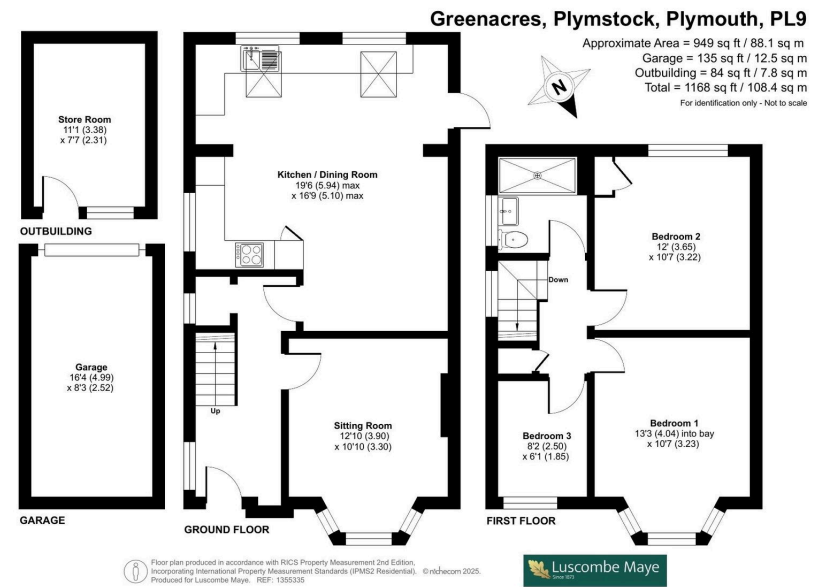

Beautifully presented and thoughtfully designed, this three-bedroom detached home offers generous living space ideal for family life. Nestled in a sought-after residential neighbourhood, it enjoys close proximity to excellent schools, scenic parks, convenient shops, and reliable transport links

