

# Hillbrow, Richmond Hill TW10

---



# Hillbrow, Richmond Hill, Richmond **TW10**

This well presented and generously proportioned apartment is situated on the ground floor of this much acclaimed and well located purpose built apartment block at the summit of Richmond Hill.

The decor is tasteful, with neutral tones further emphasising the excellent room proportions and superb flow of natural light. Other features of particular note include the stunning double reception room, a fabulous large entrance hallway and secure unallocated parking for the residents, that operates on a first come first served basis.



**Guide price:** £950,000

**Tenure:** Share of freehold plus leasehold, approximately 89 years remaining

**Service charge:** £4,855.74 per annum, reviewed every year, next review due 2025

**Ground rent:** Peppercorn

**Local authority:** London Borough of Richmond Upon Thames

**Council tax band:** F





## Location

Hillbrow occupies an enviable position within just a hundred metres of the shops at 'Richmond Hill Village', that cater superbly for day to day requirements and provide a charming village atmosphere.

Whilst slightly further afield Richmond town offers a wonderful and sophisticated array of shops and restaurants, as well as the much acclaimed Richmond Theatre - situated on picturesque and historic Richmond Green.

The stunning Terrace Gardens offer an ideal retreat from the hubbub of daily life and lead down to a particularly scenic stretch of the River Thames. Richmond Park is also within a short and pleasant stroll and has 2,300 acres of deer inhabited woodland.





# Hillbrow , TW10

Approximate Gross Internal Area : 113.8 Sq. metres  
1225 Sq. feet

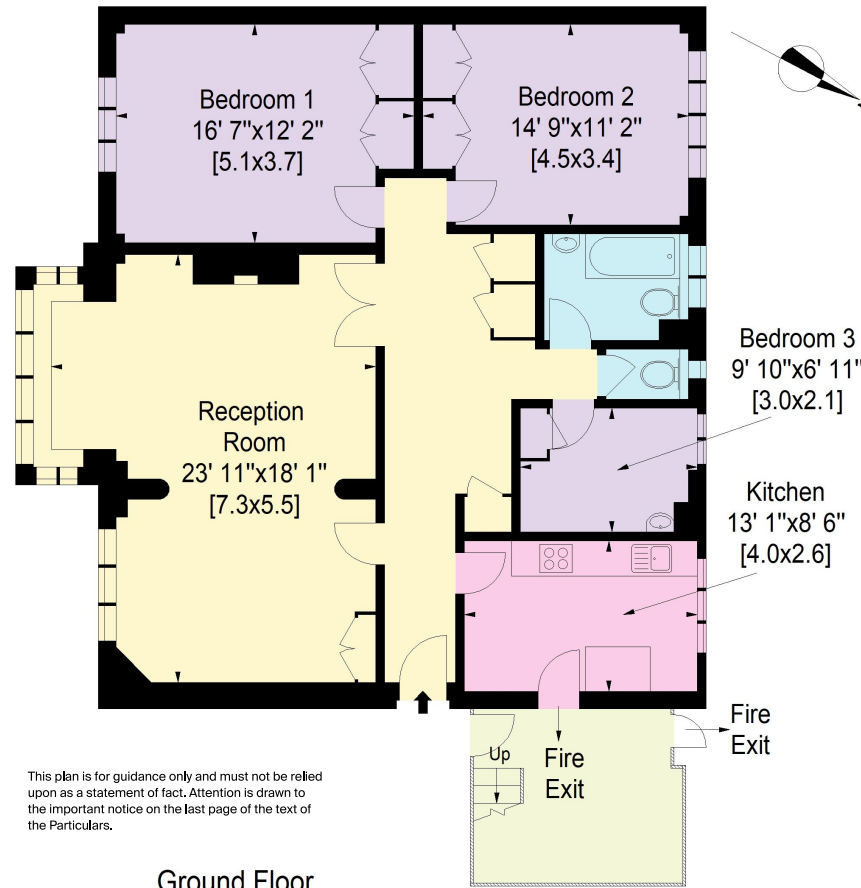

This plan is for guidance only and must not be relied upon as a statement of fact. Attention is drawn to the important notice on the last page of the text of the Particulars.

## Ground Floor

**Knight Frank**  
Richmond  
23 Hill Street,  
London  
TW9 1SX  
[knightfrank.co.uk](https://www.knightfrank.co.uk)

I would be delighted to tell you more  
**Liam Doyle**  
020 8939 2809  
[liam.doyle@knightfrank.com](mailto:liam.doyle@knightfrank.com)



Fixtures and fittings: A list of the fitted carpets, curtains, light fittings and other items fixed to the property which are included in the sale (or may be available by separate negotiation) will be provided by the Seller's Solicitors.

Important Notice: 1. Particulars: These particulars are not an offer or contract, nor part of one. You should not rely on statements by Knight Frank LLP in the particulars or by word of mouth or in writing ("information") as being factually accurate about the property, its condition or its value. Neither Knight Frank LLP nor any joint agent has any authority to make any representations about the property, and accordingly any information given is entirely without responsibility on the part of the agents, seller(s) or lessor(s). 2. Photos, Videos etc: The photographs, property videos and virtual viewings etc. show only certain parts of the property as they appeared at the time they were taken. Areas, measurements and distances given are approximate only. 3. Regulations etc: Any reference to alterations to, or use of, any part of the property does not mean that any necessary planning, building regulations or other consent has been obtained. A buyer or lessee must find out by inspection or in other ways that these matters have been properly dealt with and that all information is correct. 4. VAT: The VAT position relating to the property may change without notice. 5. To find out how we process Personal Data, please refer to our Group Privacy Statement and other notices at <https://www.knightfrank.com/legals/privacy-statement>.

Particulars dated March 2024. Photographs and videos dated March 2024.

Knight Frank is the trading name of Knight Frank LLP. Knight Frank LLP is a limited liability partnership registered in England and Wales with registered number OC305934. Our registered office is at 55 Baker Street, London W1U 8AN where you may look at a list of members' names. If we use the term 'partner' when referring to one of our representatives, that person will either be a member, employee, worker or consultant of Knight Frank LLP and not a partner in a partnership. If you do not want us to contact you further about our services then please contact us by either calling 020 3544 0692, email to [marketing.help@knightfrank.com](mailto:marketing.help@knightfrank.com) or post to our UK Residential Marketing Manager at our registered office (above) providing your name and address.