

The Mount, Esher, Surrey, KT10





A 1930's Detached Character Family Home

A 1930's character family home, set in an elevated position within a wide plot on a quiet cul-de-sac in the picturesque village of West End. The property offers scope to extend or develop (STPP).

West End Village is a unique setting, featuring its own pub, church, village green, and duck pond, along with the renowned Garsons Farm, which offers pick-your-own produce, an extensive farm shop, and a coffee shop. The property is ideally located for Claremont Fan Court School (opposite) and The National Trust-owned Claremont Landscaped Gardens.

Located a short distance from Esher High Street, the area offers an excellent range of restaurants and shops, including Waitrose, Côte, Gail's Bakery, Fego, The Good Earth, and an Everyman Cinema, as well as numerous coffee shops and pubs.

Schooling in the area is superb, with a large selection of private and state schools nearby, including Claremont Fan Court, Shrewsbury House, Rowan, and Esher Church School. ACS Cobham International School, Reed's, and Danes Hill are also conveniently located.

Communication links are excellent, with the nearby station offering a fast and frequent service to London Waterloo. The A3 provides direct access to central London, the M25, and the South.

There is also a wide range of recreational activities, with Sandown Park offering horse racing, skiing, golf, go-karting, a gym, and squash. The historic Hampton Court Palace is a short distance away.

The towns of Kingston upon Thames and Guildford are also nearby, providing a wide selection of high street names and department stores.

Tenure: Freehold

Local Authority: Elmbridge Borough Council

Council Tax Band: G



4



2



3

EPC

E





The Mount, KT10

Approximate Gross Internal Area = 216.2 sq m / 2327 sq ft
Garage = 30.2 sq m / 325 sq ft
Total = 246.4 sq m / 2652 sq ft

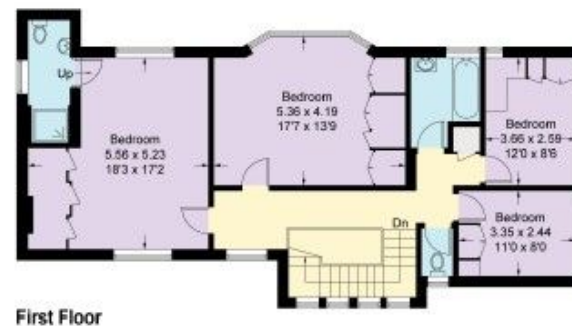

Knight Frank

47 High Street
Esher
Surrey KT10 9RL
[knightfrank.co.uk](https://www.knightfrank.co.uk)

We would be delighted to tell you more

Adam Burlison
01372 239 984
adam.burlison@knightfrank.com

Maisie Bywater
01372 230466
maisie.bywater@knightfrank.com

Measured in accordance with RICS Code of Measuring Practice. To be used for identification and guidance purposes only.
Whilst every care is taken in the preparation of this plan, please check all dimensions, shapes and compass bearings before making any decisions reliant upon them.
www.london58.com © 2025 hello@london58.com



Fixtures and fittings: A list of the fitted carpets, curtains, light fittings and other items fixed to the property which are included in the sale (or may be available by separate negotiation) will be provided by the Seller's Solicitors.

Important Notice: 1. Particulars: These particulars are not an offer or contract, nor part of one. You should not rely on statements by Knight Frank LLP in the particulars or by word of mouth or in writing ("information") as being factually accurate about the property, its condition or its value. Neither Knight Frank LLP nor any joint agent has any authority to make any representations about the property, and accordingly any information given is entirely without responsibility on the part of the agents, seller(s) or lessor(s). 2. Photos, Videos etc: The photographs, property videos and virtual viewings etc. show only certain parts of the property as they appeared at the time they were taken. Areas, measurements and distances given are approximate only. 3. Regulations etc: Any reference to alterations to, or use of, any part of the property does not mean that any necessary planning, building regulations or other consent has been obtained. A buyer or lessee must find out by inspection or in other ways that these matters have been properly dealt with and that all information is correct. 4. VAT: The VAT position relating to the property may change without notice. 5. To find out how we process Personal Data, please refer to our Group Privacy Statement and other notices at <https://www.knightfrank.com/legals/privacy-statement>. Particulars dated February 2023. Photographs and videos dated External - May 2023/February 2025 and Internal - February 2025.

Knight Frank is the trading name of Knight Frank LLP. Knight Frank LLP is a limited liability partnership registered in England and Wales with registered number OC305934. Our registered office is at 55 Baker Street, London W1U 8AN where you may look at a list of members' names. If we use the term 'partner' when referring to one of our representatives, that person will either be a member, employee, worker or consultant of Knight Frank LLP and not a partner in a partnership. If you do not want us to contact you further about our services then please contact us by either calling 020 3544 0692, email to marketing.help@knightfrank.com or post to our UK Residential Marketing Manager at our registered office (above) providing your name and address.