



33 Century Court, Montpellier Grove, Cheltenham



A fantastic two bedroom apartment in the popular Century Court development

Description

33 Century Court boasts a prime location with a balcony overlooking the impressive Cheltenham College. As you enter, you'll find a welcoming reception hall with convenient storage space that opens into the generous living area with access to a balcony. The separate kitchen, accessible from the entrance hall, is well-equipped with floor and wall-mounted units. The apartment includes two spacious bedrooms, one of which is ensuite. The principal bedroom is particularly noteworthy, as it also has a walk-in wardrobe providing ample storage. Additional amenities include a separate cloakroom and internal storage with utility space in the hallway, rounding out the accommodation. There are beautifully landscaped communal gardens, and the apartment benefits from underground parking for one vehicle and gated access for added peace of mind.

Location

Century Court is a popular contemporary development situated between the Suffolk's and Montpellier, both of which are recognised as being Cheltenham's most fashionable districts and benefit from an eclectic mix of shops, restaurants, cafes, wine bars and independent boutiques. The everyday shops and pubs on the Bath Road are equally convenient for essentials. The property is also within a comfortable stroll to two of Cheltenham's famous schools, Cheltenham College and Cheltenham Ladies' College.





Property Information

Local Authority Cheltenham Borough Council 01242 262626

Council Tax Band D

EPC C

Guide Price £525,000



Approximate Gross Internal Floor Area

Total Area: 94.9 sq.m / 1,021 sq.ft

This plan is for guidance only and must not be relied upon as a statement of fact. Attention is drawn to the important notice on the last page of the text of the Particulars.

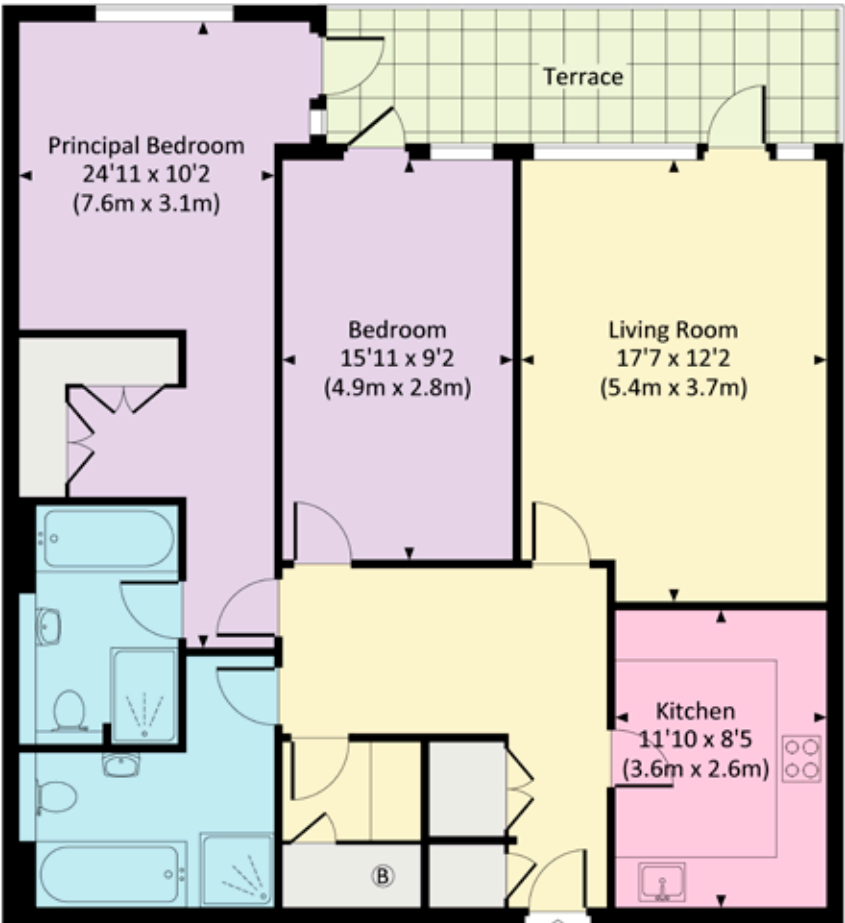

GROUND FLOOR

Knight Frank Cheltenham
123 Promenade, Cheltenham
Gloucestershire
GL50 1NW
[knightfrank.co.uk](https://www.knightfrank.co.uk)

I would be delighted to tell you more

Gemma Hutton
01242 246 958
gemma.hutton@knightfrank.com



Fixtures and fittings: A list of the fitted carpets, curtains, light fittings and other items fixed to the property which are included in the sale (or may be available by separate negotiation) will be provided by the Seller's Solicitors.

Important Notice: 1. Particulars: These particulars are not an offer or contract, nor part of one. You should not rely on statements by Knight Frank LLP in the particulars or by word of mouth or in writing ("information") as being factually accurate about the property, its condition or its value. Neither Knight Frank LLP nor any joint agent has any authority to make any representations about the property, and accordingly any information given is entirely without responsibility on the part of the agents, seller(s) or lessor(s). 2. Photos, Videos etc: The photographs, property videos and virtual viewings etc. show only certain parts of the property as they appeared at the time they were taken. Areas, measurements and distances given are approximate only. 3. Regulations etc: Any reference to alterations to, or use of, any part of the property does not mean that any necessary planning, building regulations or other consent has been obtained. A buyer or lessee must find out by inspection or in other ways that these matters have been properly dealt with and that all information is correct. 4. VAT: The VAT position relating to the property may change without notice. 5. To find out how we process Personal Data, please refer to our Group Privacy Statement and other notices at <https://www.knightfrank.com/legals/privacy-statement>.

Particulars dated January 2025. Photographs and videos dated January 2025.

All information is correct at the time of going to print. Knight Frank is the trading name of Knight Frank LLP. Knight Frank LLP is a limited liability partnership registered in England and Wales with registered number OC305934. Our registered office is at 55 Baker Street, London W1U 8AN. We use the term 'partner' to refer to a member of Knight Frank LLP, or an employee or consultant. A list of members names of Knight Frank LLP may be inspected at our registered office. If you do not want us to contact you further about our services then please contact us by either calling 020 3544 0692, email to marketing.help@knightfrank.com or post to our UK Residential Marketing Manager at our registered office (above) providing your name and address.