

DAWSONS

Property Professionals since 1925

18/20 STAMFORD STREET STALYBRIDGE CHESHIRE TEL: 0161 338 2292

Website: www.wcdawson.com Email: reception@wcdawson.com



Mottram Moor, Mottram, SK14 6LA

Situated in the charming village of Mottram in Longendale, this beautifully refurbished mews house offers a perfect blend of modern living and traditional appeal.

The spacious kitchen/diner is a standout feature, providing an excellent space for both cooking and entertaining. Good size lounge. Downstairs W.C.

The property boasts three well-appointed bathrooms, Master bedroom with en-suite shower. Outside, you will find a delightful rear garden with low maintenance artificial grass. Allocated, off-street parking for 2 vehicles, a rare find in such a desirable location.

Having been refurbished to a high standard, this home combines contemporary finishes with comfort, making it move-in ready. The village of Mottram offers a friendly community atmosphere, with local amenities and scenic countryside nearby, perfect for those who appreciate both convenience and nature.

This exceptional property is not to be missed.

Rent: £1200 pcm + Holding Deposit

Tenancy Term 6 months

Council Tax Band C

Energy Efficiency Rating C

£1,200 Per Calendar Month



**CHARTERED SURVEYORS, ESTATE AGENTS
& PROPERTY MANAGEMENT SPECIALISTS**



Mottram Moor, Mottram, SK14 6LA

- Low maintenance rear garden
- Spacious Kitchen/diner with range cooker
- Three double bedrooms
- Immaculately presented throughout
- Good size lounge
- Master bedroom with En-Suite
- Allocated off road parking
- Downstairs W.C
- VIEWING ESSENTIAL!!



Directions

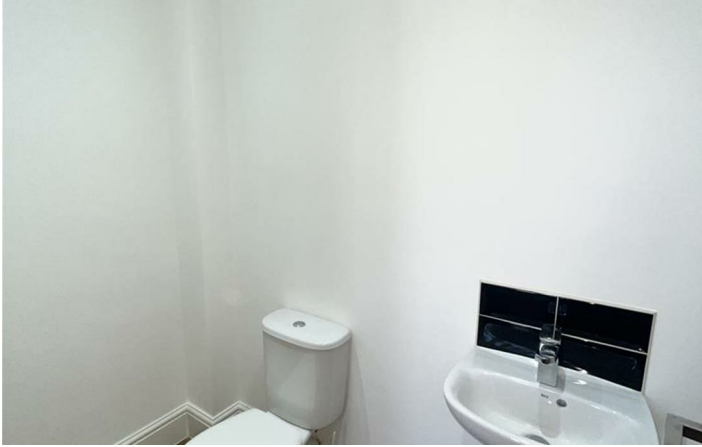

Floor Plan

Ground Floor

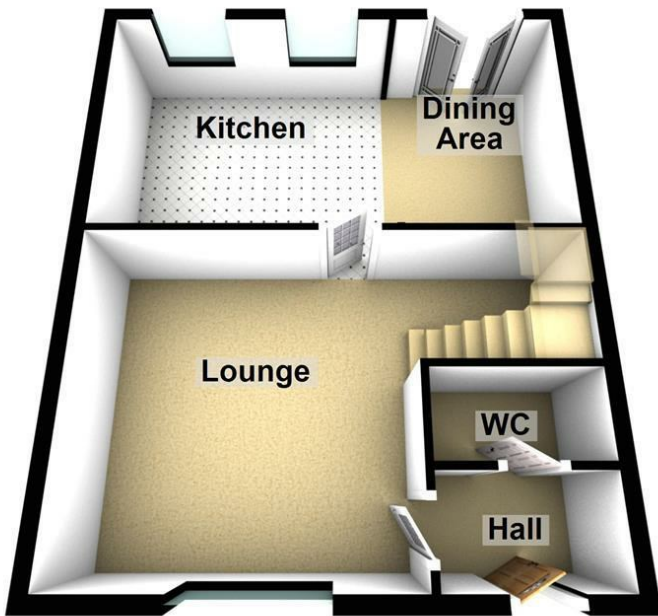

First Floor

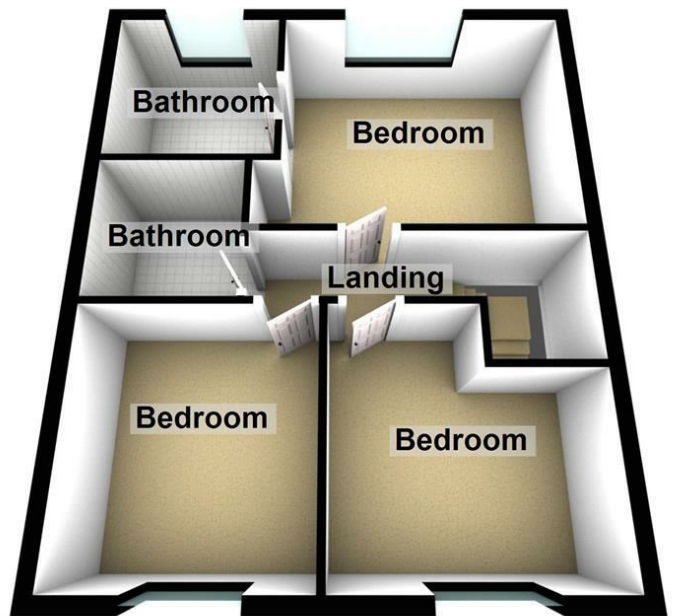

These particulars, whilst believed to be accurate are set out as a general outline only for guidance and do not constitute any part of an offer or contract. Intending purchasers should not rely on them as statements of representation of fact, but must satisfy themselves by inspection or otherwise as to their accuracy. No person in this firm's employment has the authority to make or give any representation or warranty in respect of the property.

