



32 Maunsell Park, Station Hill, Crawley, RH10 7AD

£187,500

A lovely bright studio which has been improved and well looked after and is situated close to Three Bridges mainline station. There is a refitted kitchen and bathroom, new heaters and a large storage cupboard as well as airing cupboard. Outside there is an allocated parking space close to the entrance. NO CHAIN

First Floor

Approx. 35.0 sq. metres (376.5 sq. feet)

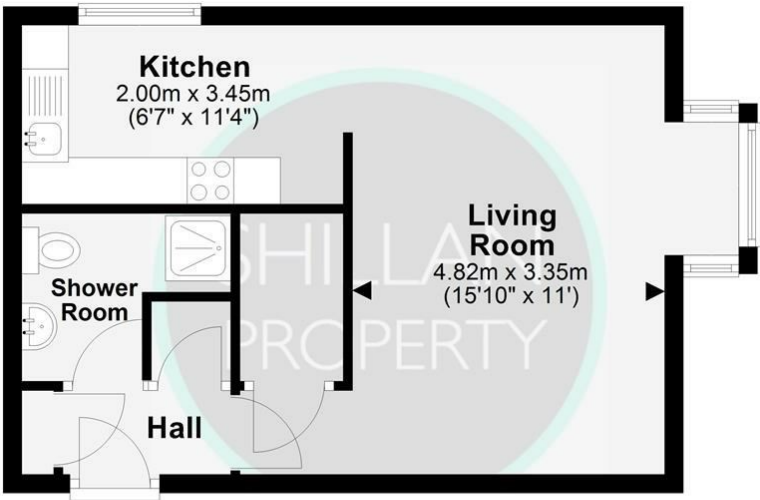

Total area: approx. 35.0 sq. metres (376.5 sq. feet)

These images are for representational purposes only. Drawn by Brian Blunden.
Plan produced using PlanUp.

Area Map

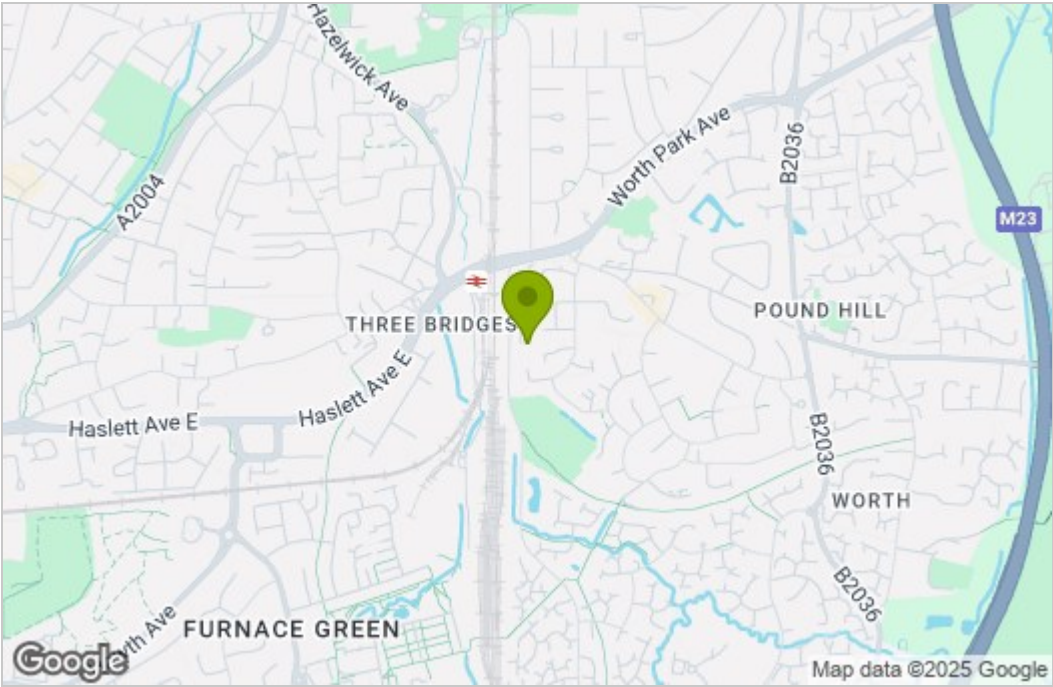

Energy Efficiency Graph

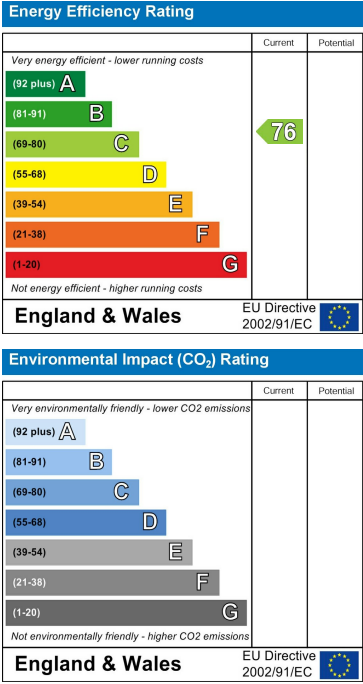

These particulars, whilst believed to be accurate are set out as a general outline only for guidance and do not constitute any part of an offer or contract. Intending purchasers should not rely on them as statements of representation of fact, but must satisfy themselves by inspection or otherwise as to their accuracy. No person in this firms employment has the authority to make or give any representation or warranty in respect of the property.