



12 The Pavillions, Crabbett Park, Crawley, RH10 4SN

Guide price £280,000

Situated in a secluded and attractive gated development this is a must see property. There is generous parking to the front of the building including allocated and visitors spaces. The apartments are situated around a central courtyard space and there is a formal garden to the rear. The property itself benefits from master bedroom with en suite shower room, further bedroom and family bathroom. There is an equipped kitchen and lounge with two windows giving it a light and airy feel. Can be sold with vacant possession or with tenant in situ.

LOUNGE 16'3 x 12'2 (4.95m x 3.71m)

KITCHEN 8' x 7'2 (2.44m x 2.18m)

BEDROOM ONE 11'11 x 11'1 (3.63m x 3.38m)

EN SUITE SHOWER ROOM

BEDROOM TWO 10'10 x 7'1 (3.30m x 2.16m)

BATHROOM

Floor Plan

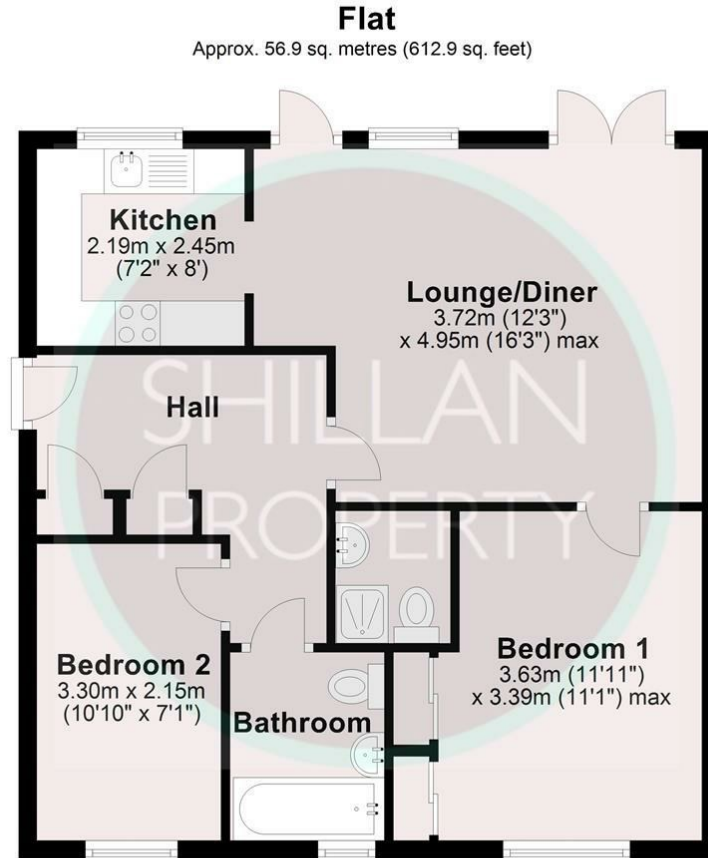

Total area: approx. 56.9 sq. metres (612.9 sq. feet)

These drawings are for representational purposes only. Drawn by Brian Blunden.
Plan produced using PlanUp.

Area Map



Energy Efficiency Graph

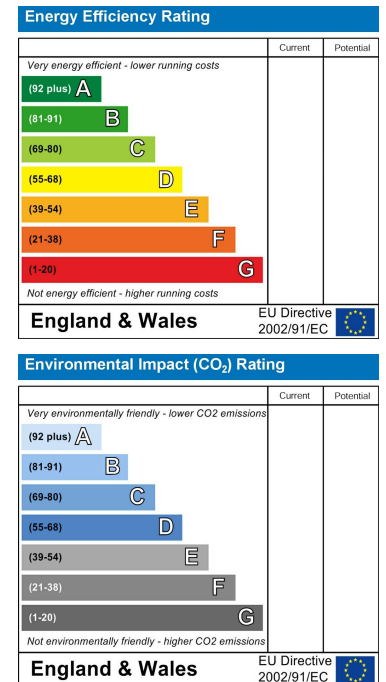

These particulars, whilst believed to be accurate are set out as a general outline only for guidance and do not constitute any part of an offer or contract. Intending purchasers should not rely on them as statements of representation of fact, but must satisfy themselves by inspection or otherwise as to their accuracy. No person in this firm's employment has the authority to make or give any representation or warranty in respect of the property.