



Barrell Makers House, Blair Street, Poplar, E14

Price **£625 per week** | Furnished



Barrell Makers House, Blair Street, Poplar, E14



2 Bedrooms



2 Bathrooms



1 Reception



Balcony



Gymnasium



Local Amenities



24-Hour Concierge



0.3 MI East India

Stunning 4th floor two bedroom, two bathroom apartment set within Barrellmakers Court, Aberfeldy Village E14. Comprising a bright open-plan living area with floor-to-ceiling windows opening up to a private balcony and a modern fitted kitchen with integrated appliances, spacious double bedrooms with fitted wardrobe space, and a contemporary bathroom suite.

Residents have access to several onsite facilities that include a dedicated 24-hour concierge service and a gymnasium. The development is located a short distance (8-min walk) from Canning Town

Underground and DLR stations providing a valuable transport link for commutes to London City Airport and other key destinations located within the capital. For example, Canary Wharf is commutable in just 3 mins from Canning Town station via Jubilee Line services.



Local Authority:

Tower Hamlets

Council Tax Band:

D

EPC:

B

Security deposit:

equivalent to 5 weeks' rent

Floorplan

772 sq ft | 70.14 sq m

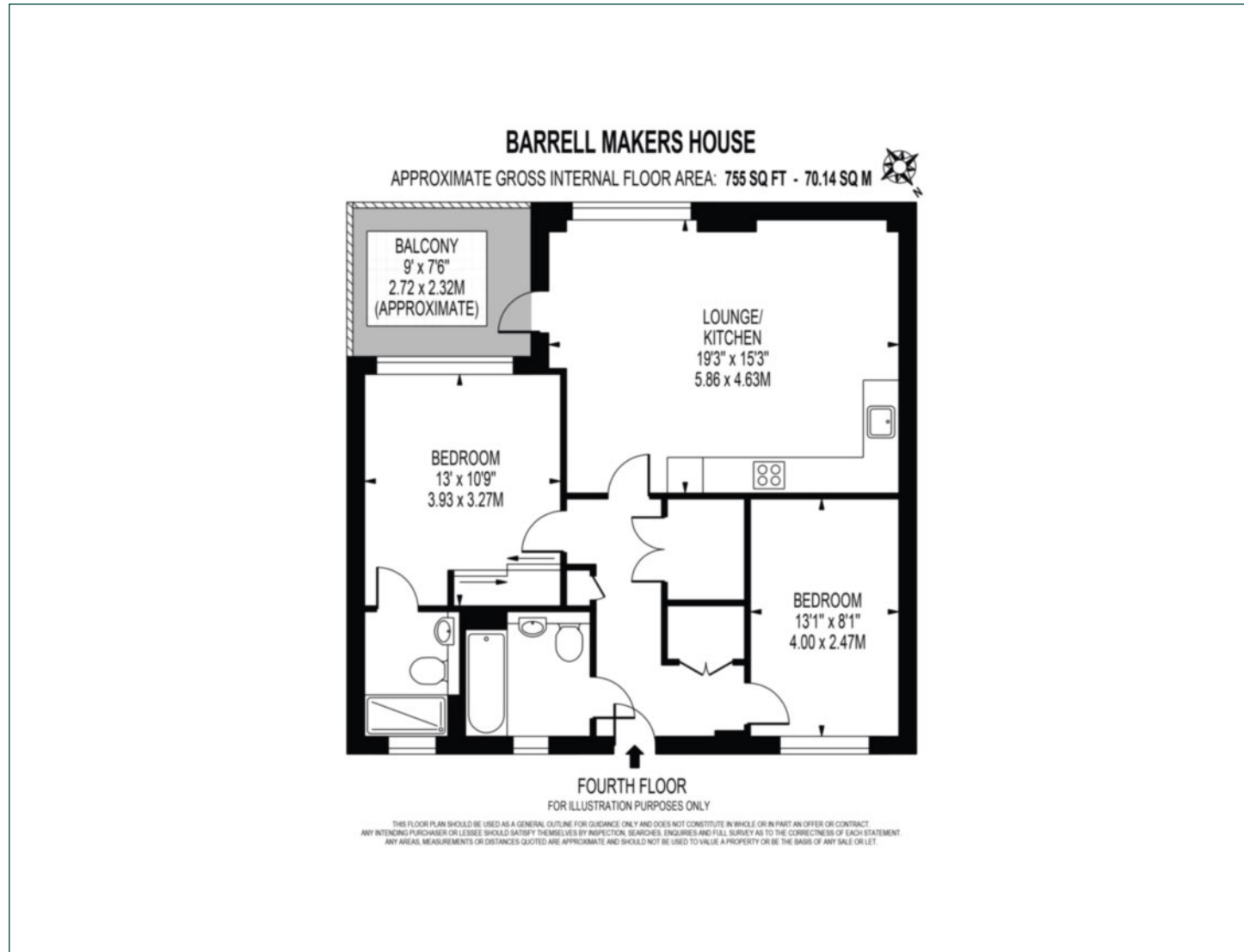

Canary Wharf

Horizon Building, 15 Hertsmere Road, London, E14 4AW

Lettings

020 7515 1000 | canarywharf.lettings@chaseevans.co.uk

We're here to help.

IMPORTANT NOTICE - These particulars have been prepared in good faith and they are not intended to constitute part of an offer or contract. We have not performed a structural survey on this property and the services, appliances and specific fittings have not been tested. All photographs, measurements, floor plans and distances referred to are given as a guide and should not be relied upon.

[chaseevans.com](https://www.chaseevans.com)