



**Ivy Point, No 1 The Avenue, Hannaford Walk,
Bow, E3**

Asking price **£380,000** | Leasehold



Ivy Point, No 1 The Avenue, Hannaford Walk, Bow, E3



Studio



1 Bathroom



1 Reception



Balcony



Gymnasium



Local Amenities



24-Hour Concierge



0.3 MI Devons Road

A studio apartment within No 1 The Avenue, located a short distance from the Olympic Park. This designer furnished studio apartment includes a fitted kitchen with integrated appliances, Amtico Spacia flooring, separate sleeping area, fitted wardrobe space, modern bathroom décor and a private balcony.

Residents also have access to a 24-hour concierge service, gymnasium, and a communal roof terrace offering views across London's skyline. The development is located a short distance away from both Devons Road DLR and Bromley-by-Bow

Underground stations, providing valuable transport links for commutes across the Capital.



Tenure: Leasehold (112 years remaining) **Local Authority:** Tower Hamlets

Ground Rent: £200 p.a. **Council Tax Band:** C

Service Charge: Circa £1,500 pa.a **EPC:** B

Floorplan

386 sq ft | 35.86 sq m

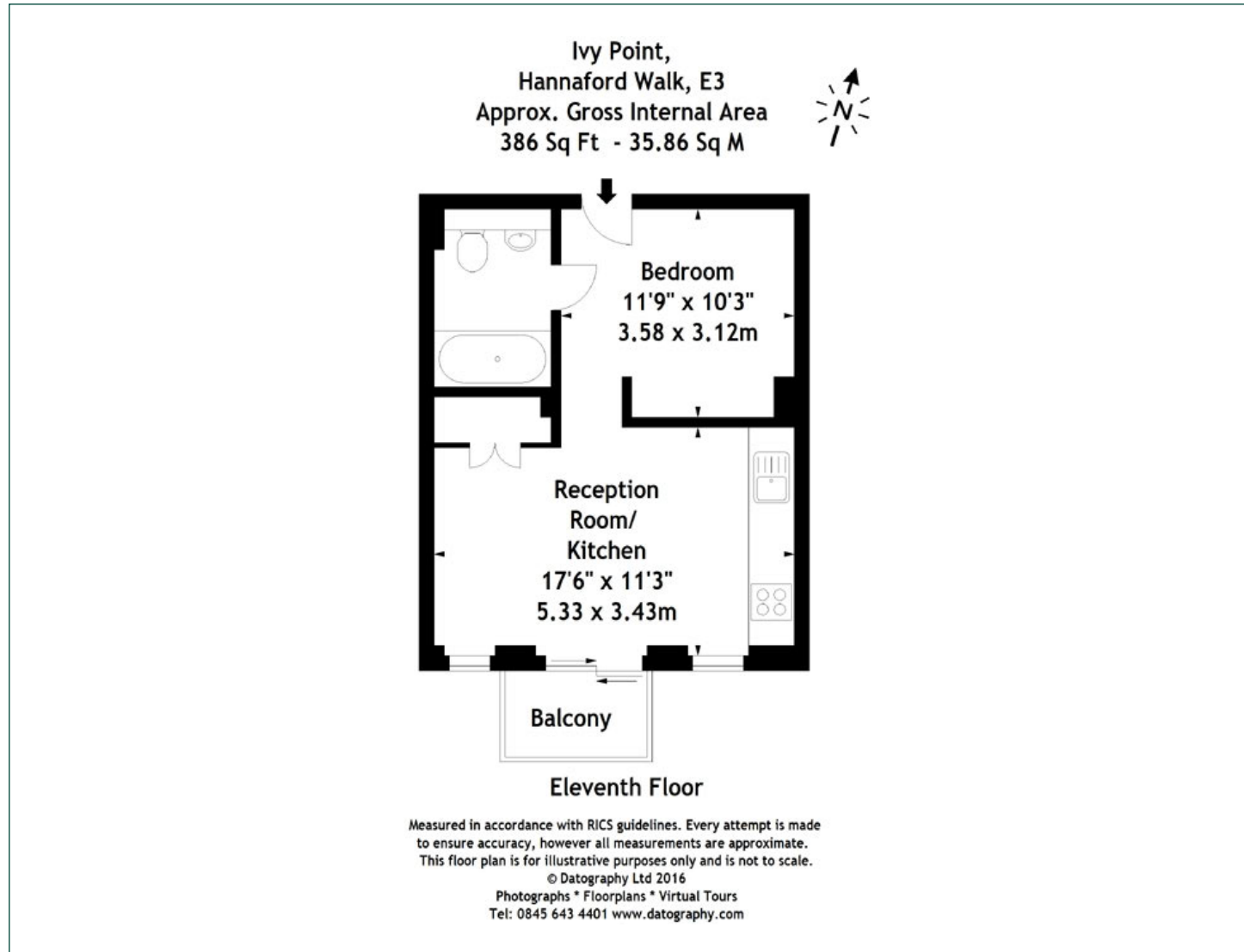

Canary Wharf

Horizon Building, 15 Hertsmere Road, London, E14 4AW

Sales

020 7515 1001 | canarywharf.sales@chaseevans.co.uk

We're here to help.

IMPORTANT NOTICE - These particulars have been prepared in good faith and they are not intended to constitute part of an offer or contract. We have not performed a structural survey on this property and the services, appliances and specific fittings have not been tested. All photographs, measurements, floor plans and distances referred to are given as a guide and should not be relied upon.

chaseevans.com