

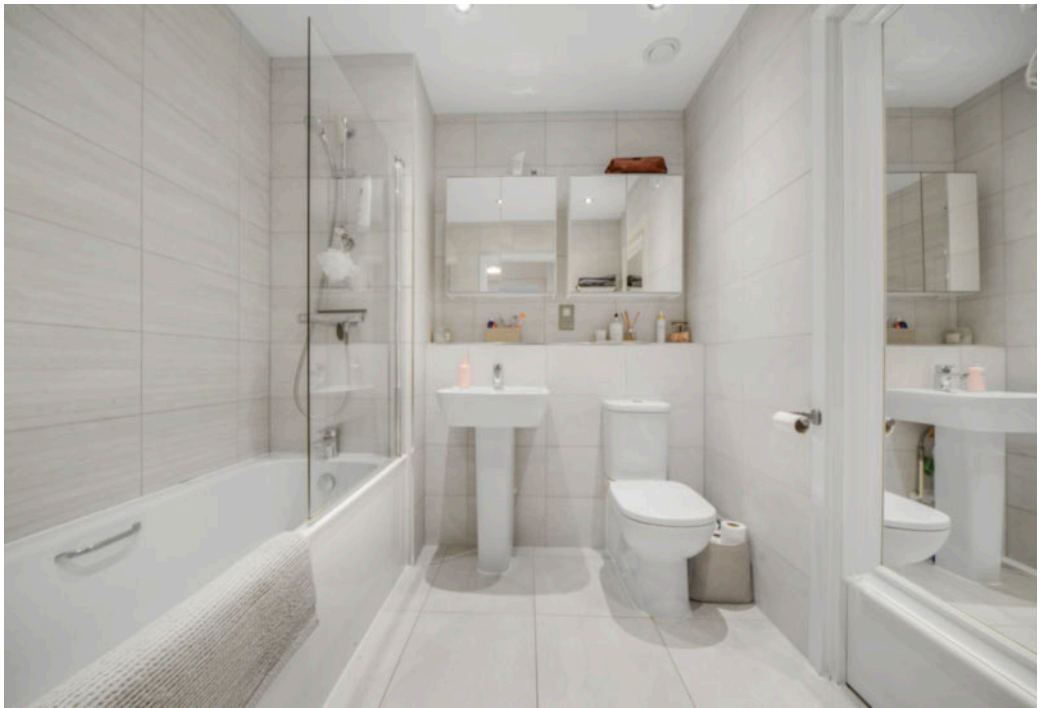











Harrold Court, Guthridge Close, Poplar, E14

Price **£485 per week** | Furnished



Harrold Court, Guthridge Close, Poplar, E14

-  1 Bedroom
-  1 Bathroom
-  1 Reception
-  Balcony
-  Cycle Storage
-  Secure Development
-  Local Amenities
-  Nearby Park
-  0.4 MI Langdon Park

Bright and airy one bedroom property with private balcony with Harrold Court, Poplar which was originally part of the Phoenix development by Fairview Homes with new build construction completing in 2018. Features include a large open-plan living / dining area which leads out to the private balcony offering views of the communal landscaped grounds of the development below and some skyline views of Canary Wharf in the distance. There is a stylish fitted kitchen with integrated appliances, ample cabinetry and storage, wood flooring, floor to ceiling glazing, a generous bedroom with bespoke fitted wardrobe and a modern tiled bathroom with smart fixtures and fittings.

Residents benefit from being within a secure gated development which also offers secure bicycle storage for

residents. The development is conveniently located near the Limehouse Cut canal, it is opposite to the open green space of Bartlett Park and is also nearby to local amenities including shops such as Lidl supermarket and Tesco Express for your grocery essentials. The nearby Crisp Street Market is currently undergoing a regeneration project which will be hugely beneficial to the local area once completed.

There is a bus stop located moments' walk from the development whilst Langdon Park DLR is 0.4 miles and Devons Road DLR is 0.6 miles away which offers direct access to Stratford and Canary Wharf whilst also offering connecting access to the City and other parts of the Capital.

Local Authority: Tower Hamlets

Council Tax Band: C

EPC: B

Security deposit: equivalent to 5 weeks' rent



Floorplan

559 sq ft | 51.9 sq m

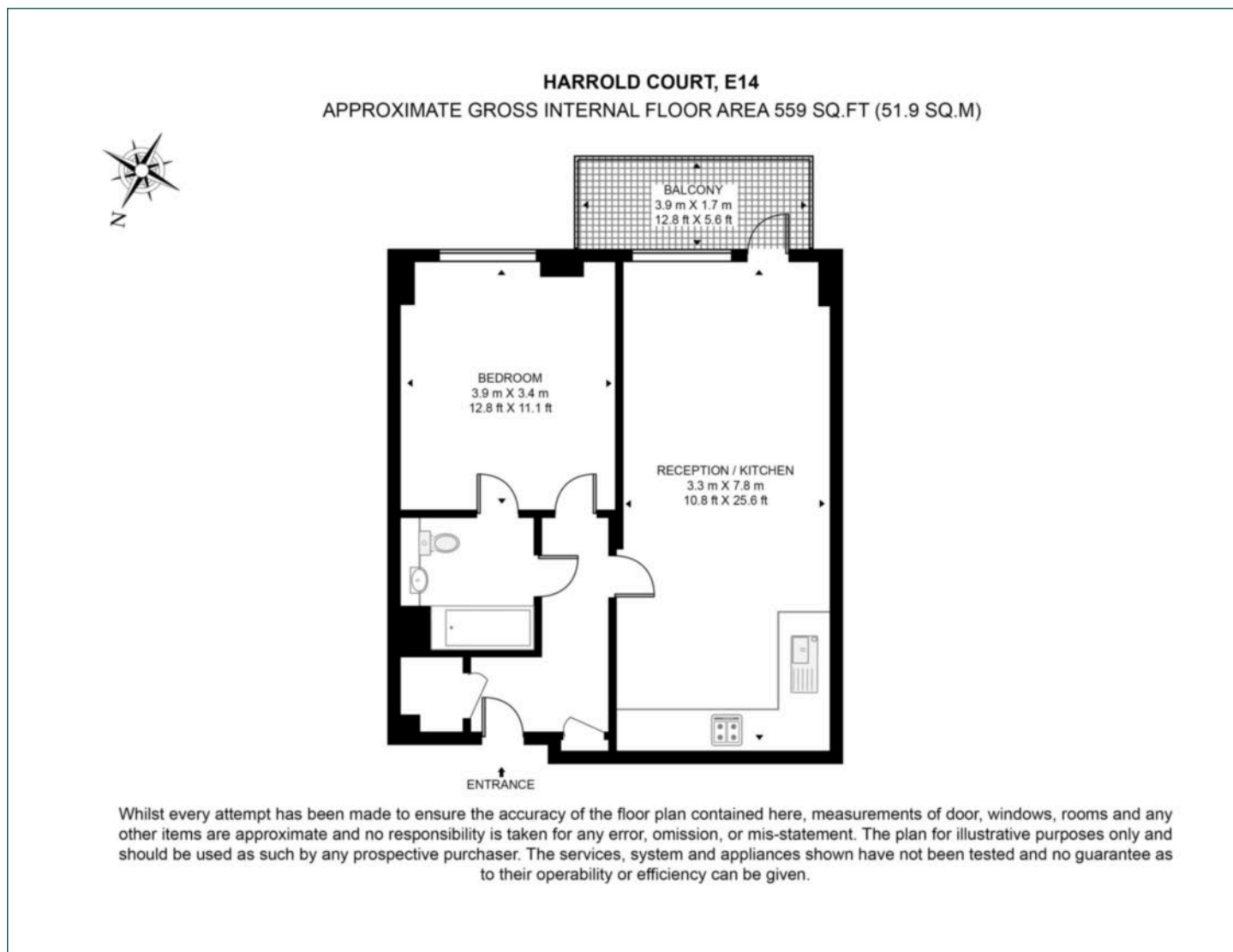

Canary Wharf

Horizon Building, 15 Hertsmere Road, London, E14 4AW

Lettings

020 7515 1000 | canarywharf.lettings@chaseevans.com

We're here to help.

IMPORTANT NOTICE - These particulars have been prepared in good faith and they are not intended to constitute part of an offer or contract. We have not performed a structural survey on this property and the services, appliances and specific fittings have not been tested. All photographs, measurements, floor plans and distances referred to are given as a guide and should not be relied upon.

chaseevans.com

 Chase Evans