



Cassia Point, Glasshouse Gardens, Stratford, E20

Price **£590 per week** | Furnished



Cassia Point, Glasshouse Gardens, Stratford, E20



1 Bedroom



1 Bathroom



1 Reception



Private Balcony



Gymnasium



Local Amenities



24-Hour Concierge



0.4MI Stratford

Modern one bedroom apartment within Cassia Point; part of the Glasshouse Gardens development in Stratford, E20, near Queen Elizabeth Olympic Park and several transport links. This designer-furnished apartment includes an inviting open-plan living space, fitted kitchen with integrated appliances, wood flooring, full-length windows, fitted bedroom storage, and a private balcony.

Residents will also have access to a 24-hour concierge service and on-site fitness facilities. The apartment is located 0.4 miles to Stratford station (served by Central Line, Jubilee Line, TfL,

DLR, and Elizabeth Line). Ideally, the Development is on the fringes of Queen Elizabeth Olympic Park, the London Stadium and is within walking distance from Westfield Stratford City, offering plenty of green open space and the convenience of a large indoor shopping complex with an array of restaurants, bars, shops, and entertainments.

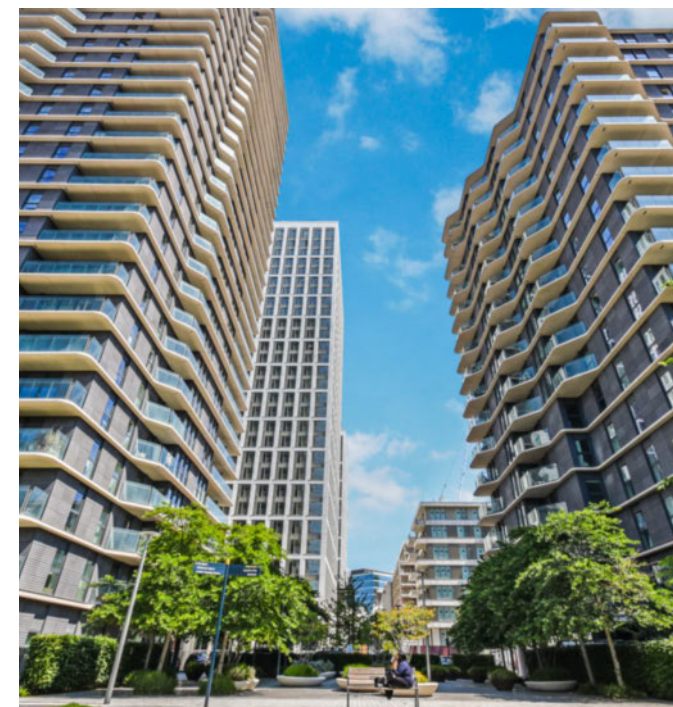

Local Authority: Newham

Council Tax Band: C

EPC: B

Security deposit: equivalent to 5 weeks' rent

Floorplan

551 sq ft | 51.2 sq m

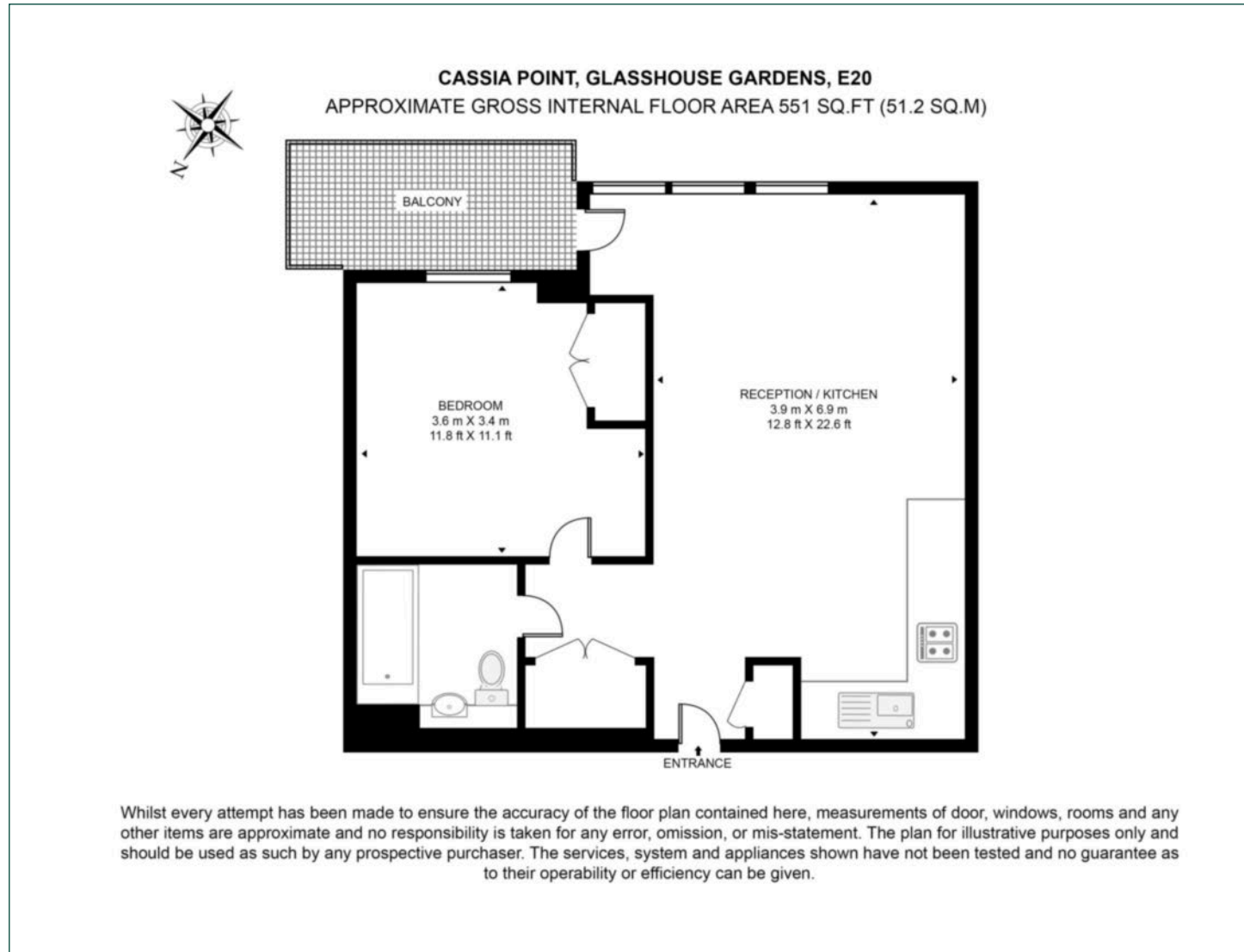

Canary Wharf

Horizon Building, 15 Hertsmere Road, London, E14 4AW

Lettings

020 7515 1000 | canarywharf.lettings@chaseevans.com

We're here to help.

IMPORTANT NOTICE - These particulars have been prepared in good faith and they are not intended to constitute part of an offer or contract. We have not performed a structural survey on this property and the services, appliances and specific fittings have not been tested. All photographs, measurements, floor plans and distances referred to are given as a guide and should not be relied upon.

chaseevans.com