



Marner Point, No 1 The Plaza, Jefferson Plaza, Bow, E3

Price **£450 per week** | Furnished



Marner Point, No 1 The Plaza, Jefferson Plaza, Bow, E3



1 Bedroom



1 Bathroom



1 Reception



Balcony



Gymnasium



Local Amenities



24-Hour Concierge



0.1 MI Bromley-by-Bow

A stunning one bedroom apartment set within No.1 The Plaza, a luxurious Barratt Homes development in Bow. The apartment benefits from a generous living/dining area with wood flooring and floor-to-ceiling glazing opening onto a private balcony, a fully integrated kitchen with appliances, a good sized bedroom with built in wardrobes, a modern bathroom suite.

Residents can benefit from a 24-hour concierge service, residents-only gymnasium and communal roof terraces. The development is located a short distance from Bromley-by-Bow Underground

station, providing a valuable transport link for commutes to key destinations across the capital.

Local Authority:

Tower Hamlets

Council Tax Band:

C

EPC:

B

Security deposit:

equivalent to 5 weeks' rent



Floorplan

492 sq ft | 45.71 sq m

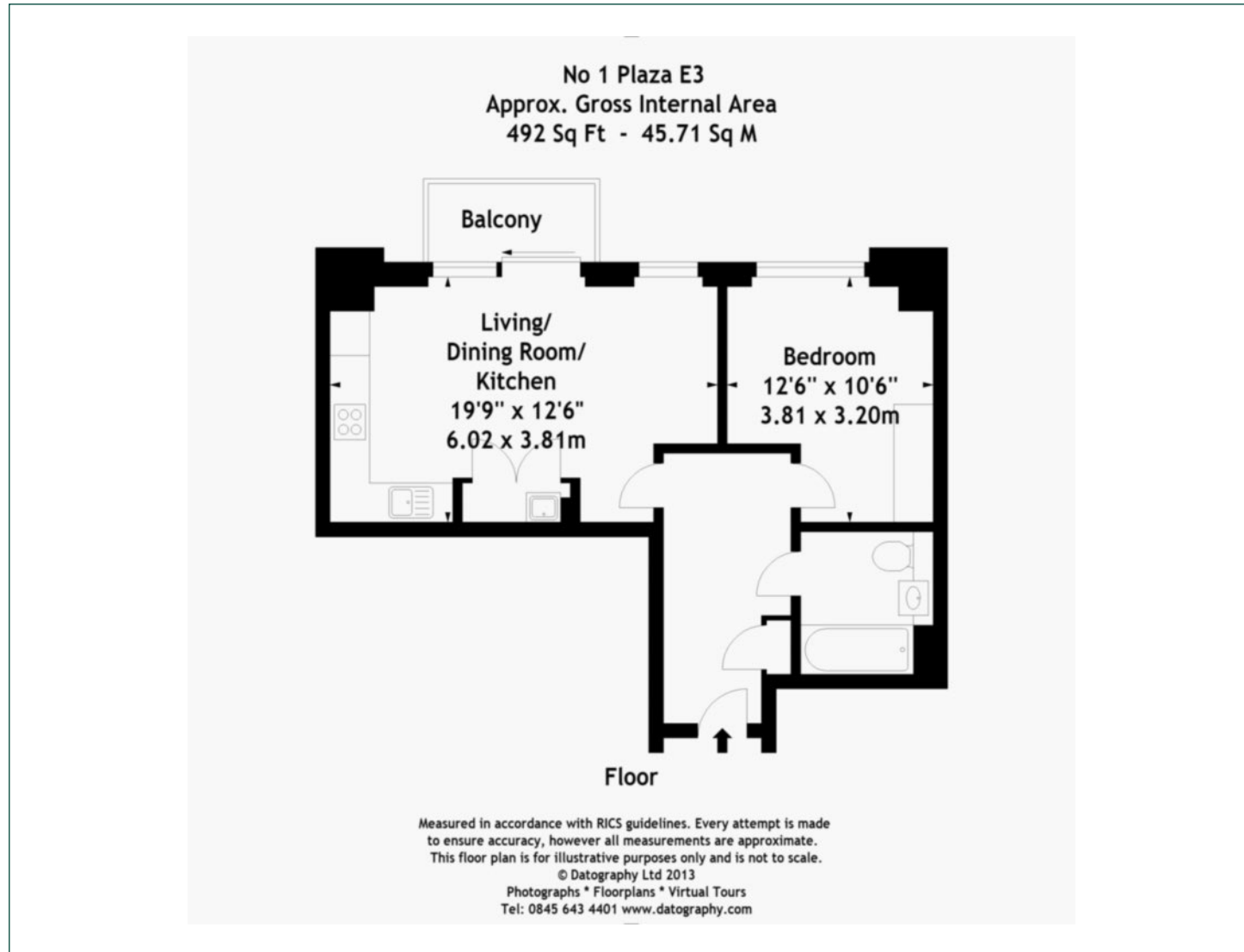

Canary Wharf

Horizon Building, 15 Hertsmere Road, London, E14 4AW

Lettings

020 7515 1000 | canarywharf.lettings@chaseevans.com

We're here to help.

IMPORTANT NOTICE - These particulars have been prepared in good faith and they are not intended to constitute part of an offer or contract. We have not performed a structural survey on this property and the services, appliances and specific fittings have not been tested. All photographs, measurements, floor plans and distances referred to are given as a guide and should not be relied upon.

chaseevans.com