

Cassia Point, Glasshouse Gardens, Stratford, E20

Asking price **£469,995** | Leasehold



Cassia Point, Glasshouse Gardens, Stratford, E20



1 Bedroom



1 Bathroom



1 Reception



Balcony



Gymnasium



Local Amenities



24-Hour Concierge



0.3 MI Stratford

A luxury one bedroom third floor property with a balcony in Cassia Point, Glasshouse Gardens, Stratford E20. Completed in 2017, the apartment is modern with an open plan kitchen/ living room, an ample size bedroom and a family bathroom.

Features include underfloor heating, engineered wood flooring throughout, large glazing to the living room, reflective kitchen cabinetry and fully integrated appliances, smart bathroom fittings, good storage space, and a decked balcony with partial views of the London Aquatic Centre.

Residents benefit from 24-hour concierge, on site fitness facilities and excellent transport links. There are several amenities located nearby including Westfield Stratford City and the Stratford Centre. The development is located near Stratford Station, providing Underground, DLR and rail services for commutes across the Capital.



Tenure: Leasehold (992 years remaining) **Local Authority:** Newham London

Ground Rent: £350 p.a. **Council Tax Band:** C

Service Charge: £2,649 p.a. **EPC:** B

Floorplan

538 sq ft | 50 sq m

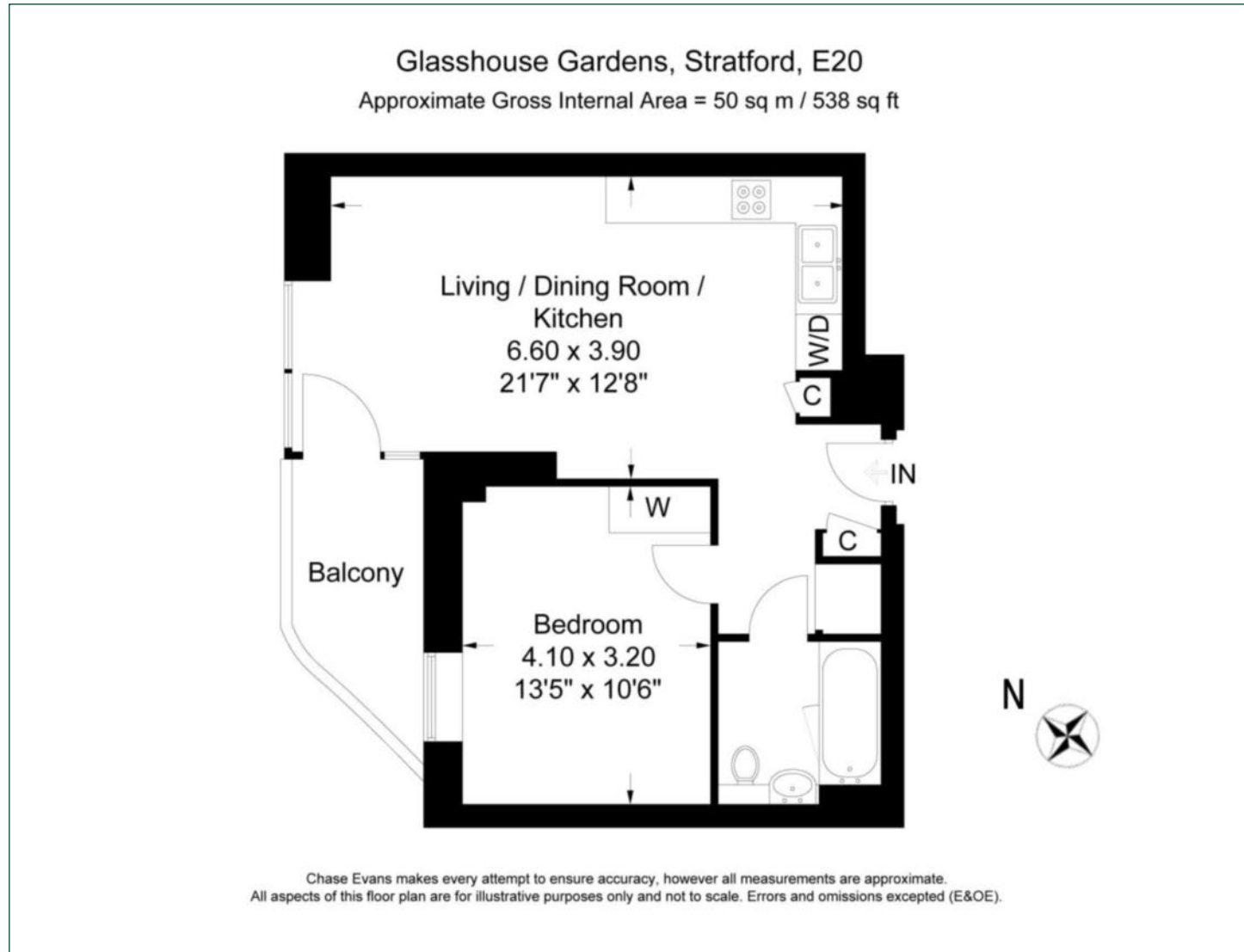

Canary Wharf

Horizon Building, 15 Hertsmere Road, London, E14 4AW

Sales

020 7515 1001 | canarywharf.sales@chaseevans.com

We're here to help.

IMPORTANT NOTICE - These particulars have been prepared in good faith and they are not intended to constitute part of an offer or contract. We have not performed a structural survey on this property and the services, appliances and specific fittings have not been tested. All photographs, measurements, floor plans and distances referred to are given as a guide and should not be relied upon.

chaseevans.com