



## St Michaels Court, St Leonards Road, Poplar, E14

Price **£360 per week** | Furnished



# St Michaels Court, St Leonards Road, Poplar, E14



1 Bedroom



1 Bathroom



1 Reception



Converted Church



Next to Langdon Park



0.1 MI Langdon Park DLR

A one bedroom apartment forms part of this fantastic church conversion set within St Michaels Court in Poplar E14. This furnished apartment includes a bright reception room, separate kitchen with appliances, wood flooring, good sized bedroom and a tiled bathroom suite. Ample storage throughout.

St Michaels Court is located near open spaces, local amenities such as Crisp Street Market, bus stations and Langdon Park DLR station, providing a key transport link for commutes towards Canary Wharf and the City. The former church and associated

buildings have now been converted to a private residence with a statue of the Parish War Memorial.



**Local Authority:**

Tower Hamlets

**Council Tax Band:**

C

**EPC:**

D

**Security deposit:**

equivalent to 5 weeks' rent

# Floorplan

532 sq ft | 49.4 sq m

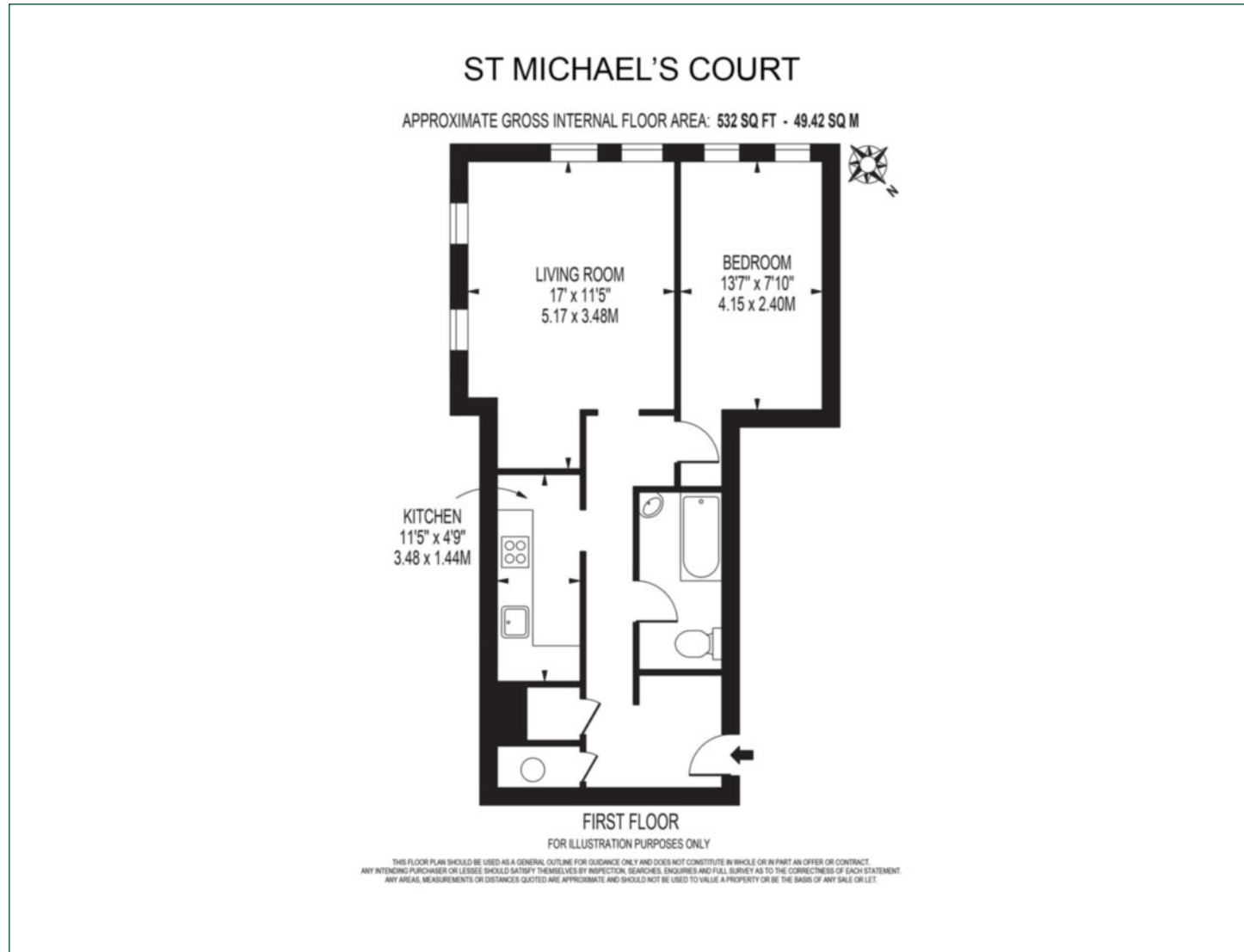

## Canary Wharf

Horizon Building, 15 Hertsmere Road, London, E14 4AW

## Lettings

020 7515 1000 | [canarywharf.lettings@chaseevans.com](mailto:canarywharf.lettings@chaseevans.com)

## We're here to help.

IMPORTANT NOTICE - These particulars have been prepared in good faith and they are not intended to constitute part of an offer or contract. We have not performed a structural survey on this property and the services, appliances and specific fittings have not been tested. All photographs, measurements, floor plans and distances referred to are given as a guide and should not be relied upon.

[chaseevans.com](https://www.chaseevans.com)