



Unex Tower, Stratford Plaza, Station Street, Stratford, E15

Asking price **£765,000** | Leasehold



Unex Tower, Stratford Plaza, Station Street, Stratford, E15



3 Bedrooms



2 Bathrooms



1 Reception



Winter Garden



Secure Cycle Storage



Local Amenities



24-Hour Concierge



0.1 MI Stratford

A fantastic three-bedroom, two-bathroom property set on the ninth floor of this iconic residential development in Stratford. This luxury apartment, boasting over 1,200 sq. ft. of living space, benefits from views across the City of London and the 2012 Olympic Park, a spacious open plan living room, fully integrated kitchen, en suite and family bathrooms, under floor heating, and a spacious winter garden.

Residents benefit from 24-hour concierge, access to communal roof terrace and a wealth of local amenities. Unex Tower offers residents the height

of luxury living in this trendy and arguably best connected location in London. It is situated only second away from Stratford station, served by numerous lines, including Central, Jubilee, DLR, Elizabeth, and Overground, along with Train services, which offer easy commutes to key destinations across the Capital.

Tenure: Leasehold (238 years remaining) **Local Authority:** Newham London

Ground Rent: £420 **Council Tax Band:** E

Service Charge: £4,400 p.a. **EPC:** B

Floorplan

1,210 sq ft | 112 sq m

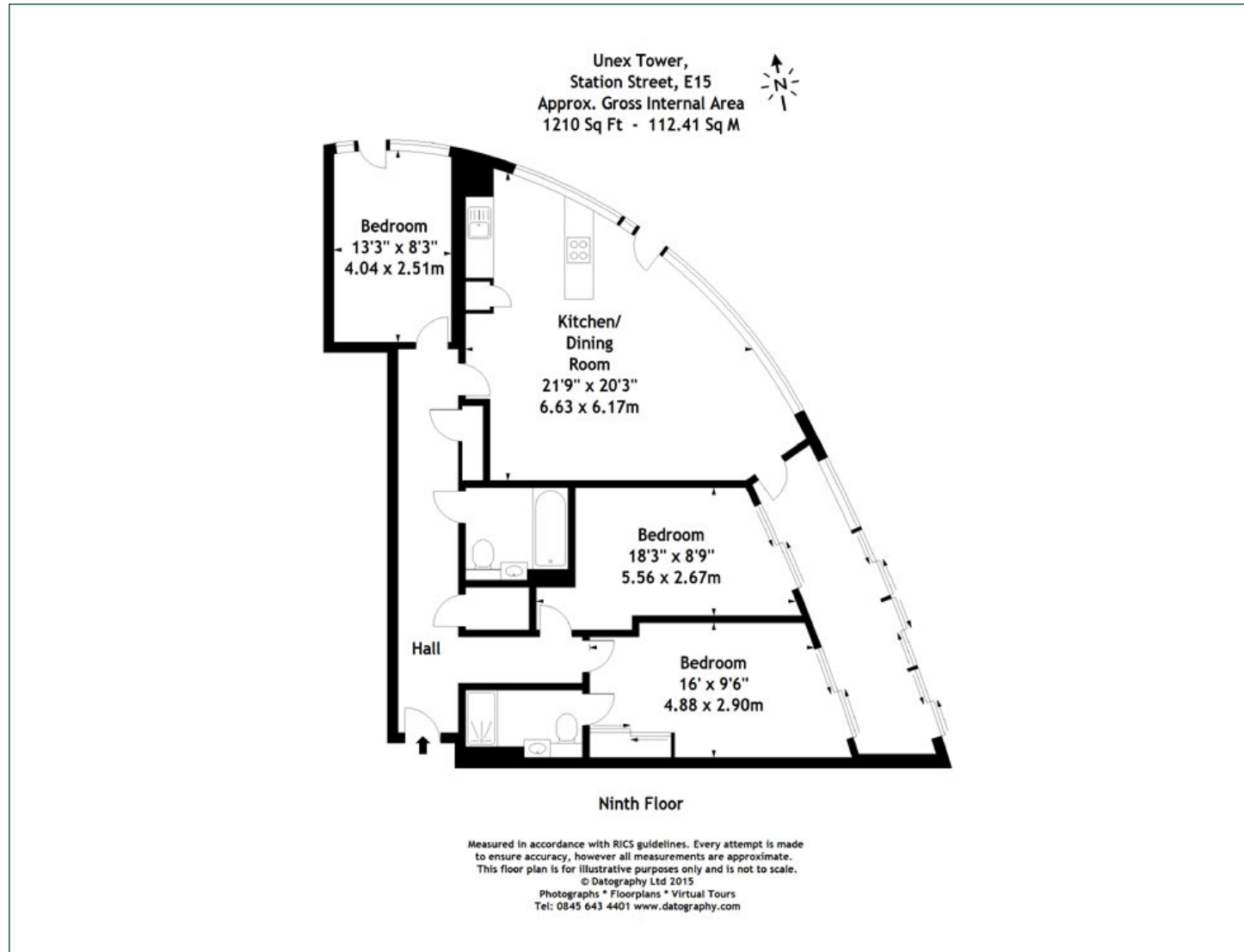

Canary Wharf

Horizon Building, 15 Hertsmere Road, London, E14 4AW

Sales

020 7515 1000 | canarywharf.sales@chaseevans.co.uk

We're here to help.

IMPORTANT NOTICE - These particulars have been prepared in good faith and they are not intended to constitute part of an offer or contract. We have not performed a structural survey on this property and the services, appliances and specific fittings have not been tested. All photographs, measurements, floor plans and distances referred to are given as a guide and should not be relied upon.

chaseevans.com

 Chase Evans