

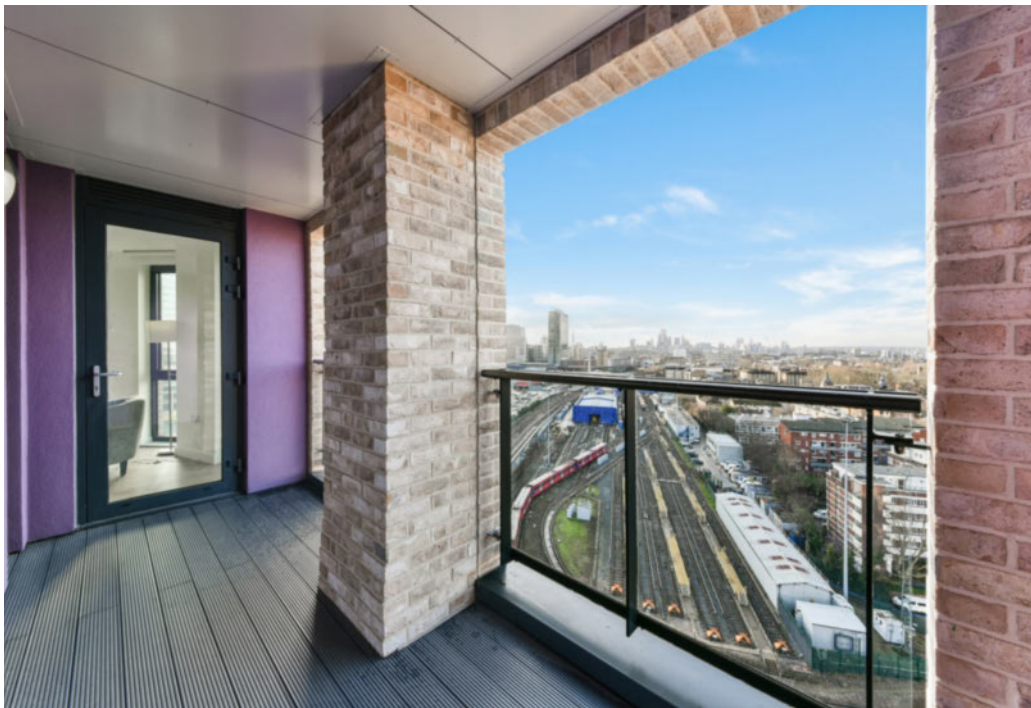

Roosevelt Tower, Manhattan Plaza, Williamsburg Plaza, Canary Wharf, E14

Price **£625 per week** | Furnished



Roosevelt Tower, Manhattan Plaza, Williamsburg Plaza, Canary Wharf, E14



2 Bedrooms



2 Bathrooms



1 Reception



Balcony



Gymnasium



Local Amenities



24-Hour Concierge



0.4 MI Blackwall

A modern two bedroom, two bathroom apartment. Located within this luxurious development, Manhattan Plaza. The property boasts of living space, with a private balcony. This bright apartment includes an inviting living and dining area, fitted kitchen with integrated appliances, wood flooring, two spacious bedrooms, master with en-suite, stylish bathroom suite and a private balcony.

Residents will also benefit from video entry phone system, concierge service, private residents' gymnasium and access to two landscaped roof-top gardens. A number of local amenities that are near

the development that include shops and restaurants.

The development is located a short distance from Blackwall DLR station providing a valuable transport link for commutes to London City Airport and other destinations located within the Capital.

Local Authority:

Tower Hamlets

Council Tax Band:

E

EPC:

B

Security deposit:

Equivalent to 5 weeks deposit

Floorplan

771 sq ft | 71.6 sq m

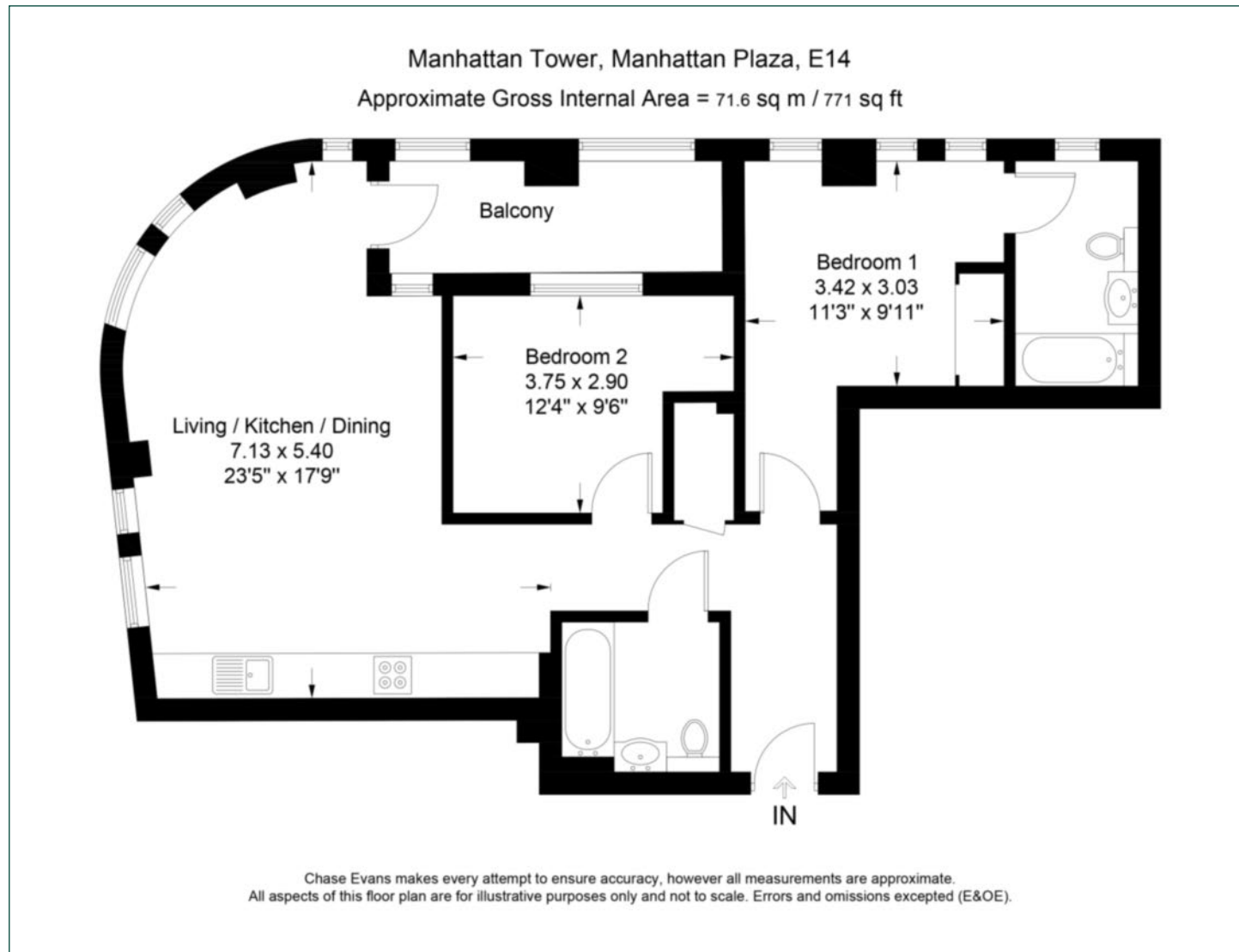

Lettings

We're here to help.

IMPORTANT NOTICE - These particulars have been prepared in good faith and they are not intended to constitute part of an offer or contract. We have not performed a structural survey on this property and the services, appliances and specific fittings have not been tested. All photographs, measurements, floor plans and distances referred to are given as a guide and should not be relied upon.

chaseevans.com