



Sail Loft Court, Royal Quay, Clyde Square, Poplar, E14

OIEO **£350,000** | Leasehold



Sail Loft Court, Royal Quay, Clyde Square, Poplar, E14



Studio



1 Bathroom



1 Reception



Local Amenities



Nearby Parks



Concierge Service



0.3 MI Westferry

Stunning studio apartment set within Sail Loft Court, forming part of the impressive Clyde Square development, Poplar E14. Comprising a bright and spacious living area with south-east facing windows and a modern fitted kitchen suite with integrated appliances, spotlighting in ceiling. An inviting partitioned sleeping area with fitted storage space and a contemporary bathroom suite with smart shower.

Residents will also have access to an on-site concierge service. There are several amenities located nearby including restaurants and shops.

Bartlett Park is within walking distance, providing an ideal place to relax or take part in leisure activities. The development is located close to several DLR services for commutes towards Canary Wharf and the City. West ferry DLR is just under a mile away and Limehouse national rail station is just under three quarters of a mile away for additional c2c services.

Tenure: Leasehold (999 years)

Local Authority: Tower Hamlets

Ground Rent: £400 p.a.

Council Tax Band: C

Service Charge: £3,237.50 p.a.

EPC: C

Floorplan

400 sq ft | 37.2 sq m

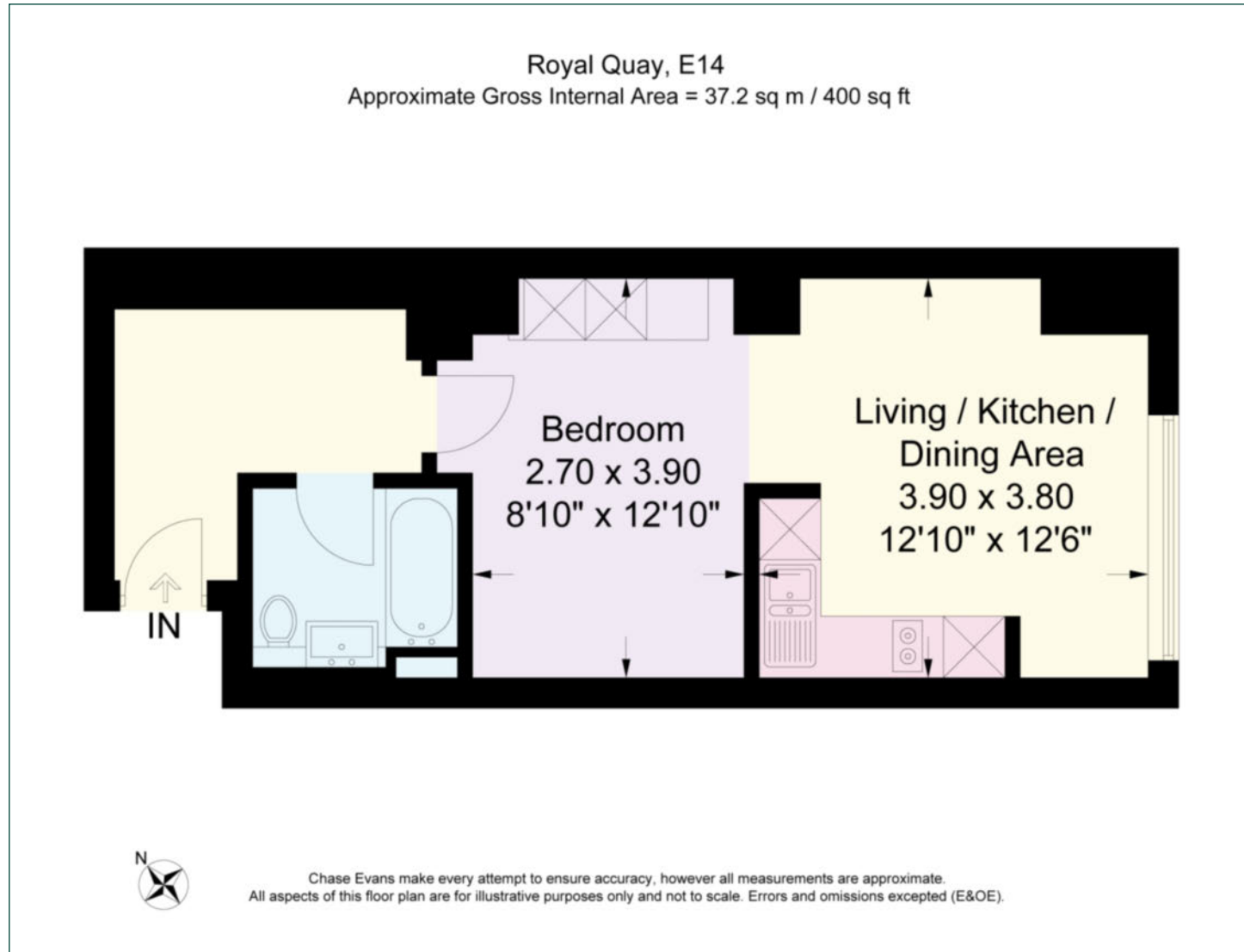

Sales

We're here to help.

IMPORTANT NOTICE - These particulars have been prepared in good faith and they are not intended to constitute part of an offer or contract. We have not performed a structural survey on this property and the services, appliances and specific fittings have not been tested. All photographs, measurements, floor plans and distances referred to are given as a guide and should not be relied upon.

chaseevans.com

 Chase Evans