



Woodlands, Brookmans Park, Hatfield
Hatfield

Offers Over
£950,000

Bedrooms: 4

Bathrooms: 2

Receptions: 2

A bright and spacious FOUR BEDROOM, TWO BATHROOM, TWO RECEPTION ROOM DETACHED FAMILY HOME situated within a sought residential close in the heart of Brookmans Park, conveniently located for all local shopping and transport facilities and in a great catchment area for all local schools. The property is being offered in good decorative order and benefits from: Double Glazed Windows, Gas Fired Heating To Radiators, Guest Cloakroom, Spacious Entrance Hall, Living Room, Dining Room, Fully Fitted Kitchen/Breakfast Room, Bedroom One With En Suite Bathroom, Three Further Bedrooms, Family Bathroom, Secluded Rear Garden, Double Garage Approached Via Own Driveway With Off Street Parking.

This is a freehold property.

Council Tax Band G £3,889 per annum.

As always buyers are advised to gain verification from their surveyor/solicitor during the conveyancing process.

Disclaimer:

While every care and effort has been made to ensure these details are correct their accuracy cannot be guaranteed and so should not form part of any contract.









Woodlands, Brookmans Park, Hatfield, AL9

Approximate Area = 1455 sq ft / 135.1 sq m

Garage = 276 sq ft / 25.6 sq m

Total = 1731 sq ft / 160.7 sq m

For identification only - Not to scale

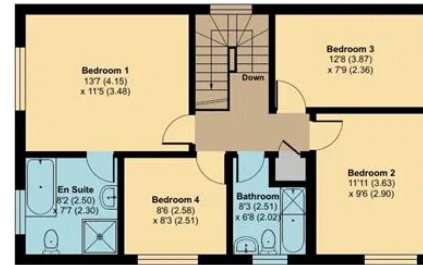

FIRST FLOOR



GROUND FLOOR

Floor plan produced in accordance with RICS Property Measurement 2nd Edition, incorporating International Property Measurement Standards (IPMS2 Residential). © nichecom 2025. Produced for Benjamin Stevens. REF: 1294269

Scott Bernstein

59 High Road, Bushey Heath, Herts WD23 1EE

0208 950 7777

steve@benjaminstevens.co.uk

<https://benjaminstevens.co.uk>