



Lesbourne Road, Reigate

Guide Price £400,000

🛏 2 🍳 2 🛋 1



- Underground Parking
- Walk to Town and Station
- Ground Floor
- Communal Gardens
- Service Charge £1,100
- Ground rent £90
- 992 Year Lease



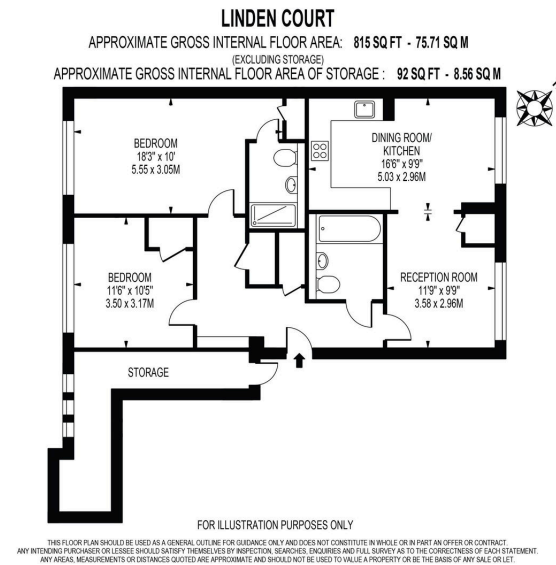

A delightful two double bedroom two bathroom ground floor apartment in excellent condition throughout. Offering in excess of 800 sq ft this beautiful apartment is well presented throughout and offers quick and easy access into Reigate town centre and station. The property also further benefits from an extra storage room which is incredibly useful.

Outside there are beautifully landscaped communal grounds, cycle storage, one designated parking space in the secure basement car park and with visitors' spaces available in the rear car park. There is lift access from the basement to the ground floor.

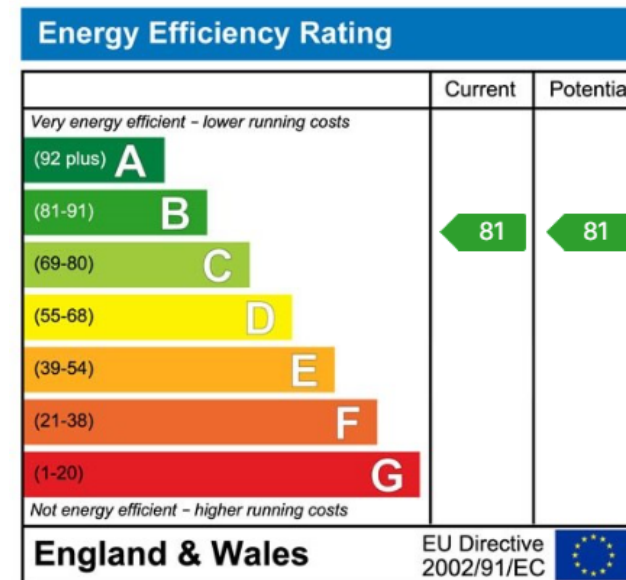

DISCLAIMER. PROPERTY MISDESCRIPTIONS. Whilst every attempt has been made to ensure accuracy of the property details, no responsibility is taken for error, omission or mis-statement. The Agent has not yet tested any apparatus, equipment, fixtures and fittings or services and so cannot verify that they are in working order or fit for the purpose. A buyer is advised to obtain verification from their Solicitor or Surveyor. References to the Tenure of a property are based on information supplied by the Seller. The agent has not had sight of the title documents.