

Langton Court Road

ST ANNE'S PARK

APPROXIMATE FLOOR AREA
97.3 SQM / 1047 SQFT



GROUND FLOOR
526 sq.ft. (48.9 sq.m.) approx.



1ST FLOOR
521 sq.ft. (48.4 sq.m.) approx.

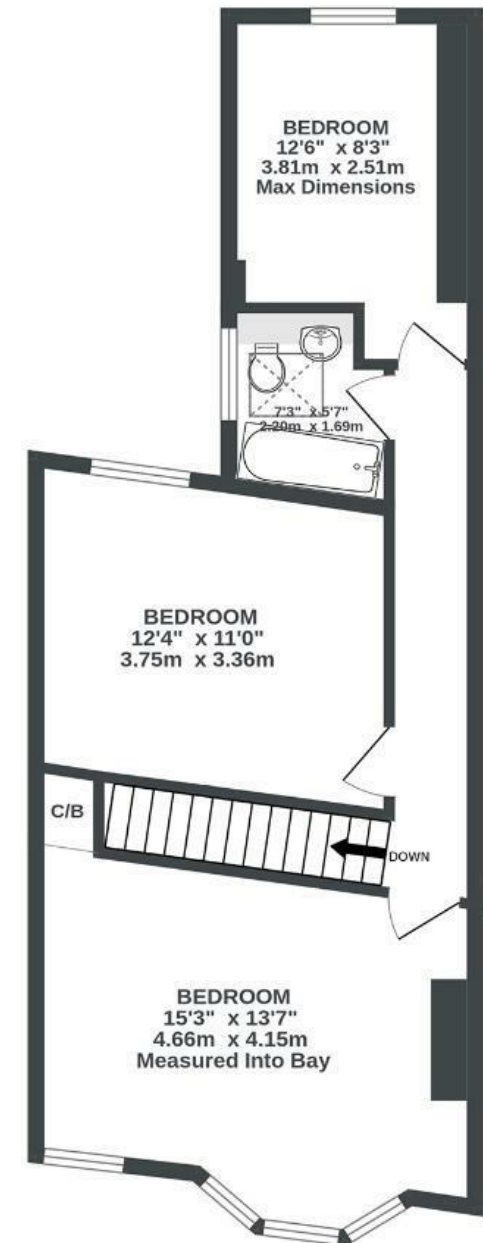

Illustrations are for reference purposes only, measurements are approximate, not to scale.

Boardwalk

Langton Court

, BRISTOL

£

£425,000



BS4 4EG

zzz

3 Bedrooms



1 Bathrooms

"Living on Langton Court Road has been a joy—woodland walks, Sunday roasts at The Langton, and unbeatable local spots for a Friday catch-up. Tarr's Ice Cream was our family weakness, and river bike rides or city coffee days became our go-to weekends."

