

Old Pump House Close

BEDMINSTER DOWN

APPROXIMATE FLOOR AREA
110.2 SQM / 1186 SQFT

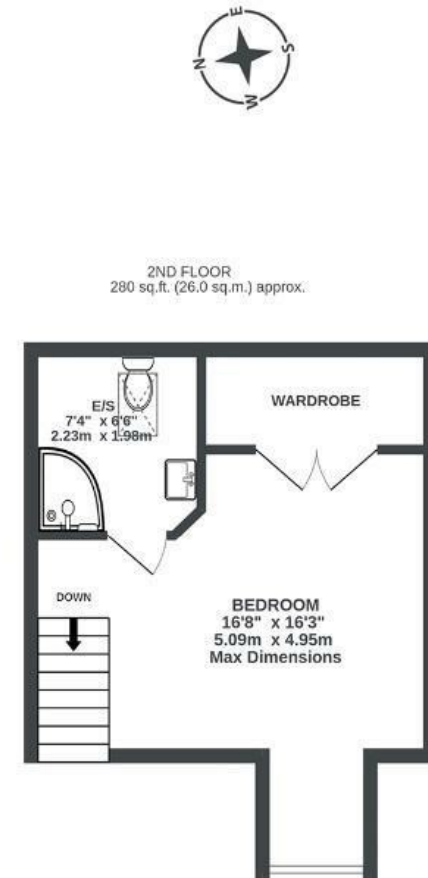
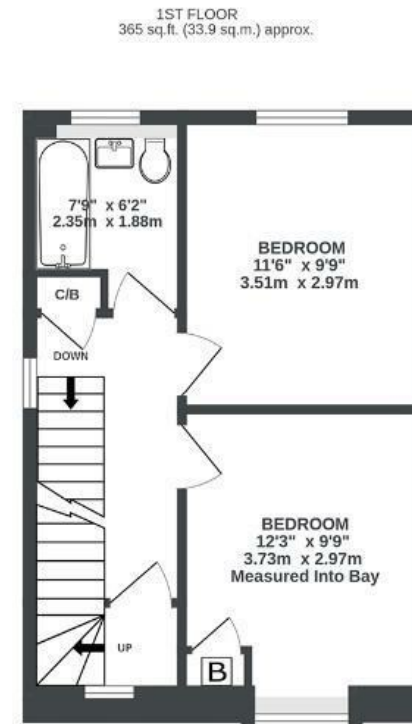
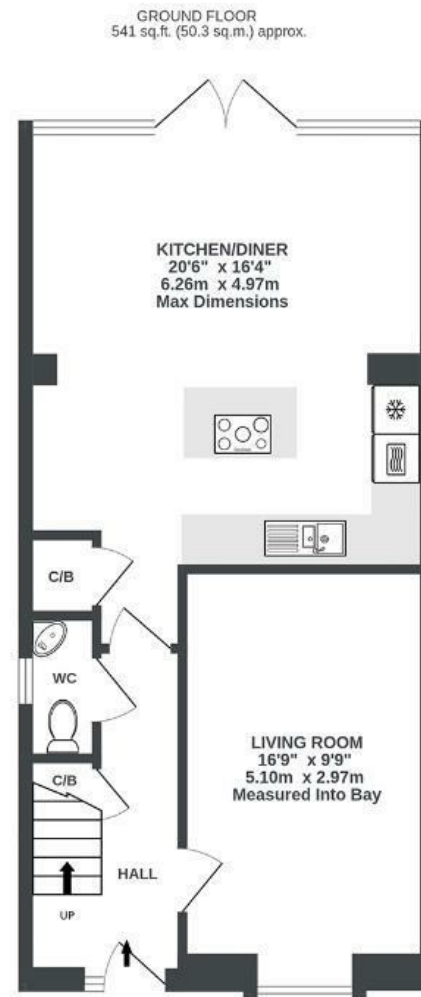

Illustrations are for reference purposes only, measurements are approximate, not to scale.

Boardwalk

Old Pump House

, BRISTOL



£450,000



BS13 7DL



3 Bedrooms



2 Bathrooms

"We've loved how this home combines light, open spaces with real warmth and comfort. The kitchen and living area feel bright and social, which was perfect when we hosted Christmas for both our families last year. While the snug at the front is perfect for those quiet, cosy evenings. The master bedroom is our favourite part, with its own staircase, en-suite and built in wardrobe, almost like a hotel suite within the house."

