

Park Road

SHIREHAMPTON

APPROXIMATE FLOOR AREA
85.4 SQM / 919 SQFT



GROUND FLOOR
482 sq.ft. (44.8 sq.m.) approx.

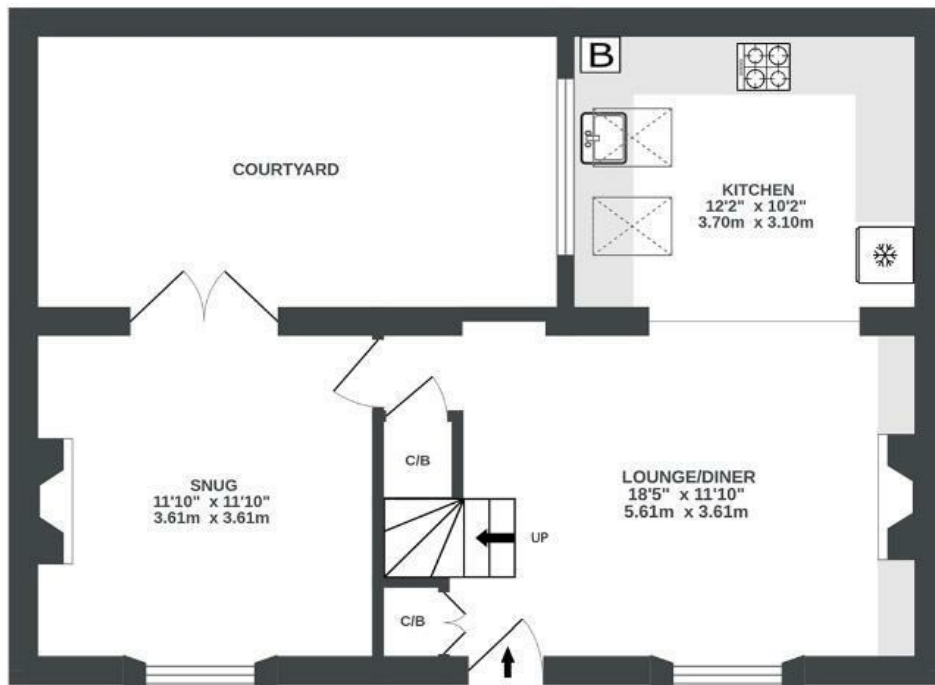

1ST FLOOR
437 sq.ft. (40.6 sq.m.) approx.

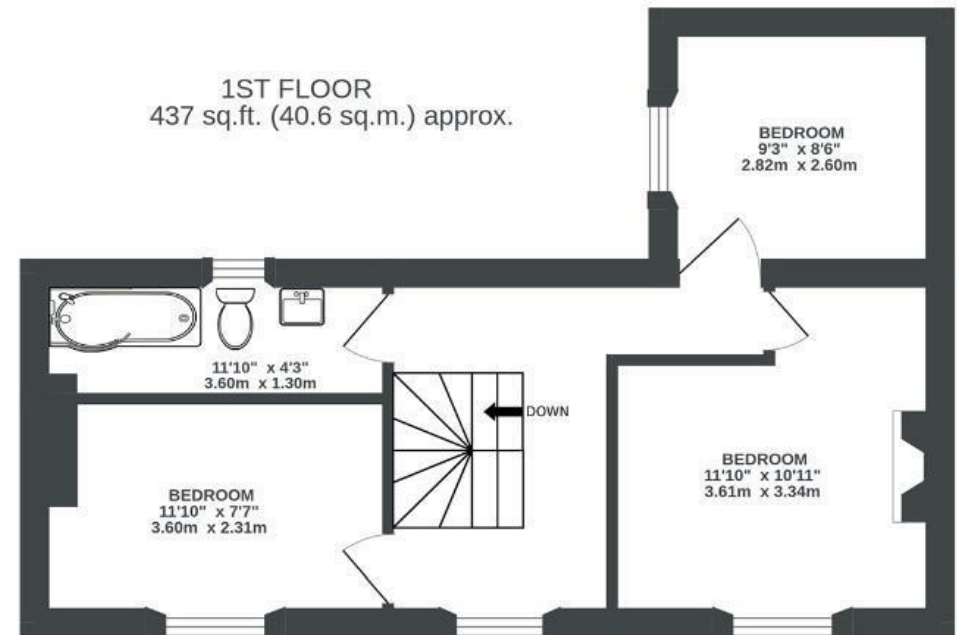

Illustrations are for reference purposes only, measurements are approximate, not to scale.

Boardwalk

Park Road

SHIREHAMPTON, BRISTOL

£

£415,000



BS11 0EF

zzz

3 Bedrooms



1 Bathrooms

"I have lived on Park Road for 9 years and have been very happy here, thanks to the friendly community. The house is an 1840s property, originally thought to have belonged to sea captains docking on the nearby river. More recently it's been lovingly and tastefully changed into the home you see today."

