

**Boardwalk**

# Green Street

, BRISTOL

## Green Street TOTTERDOWN

APPROXIMATE FLOOR AREA  
55.0 SQM / 592 SQFT



GROUND FLOOR

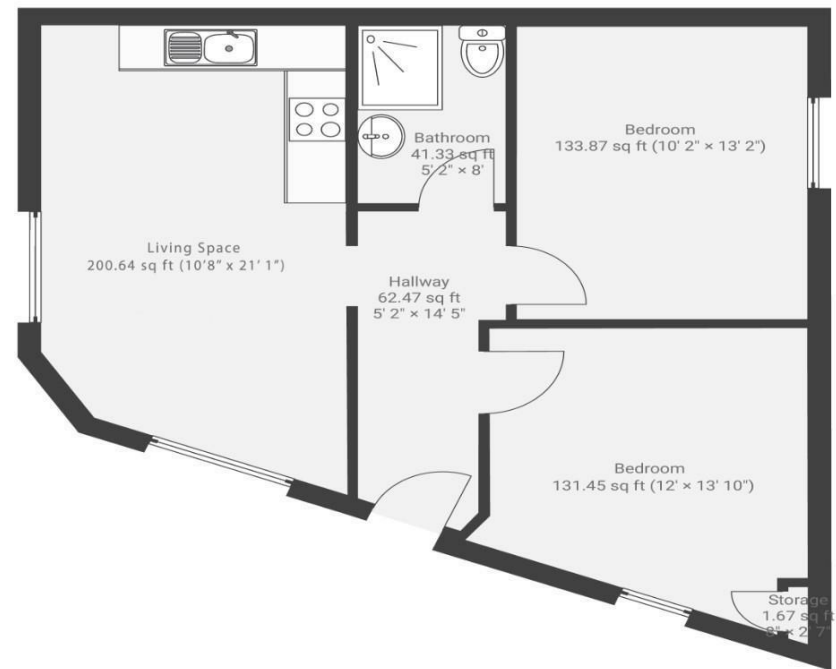

Illustrations are for reference purposes only, measurements are approximate, not to scale.

**Boardwalk**

# Green Street , BRISTOL



£275,000



BS3 4UA



2 Bedrooms



1 Bathrooms

*"We have loved living in the heart of Totterdown surrounded by many great pubs, eateries and being just a short walk into town. We were drawn to the area because of its vibrant colours and lively, friendly atmosphere. We will be sad to leave our flat as we are very fond of the huge amount of natural light that comes through the big south facing kitchen windows."*

